



ACT Heritage Council

Entry to the ACT Heritage Register

Heritage Act 2004

20035. Uniting Church

Section 25 Block 1

REID

This document has been prepared by the ACT Heritage Council.

This entry which was previously part of the old heritage places or the old heritage objects registers (as defined in the *Heritage Act 2004*), as the case may be, is taken to be registered under the *Heritage Act 2004*.

Conservation Requirements (including Specific Requirements), as defined under the *Heritage Act 2004*, that are contained within this document are taken to be Heritage Guidelines applying to this place or object, as the case may be.

Information restricted under *the old heritage places register or old heritage objects register* is restricted under the *Heritage Act 2004*.

Contact: ACT Heritage Council c/o Secretary PO Box 144
Enquiries: phone 02 6207 2164 fax 02 6207 5715

Lyneham ACT 2602
e-mail heritage@act.gov.au



ACT Government



environment ACT

Helpline: 02 6207 9777
Website : www.cmd.act.gov.au
E-mail: EnvironmentACT@act.gov.au

35. Uniting Church, Reid [V66]¹

Location

District of Canberra Central, Division of Reid, Section 25 Block 1 as identified in Figure 35a and indicated on the Territory Plan Map by the Heritage Places Register Overlay at H35.

Features Intrinsic To The Heritage Significance Of The Place:

The place comprises:

- a) church building including ministers study and choir vestry;
- b) associated buildings including the Sunday school hall, youth memorial hall and Dorothy Johns room; and
- c) original identified trees.

Statement Of Significance:

The Uniting Church in Reid has a strong association with the formative social development and early life of Canberra. It was Canberra's first church built specifically to service the needs of an urban congregation. It has been a focus for the religious and social life of the Uniting Church community of the Canberra urban area.

The church is valued by the local Methodist congregation and is seen by others as a feature of the Reid landscape. The remaining original plantings contribute significantly to the landscape value of the place and help to unify the church and associated building complex by providing a leafy backdrop within the suburb of Reid. It is an important townscape element in the Reid Housing Precinct.

The church is associated with the architect, J.C.R. Mills, who was a prolific designer of churches in New South Wales and an eminent architect of his time. Important features of his work in this church are the Norman tower and Gothic arches.

Specific Requirements:

In accordance with s.54(1) of the *Land (Planning and Environment) Act* the following requirements are identified as essential to the conservation of the heritage significance of the place. These requirements are prepared to implement the following conservation policy for the place:

The significant built and landscape elements on the site are to be retained and conserved as a place of cultural significance.

i) Building including alteration and addition

- a) The church building is to remain the dominant feature of the place in any future development.
- b) Alterations and additions to the existing church or related church buildings identified in Figure 35b shall reflect and complement the architectural style of the original buildings. This includes alterations to external finishes.
- c) The roof pitch, wall materials, window types and materials of any alterations or additions shall be as similar to the existing buildings as is feasible.

ii) Demolition

- a) The church and parish centre shall not be demolished, other than in exceptional circumstances, including circumstances in which the buildings and structures are structurally unsound and beyond economic repair, or where there are significant health and safety reasons to warrant demolition. All prudent and feasible alternatives to demolition shall be considered before demolition is permitted.
- b) The partial demolition of any building or structure on the place shall only be permitted in the context of sympathetic alterations and additions.

iii) Landscape

- a) The original trees on the place identified in figure 35b are to be retained and conserved. Removal shall only be permitted where it can be demonstrated that the plants will not survive and are beyond economic costs to retain.

¹ [V66: Added to Heritage Places Register 30/10/1998 (Variation Number 66)]

Figure 35a: Uniting Church, Reid: Location

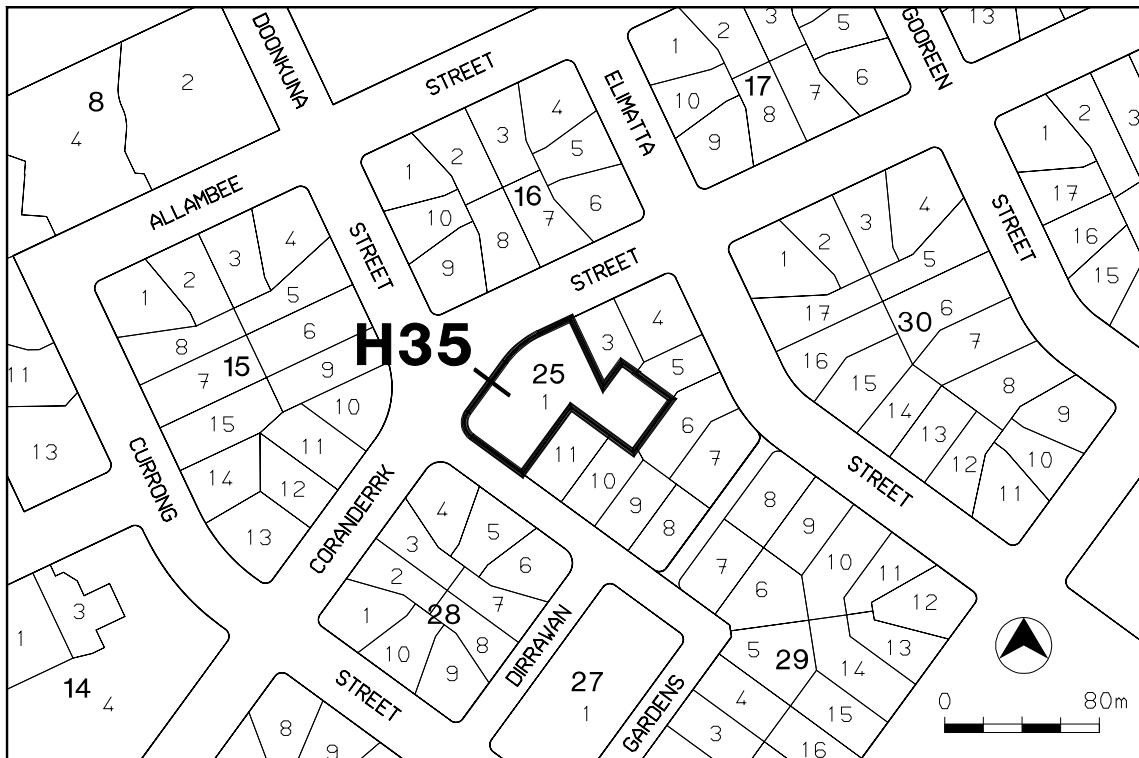

Figure 35b: Uniting Church, Reid: Significant Elements

