

## NOMINATION TO THE ACT HERITAGE REGISTER

*Please note that the information below represents the indicative heritage values supplied by the nominator and are not the views of the ACT Heritage Council (the Council).*

*This nomination is yet to be assessed by the Council against the heritage significance criteria established under the Heritage Act 2004.*

*Acceptance of a nomination is a preliminary, threshold step and ought not to be taken as indicative of any particular outcome concerning the Council's assessment of the nomination.*

### **YARRALUMLA SHORES 28 BLACK STREET BLOCK 1, SECTION 100, YARRALUMLA**

The nomination was given to the Council on 9 September 2023 and accepted at Heritage Council meeting 122 on 5 December 2023.

Designed by Ken Wooley in 1981 and built by B&B Constructions in 1983, Yarralumla Shores consists of 26 townhouses in three groups sited within landscaped gardens. Each house is based on a simple L-shaped, two-storey design with extensions to suit site conditions. The aim was to create a degree of individuality and separate building profiles by alternating the size and form of the townhouses. Variety is favoured over continuity but with a deliberate consistency in architectural form and expression.

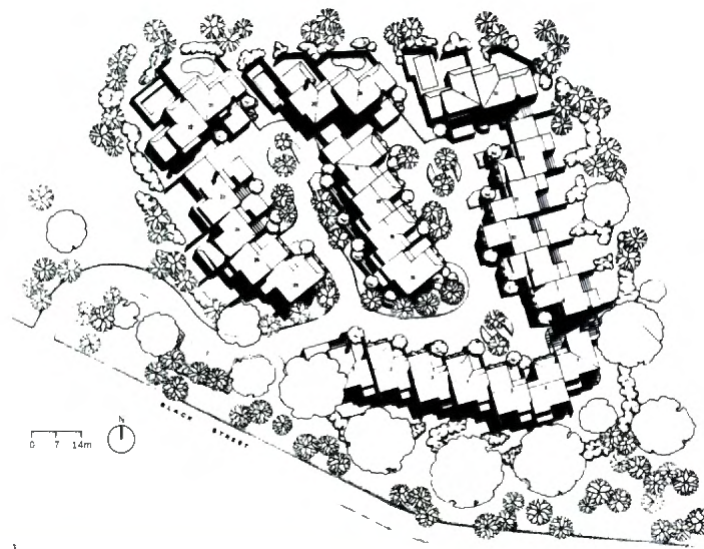

*Figure 1 Site plan from Ken Woolley - Selected and Current Works p.110*