

# DEVELOPMENT APPLICATION

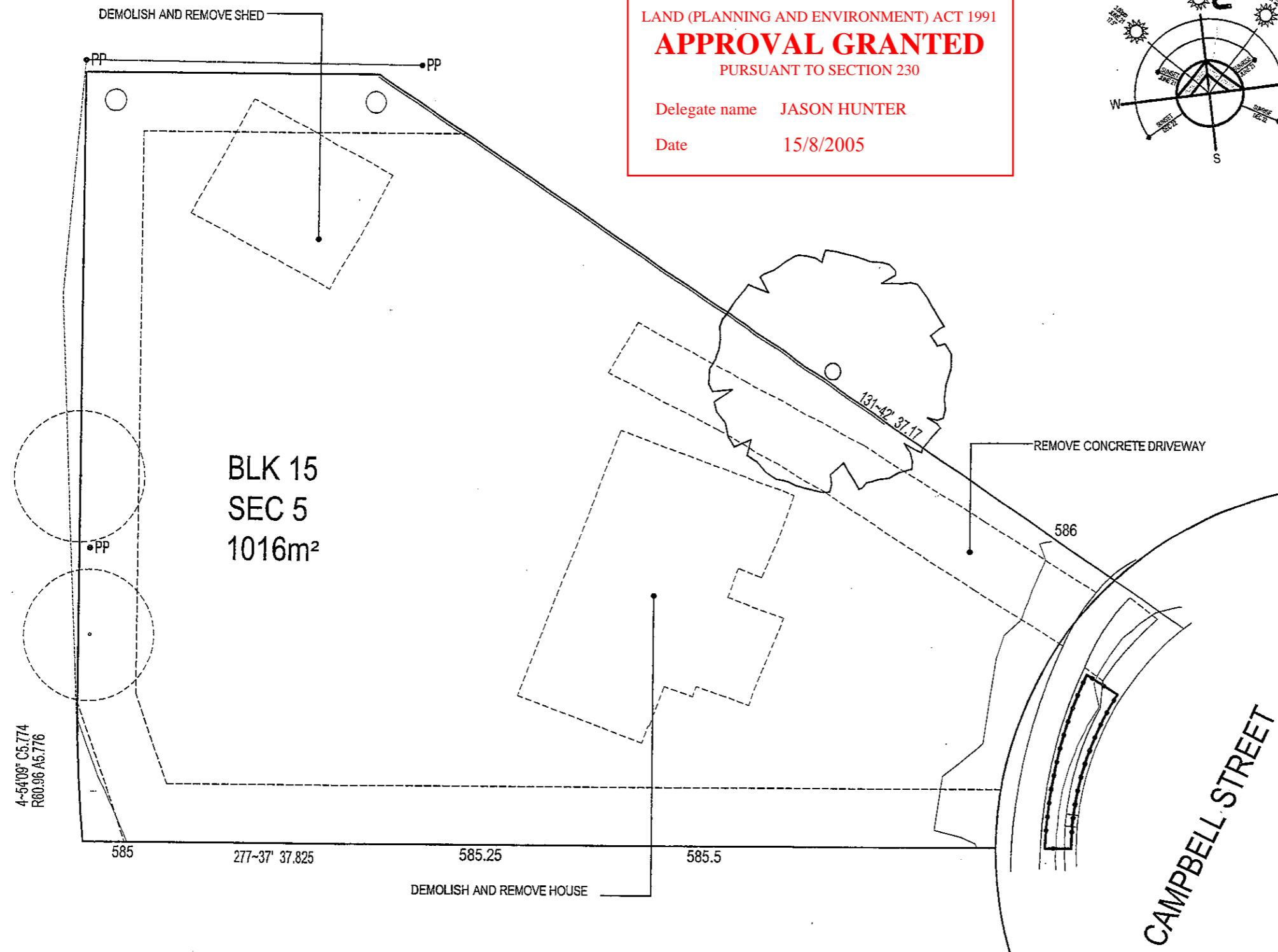

LAND (PLANNING AND ENVIRONMENT) ACT 1991  
**APPROVAL GRANTED**  
 PURSUANT TO SECTION 230

Delegate name **JASON HUNTER**  
 Date **15/8/2005**

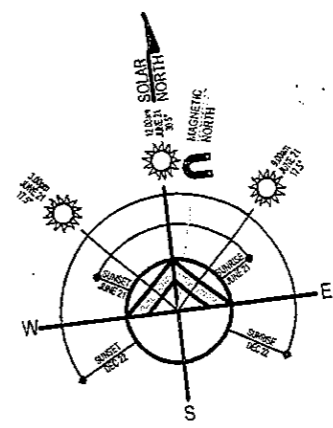

### NOTES:

- Inform ACTEW/AGL to disconnect Gas, Power Supply, and Water Supply prior to any demolition works on site.
- Contact 'Dial Before you Dig' prior to demolition works for all existing services on site.
- Fence off site to restrict public access.
- Remove trees (shown dashed on the drawings) from site.
- Any asbestos based material shall be removed from site and disposed of by a licenced contractor
- Remove footings of structures to be demolished

### VERGE MANAGEMENT

- Install 1800mm tall continuous chain wire fence supported by 2400mm tall steel posts. Fencing to be erected prior to commencement of site work and removed at completion of construction and commencement of verge restoration
- The builder is responsible for the reinstatement of all damages incurred to land, vegetation, services, paths and roads as a result of this construction work.
- Verge areas must be handed over to city operations with a healthy even grass cover at completion of construction works.

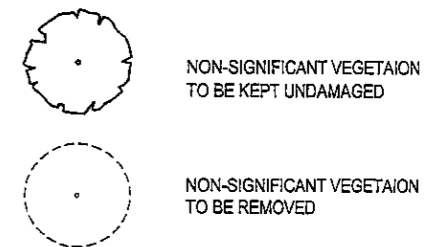

JOB NO: **0370** PROPOSED SUPPORTIVE HOUSING DEVELOPMENT  
 Block 15 Section 5  
 53 CAMPBELL STREET

AMMENDMENTS			
DATE	DESCRIPTION	CODE	
24.3.05	ISSUED FOR DA	1	

Verified	ISSUE	DRAWN	SCALE
Approved	Preliminary	DS	1:200
Reviewed	Tender	DATE	REVISION
	Construction	JAN '05	1

**DEMOLITION & VERGEMANAGEMENT**  
**A02** T T ARCHITECTURE  
 35 KENNEDY STREET KINGSTON ACT  
 Tel: 62326311 Fax: 62326312  
 A.B.N. 72 087 549 835 A.C.N. 097 549 835