



ACT Heritage Council

## Entry to the ACT Heritage Register

*Heritage Act 2004*

### **20097. Palmer Trigonometrical Station**

Section 48 Block 1(part)

**AMAROO**

This document has been prepared by the ACT Heritage Council.

This entry which was previously part of the old heritage places or the old heritage objects registers (as defined in the **Heritage Act 2004**), as the case may be, is taken to be registered under the **Heritage Act 2004**.

Conservation Requirements (including Specific Requirements), as defined under the **Heritage Act 2004**, that are contained within this document are taken to be Heritage Guidelines applying to this place or object, as the case may be.

Information restricted under *the old heritage places register or old heritage objects register* is restricted under the **Heritage Act 2004**.

**Contact:** ACT Heritage Council c/o Secretary PO Box 144  
**Enquiries:** phone 02 6207 2164 fax 02 6207 5715

Lynham ACT 2602  
e-mail [heritage@act.gov.au](mailto:heritage@act.gov.au)



ACT Government



environment ACT

Helpline: 02 6207 9777  
Website : [www.cmd.act.gov.au](http://www.cmd.act.gov.au)  
E-mail: [EnvironmentACT@act.gov.au](mailto:EnvironmentACT@act.gov.au)



ACT Heritage Council

**AUSTRALIAN CAPITAL TERRITORY  
ENTRY TO AN INTERIM HERITAGE PLACES REGISTER FOR:**

**Palmer Trigonometrical Station  
Amaroo**

For the purposes of s. 54 of the *Land (Planning and Environment) Act 1991*, this heritage assessment for the above places has been prepared by the ACT Heritage Council as the basis for its inclusion within an interim Heritage Places Register.

This is pursuant to the Heritage Council decision at Meeting 85 on 21 August 2003:

Notification Effective: 21 December 2004

**Further information about this place is available from:**

**The Secretary  
ACT Heritage Council  
PO BOX 144  
LYNEHAM ACT 2602**

**Telephone: (02) 6207 2164  
Facsimile: (02) 6207 2200**

## Palmer Trigonometrical Station

---

### LOCATION OF PLACE:

Part of Block 1, Section 48, Amaroo, comprising the stone cairn and an open mown grassed area 8.5 metres in circumference from the centre of the cairn.  
ACT 1:10,000 Planning Series Map number 208-612, at Grid Ref 210 593 - 615 595  
(refer Figure 1 below)

### FEATURES INTRINSIC TO THE HERITAGE SIGNIFICANCE OF PALMER TRIGONOMETRICAL STATION

The features which contribute to the heritage significance of Palmer Trigonometrical Station, and which require conservation, comprise:

- The stone cairn, including the renewed wooden pole and galvanised iron vanes, and
- The commemorative plaque and mount.

### STATEMENT OF SIGNIFICANCE

The Palmer Trigonometrical Station, one of a few existing cairn trigs in the ACT, was constructed in 1878 during a period of history in the rural regions of New South Wales and later the Australian Capital Territory that witnessed dramatic changes in rural land ownership and settlement patterns. It represents a surveying technique that is no longer used and is physical evidence that can be used to recall the lifestyle of the early surveyors and their assistants who surveyed the land in the Ginninderra/Gunghalin region of the ACT.

The Trig has value as a teaching site, to explain changes in occupation, land use, settlement patterns and rural, suburban and urban development progressions.

## **SPECIFIC REQUIREMENTS FOR THE CONSERVATION OF PALMER TRIGONOMETRICAL STATION**

In accordance with s.54 of the *Land (Planning and Environment) Act 1991*, the following specific requirements are identified as essential to the conservation of the heritage significance of the place. The guiding Conservation Objective is:

**The Trigonometrical station including the stone cairn, pole and vanes be conserved and maintained in a manner appropriate to its heritage value.**

### **CONSERVATION OBJECTIVE 1.**

**Provide adequate conservation management planning**

#### ***Conservation Objective 1.1***

*Ensure that any actions impacting on the significance of the Palmer Trigonometrical Station are based on professional conservation planning.*

#### **Specific Requirements for Conservation Objective 1.1:**

- (a) Any actions impacting on the significance of the trigonometrical Station shall comply the Management recommendations outlined in the Palmer Trig Conservation Plan.
- (b) The Conservation Plan for the Palmer Trigonometrical Station should be updated every ten years.

### **CONSERVATION OBJECTIVE 2.**

**Conserve the Significant components of Palmer Trigonometrical Station**

#### ***Conservation Objective 2.1***

*Maximise the retention of the cultural significance and integrity of the Palmer Trigonometrical Station by limiting damage or removal of the trig.*

#### **Specific Requirements for Conservation Objective 2.1.**

- (a) The Trigonometrical Station shall be conserved. Maintenance shall retain as much original fabric as possible and where replacement is required replace same with same. Maintenance work to be done on the cairn is to comply with the Management recommendations outlined in the Palmer Trig Conservation Plan.
- (b) The partial or total demolition of the trig shall not be permitted except in exceptional circumstances, including where:
  - the trig is so structurally unsound as to be beyond reasonable economic repair. The application must include a professional structural assessment in support of demolition; or

- the existing condition poses a significant health or safety risk that is beyond reasonable economic repair. The application must include a professional health and safety assessment in support of demolition.

Such an application must also include a professional conservation assessment that indicates the extent to which conservation might be achieved.

- (c) Where standard conservation options are found not be feasible and prudent for the trig, demolition or removal of significant material shall be limited to minimum extent necessary, and standard conservation principles will be applied to the maximum extent possible. All original fabric to be removed or modified shall be professionally recorded and the records lodged with, and responsibly archived, by Environment ACT.

### **Conservation Objective 2.2**

*Retain the historical form and architectural character of the existing trig:*

#### **Specific Requirements for Conservation Objective 2.2**

Alterations to the existing trig shall not permitted unless the need can be clearly demonstrated.

- (a) Alterations to the existing trig shall match the existing or original details and materials. However it need not be identical in every detail provided essential details match and the character is maintained.
- (b) Original fabric shall be preserved in situ. Any disturbance to the trig fabric to be recorded before any action occurs.

### **CONSERVATION OBJECTIVE 3.**

#### **Conserve the setting of the Palmer Trigonometrical Station**



#### **Conservation Objective 3.1**

*Conserve the immediate setting of the trig to reflecting its historical function as trigonometrical station.*

#### **Specific Requirements for Conservation Objective 3.1**

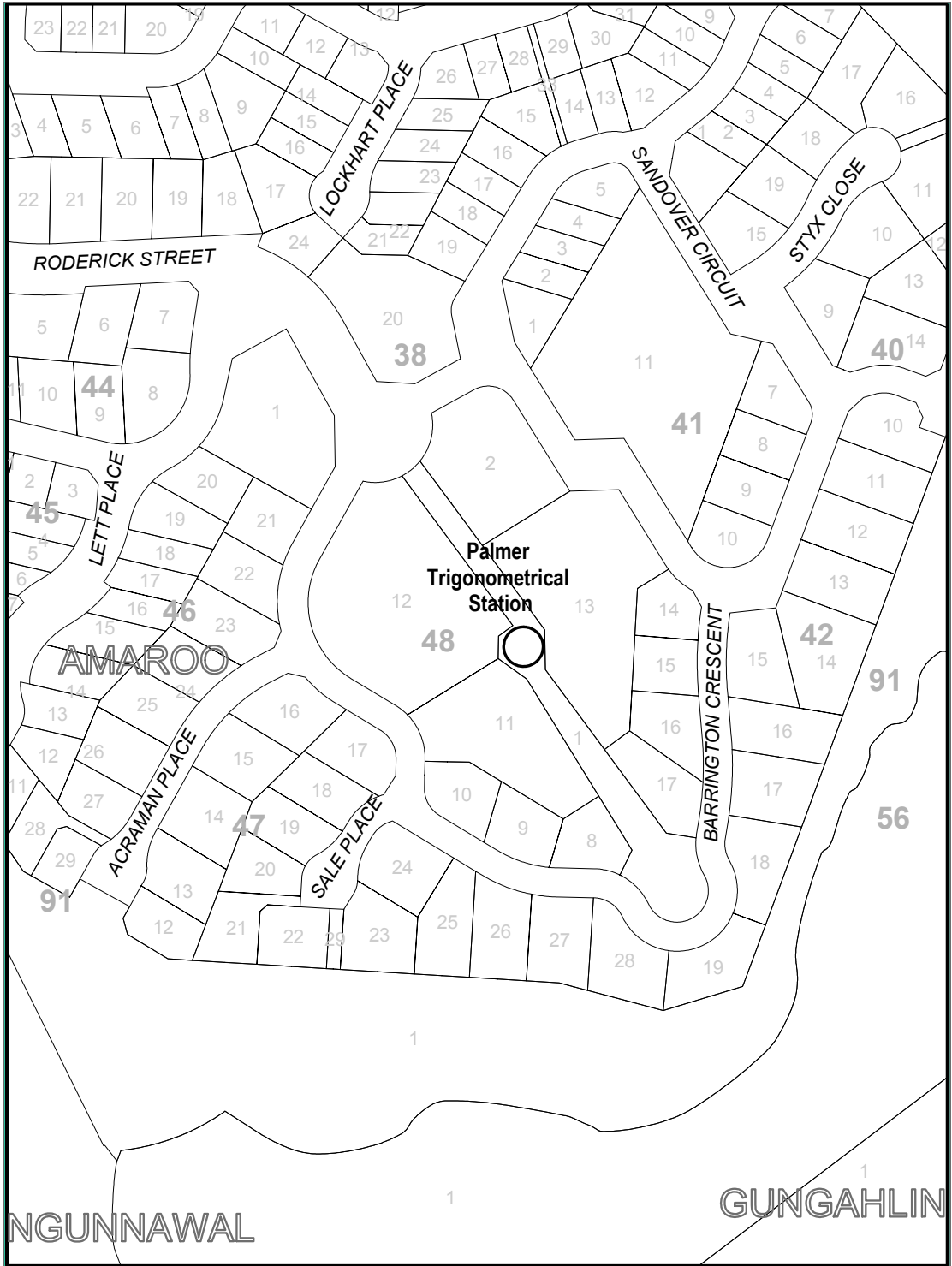
- (a) Any future landscaping undertaken shall take into consideration the heritage values of the trigonometrical station as indicated in Conservation Objective 3.1 (b), (c) and (d).
- (b) The existing line of sight north-west and south-east of the trig be maintained.
- (c) The ground conditions surrounding the cairn to be maintained in a manner that does not endanger the structure nor obstructs access or visibility.
- (d) A verge of mown grass at least 8.5 metres radius from the centre of the cairn shall be maintained.

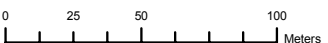

 <p><b>Contact Details</b>          ACT Heritage Unit          Macarthur House          12 Wattle Street          Lyneham ACT 2602</p> <p>PO Box 144          Lyneham ACT 2602</p> <p>Map Units: MGA Zone 55 metres          Datum: GDA 94</p> <p>Telephone (02) 6207 2166</p>	<p style="text-align: center;"><b>Historic Heritage Places</b>  <b>Palmer Trigonometrical Station</b></p> <p style="text-align: center;">04 June 2004</p>	<p><b>Legend</b></p> <p><span style="display: inline-block; width: 15px; height: 15px; border: 1px solid black; margin-right: 5px;"></span> Heritage place</p>	 <p>environment ACT          ACT URBAN SERVICES</p> <p><small>Data Copyright:          Australian Capital Territory,          Canberra 2003.</small></p>
			
Disclaimer: Environment ACT does not warrant that the data is free from errors.			