







LEGEND

-  UTILITY MAINLINE ACCESS EASEMENT
-  STORMWATER EASEMENT
-  SEWER EASEMENT
-  STORMWATER AND SEWER EASEMENT
-  DRIVEWAY LOCATION SUBJECT TO CHANGE
-  POTENTIAL DRIVEWAY LOCATION
-  FRONTYARD

BUILDINGS TO BE CONSTRUCTED TO A MINIMUM STANDARD OF BUSHFIRE ATTACK LEVEL (BAL) AS IN ACCORDANCE WITH AS 3959-2009 CONSTRUCTION OF BUILDINGS IN ROIS/PRF PRONE AREAS REFER TO SECTION 4.10

-  BLOCKS MAY NOT BE AFFECTED REFER TO SECTION 4.49
-  LIMITED DEVELOPMENTAL POTENTIAL BLOCKS REFER TO SECTION 4.48
-  CORNER BLOCKS REFER TO SECTION 4.47
-  SECONDARY SIDE BOUNDARY REFER TO SECTION 4.46
-  SURRENDERABLE BLOCKS REFER TO SECTION 4.45
-  BLOCKS OF 504.54m² REFER TO SECTION 4.44
-  COURTYARD WALL REFER TO SECTION 4.43

COURTYARD WALL REFER TO SECTION 4.43 AND BOUNDARY WALL CAN BE EXTENDED ALONG THE BOUNDARY TO THE IMPACT SETBACK OF ANY STREET FRONTAGE UNLESS THE SETBACK FROM THE BOUNDARY TO START OF WALL IS SHOWN ON THE PLANS.

-  43m² BLOCK AREA (A43)
-  5.31 BLOCK DIMENSIONS
-  STAGE BOUNDARY

NOTES

1. CONTOUR INTERVAL IS 0.5M.
- DISCLAIMER**
THE LAND DEVELOPER/AGENT MAKES NO WARRANTY REGARDING THE ACCURACY OR COMPLETENESS OF INFORMATION ON THIS PLAN/STATION AND RESERVE THE RIGHT TO MAKE ANY CHANGES TO THIS PLAN/STATION WITHOUT NOTICE. PURCHASERS OF LAND OR HOMES IN ORDER TO PURCHASE LAND.



<p>ASBESTOS DETAILS</p> <table border="1"> <tr><td>1</td><td>2</td><td>3</td><td>4</td><td>5</td><td>6</td><td>7</td><td>8</td><td>9</td><td>10</td><td>11</td><td>12</td><td>13</td><td>14</td><td>15</td><td>16</td><td>17</td><td>18</td><td>19</td><td>20</td></tr> <tr><td></td><td></td><td></td><td></td><td></td><td></td><td></td><td></td><td></td><td></td><td></td><td></td><td></td><td></td><td></td><td></td><td></td><td></td><td></td><td></td><td></td></tr> </table>		1	2	3	4	5	6	7	8	9	10	11	12	13	14	15	16	17	18	19	20																						<p>CLIENT</p> 		<p>THROSBY ESTATE STAGE 3</p>		<p>CONSULTANTS</p> <p>tait waddington</p> <p>MEMBER OF THE HOKI GROUP</p>		<p>DATE</p> <p>13/08/2024</p>		<p>PROJECT TITLE</p> <p>BLOCK DETAILS PLAN SHEET 38</p>		<p>REVISION NUMBER</p> <p>C1317B.3-BDP28</p>		<p>SCALE</p> <p>1:10,000</p>	
1	2	3	4	5	6	7	8	9	10	11	12	13	14	15	16	17	18	19	20																																					

LEGEND

- UTILITY MAINTENANCE ACCESS EASEMENT
- STORMWATER EASEMENT
- SEWER EASEMENT
- STORMWATER AND SEWER EASEMENT
- EASEMENT LOCATION SUBJECT TO CHANGE
- POTENTIAL ORIGINAL LOCATION
- FOOTPATH
- BUILDINGS TO BE CONSTRUCTED TO A MINIMUM STANDARD OF BUSINESS ATTAIN LEVEL. 2.5 (BAL-12.5) IN ACCORDANCE WITH AS 3959-2009 CONSTRUCTION OF BUILDINGS IN BUSINESS PRONE AREAS REFER TO SECTION 4.11
- BLOCKS NOT NIKSE AFFECTED REFER TO SECTION 4.9
- LIMITED DEVELOPMENT POTENTIAL BLOCK REFER TO SECTION 4.71
- CORNER BLOCK REFER TO SECTION 4.10
- SECONDARY SIDE BOUNDARY REFER TO SECTION 4.51
- SURVEILLANCE BLOCK REFER TO SECTION 4.54
- BLOCKS OF 200-500m² REFER TO SECTION 4.11
- COURTYARD WALL REFER TO SECTION 4.12
- BLOCK AREA (m²)
- BLOCK DIMENSIONS
- BLOCK DIMENSIONS
- STAGE BOUNDARY

NOTES

1. CONTOUR INTERVAL IS 0.5m.



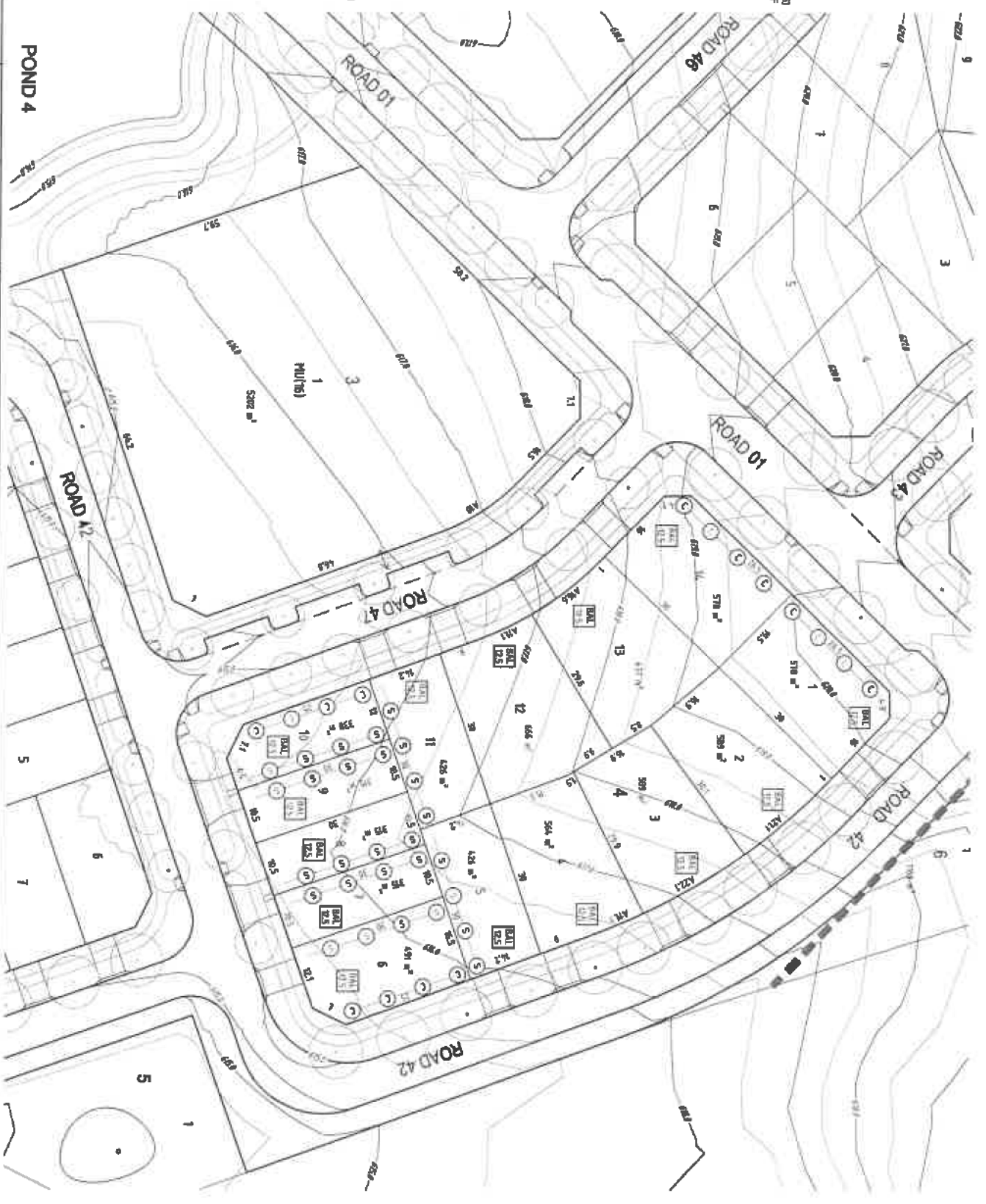

DISCLAIMER
 THE LAND DEVELOPMENT AGENCY MAKES NO WARRANTY REGARDING THE ACCURACY OR COMPLETENESS OF INFORMATION ON THIS PLAN. LAYOUT AND DIMENSIONS OBTAINED INDEPENDENT LEGAL ADVICE BEFORE CONSIDERING PURCHASING LAND OR MAKING ANY OTHER TO PURCHASE LAND.





<p>DATE: 11/20/2023</p> <p>SCALE: 1:1000</p> <p>PROJECT: THROSBY ESTATE STAGE 3</p>		<p>CLIENT: talt waddington</p>	<p>CONSULTANTS: </p>	<p>DRAWING TITLE: BLOCK DETAILS PLAN SHEET 39</p> <p>REVISIONS: C18178.3-00P39</p>
---	--	----------------------------------	----------------------	--

WARNING

THIS PLAN ONLY INDICATES AREAS OF FILL OF WHICH THE DEVELOPER AND THEIR AGENTS ARE AWARE. IT HAS NOT BEEN CHECKED BY THE TERRITORY, AND THE TERRITORY DOES NOT GUARANTEE ITS ACCURACY. IN NO WAY SHOULD THIS PLAN BE READ AS A CONCLUSIVE STATEMENT OF THE FULL EXTENT OF THE FILL THAT MAY BE FOUND ON THE WHOLE LAND DEPICTED. LESSEES AND PURCHASERS SHOULD MAKE THEIR OWN INQUIRIES IN REGARD TO THE EXACT DRAINAGE, GEOTECHNICAL AND FILL CONDITIONS AFFECTING THEIR BLOCKS.

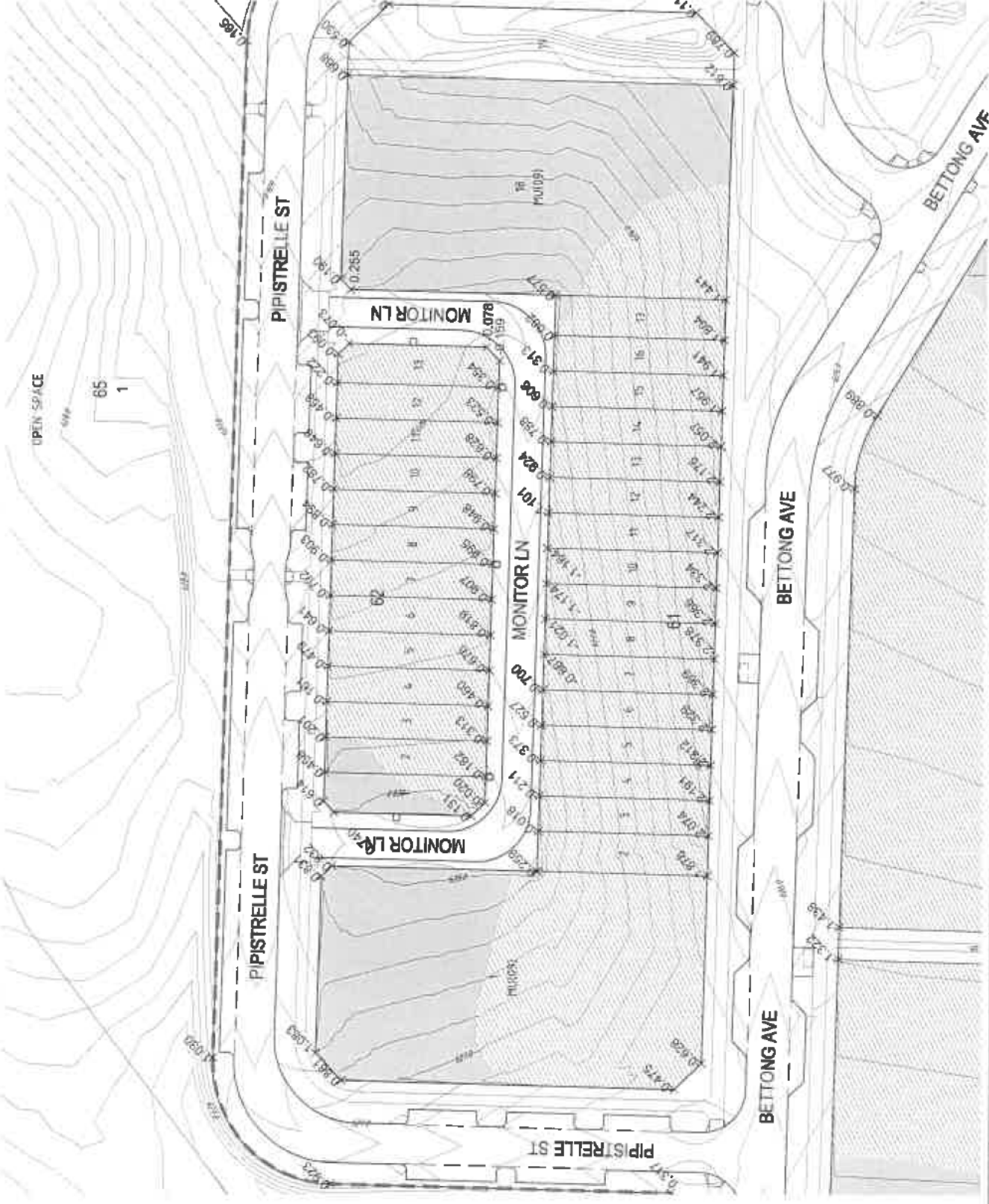



-  AREA OF KNOWN CUT (DEPTH IN METRES)
-  AREA OF KNOWN FILL (DEPTH IN METRES)
-  STAGE BOUNDARY
-  DESIGN GRADING CONTOURS (1.0m INTERVALS)



		THROSBY ESTATE STAGE 1	CORRELATION taft waddington <small>CONSULTANTS AND DESIGNERS</small>		DRAWING TITLE FILL ON BLOCKS SHEET 1 OF 10	DRAWING NUMBER C13178-F081	NUMBER A
					SCALE 1:1000	NORTH ARROW	

WARNING

THIS PLAN ONLY INDICATES AREAS OF FILL OF WHICH THE DEVELOPER AND THEIR AGENTS ARE AWARE. IT HAS NOT BEEN CHECKED BY THE TERRITORY, AND THE TERRITORY DOES NOT GUARANTEE ITS ACCURACY. IN NO WAY SHOULD THIS PLAN BE READ AS A CONCLUSIVE STATEMENT OF THE FULL EXTENT OF THE FILL THAT MAY BE FOUND ON THE WHOLE LAND DEPICTED. LESSEES AND PURCHASERS SHOULD MAKE THEIR OWN INQUIRIES IN REGARD TO THE EXACT DRAINAGE, GEOTECHNICAL AND FILL CONDITIONS AFFECTING THEIR BLOCKS.

-  AREA OF KNOWN CUT (DEPTH IN METRES)
-  AREA OF KNOWN FILL (DEPTH IN METRES)
-  STAGE BOUNDARY
-  DESIGN GRADING CONTOURS (1.0m INTERVALS)







<p>AMENDMENT DETAILS</p> <table border="1"> <tr> <td>NO.</td> <td>DATE</td> <td>BY</td> <td>CHK.</td> </tr> <tr> <td> </td> <td> </td> <td> </td> <td> </td> </tr> </table>		NO.	DATE	BY	CHK.					<p>CLIENT</p> <p>THROSBY ESTATE STAGE 1</p>	<p>CONSULTANT</p> <p>tail waddington</p> <p>CONSTRUCTION & SURVEYING</p>	<p>DRAWING TITLE</p> <p>FILL ON BLOCKS SHEET 2</p> <p>DRAWING NUMBER</p> <p>C15176-FOB2</p>	<p>PROJECT</p> <p>THROSBY ESTATE STAGE 1</p> <p>DATE</p> <p>2025</p>
NO.	DATE	BY	CHK.										



PROJECT: THROSBY ESTATE STAGE 1
 DATE: 2025

WARNING

THIS PLAN ONLY INDICATES AREAS OF FILL OF WHICH THE DEVELOPER AND THEIR AGENTS ARE AWARE. IT HAS NOT BEEN CHECKED BY THE TERRITORY, AND THE TERRITORY DOES NOT GUARANTEE ITS ACCURACY. IN NO WAY SHOULD THIS PLAN BE READ AS A CONCLUSIVE STATEMENT OF THE FULL EXTENT OF THE FILL THAT MAY BE FOUND ON THE WHOLE LAND DEPICTED. LESSEES AND PURCHASERS SHOULD MAKE THEIR OWN INQUIRIES IN REGARD TO THE EXACT DRAINAGE, GEOTECHNICAL AND FILL CONDITIONS AFFECTING THEIR BLOCKS.



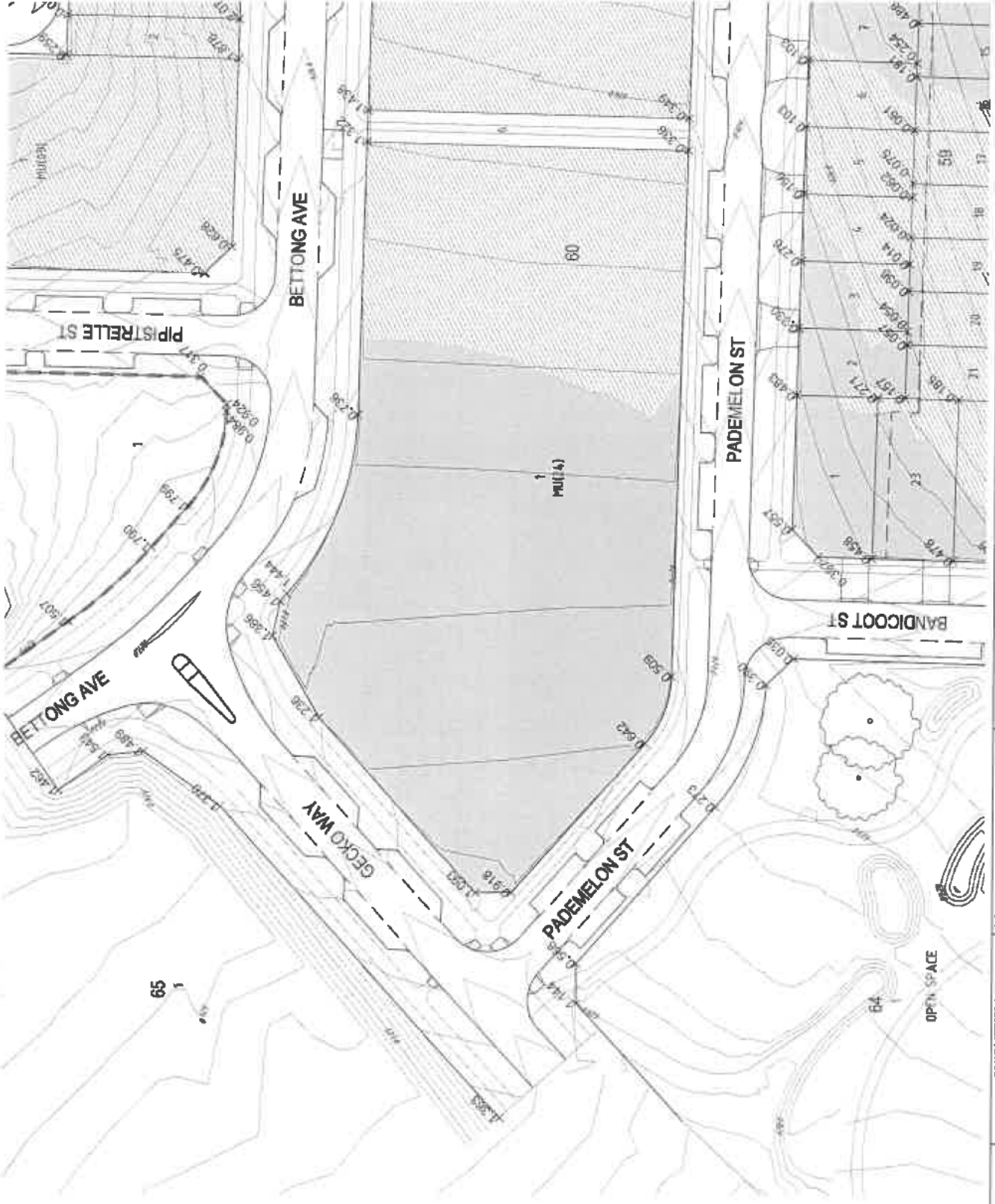

- 
 AREA OF KNOWN CUT (DEPTH IN METRES)
- 
 AREA OF KNOWN FILL (DEPTH IN METRES)
- 
 STAGE BOUNDARY
- 
 DESIGN GRADING CONTOURS (1.0m INTERVALS)



CONSULTANTS tait waddington <small>INCORPORATED IN AUSTRALIA</small>	PROJECT TITLE FILL ON BLOCKS SHEET 3		DRAWING NUMBER C13178-F0B3	AREA A
			CLIENT	

WARNING

THIS PLAN ONLY INDICATES AREAS OF FILL OF WHICH THE DEVELOPER AND THEIR AGENTS ARE AWARE. IT HAS NOT BEEN CHECKED BY THE TERRITORY, AND THE TERRITORY DOES NOT GUARANTEE ITS ACCURACY. IN NO WAY SHOULD THIS PLAN BE READ AS A CONCLUSIVE STATEMENT OF THE FULL EXTENT OF THE FILL THAT MAY BE FOUND ON THE WHOLE LAND DEPICTED. LESSEES AND PURCHASERS SHOULD MAKE THEIR OWN INQUIRIES IN REGARD TO THE EXACT DRAINAGE, GEOTECHNICAL AND FILL CONDITIONS AFFECTING THEIR BLOCKS.



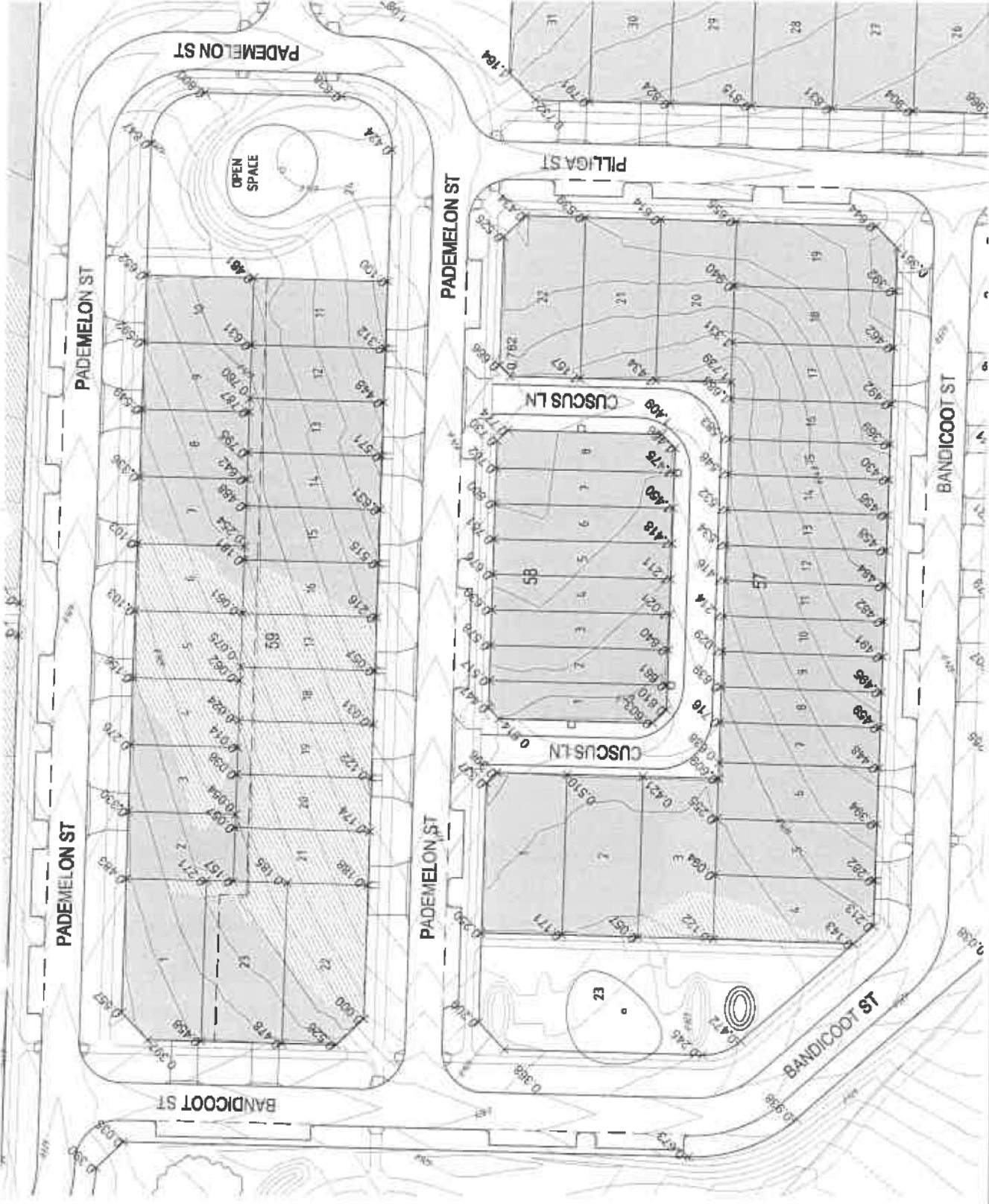

-  *0.500
AREA OF KNOWN CUT
(DEPTH IN METRES)
-  *0.500
AREA OF KNOWN FILL
(DEPTH IN METRES)
-  ---
STAGE BOUNDARY
-  6430
DESIGN GRADING CONTOURS
(1.0m INTERVALS)



  1:1000		THROSBY ESTATE STAGE 1	CONSULTANT tait waddington <small>INCORPORATED IN AUSTRALIA</small>		DRAWING TITLE FILL ON BLOCKS SHEET 5
					DRAWING NUMBER C13178-F085

WARNING

THIS PLAN ONLY INDICATES AREAS OF FILL OF WHICH THE DEVELOPER AND THEIR AGENTS ARE AWARE. IT HAS NOT BEEN CHECKED BY THE TERRITORY, AND THE TERRITORY DOES NOT GUARANTEE ITS ACCURACY. IN NO WAY SHOULD THIS PLAN BE READ AS A CONCLUSIVE STATEMENT OF THE FULL EXTENT OF THE FILL THAT MAY BE FOUND ON THE WHOLE LAND DEPICTED. LESSEES AND PURCHASERS SHOULD MAKE THEIR OWN INQUIRIES IN REGARD TO THE EXACT DRAINAGE, GEOTECHNICAL AND FILL CONDITIONS AFFECTING THEIR BLOCKS.

-  0.500
AREA OF KNOWN CUT
(DEPTH IN METRES)
-  0.500
AREA OF KNOWN FILL
(DEPTH IN METRES)
-  ---
STAGE BOUNDARY
-  ———
DESIGN GRADING CONTOURS
(1.0m INTERVALS)

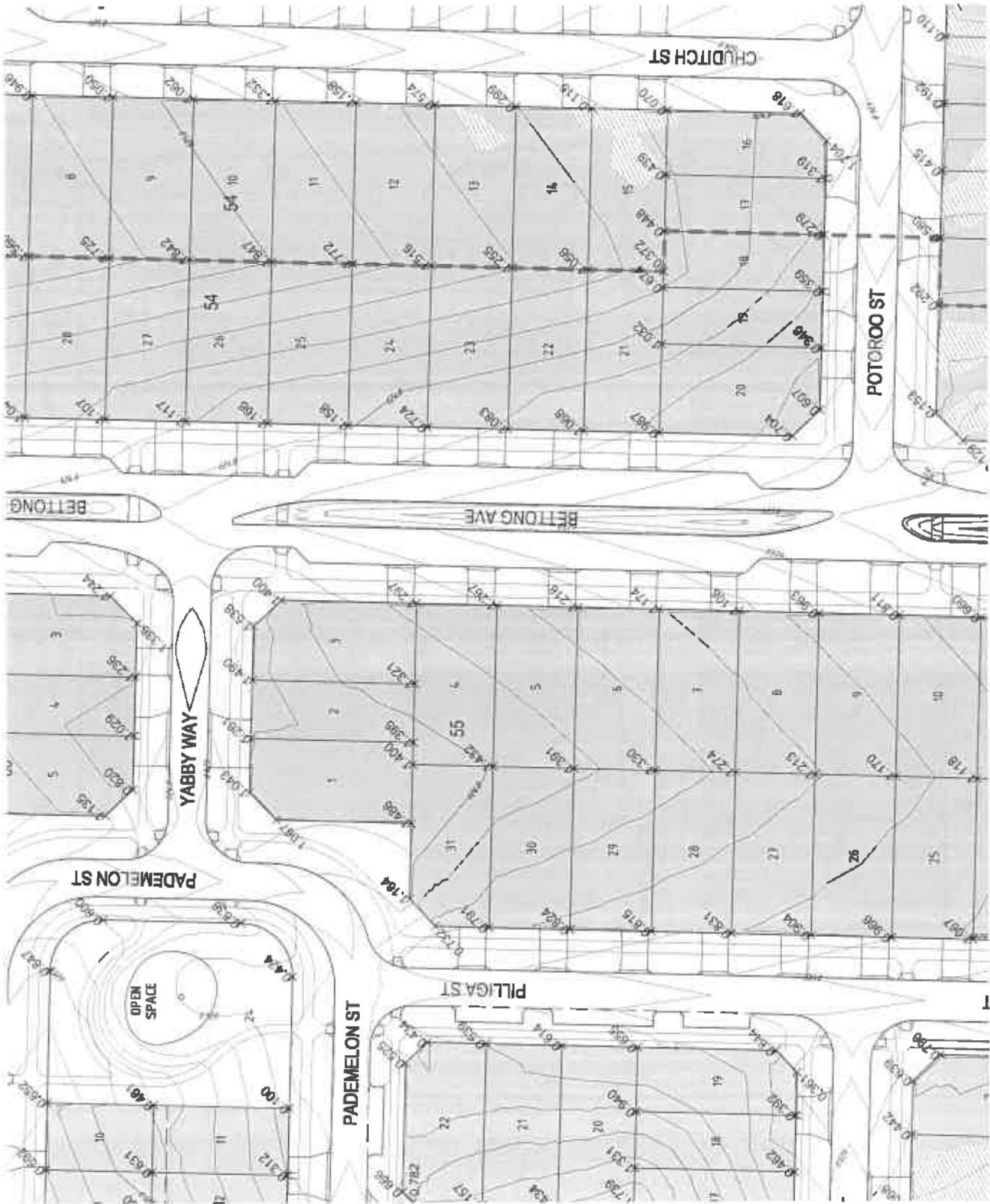

PROJECT NO. 170 DATE 17/01/2024 DRAWN BY J. COLE CHECKED BY J. COLE	AMENDMENT DETAILS	CLIENT TAIT WASHINGTON 111/113-115/117/119/121/123/125/127/129/131/133/135/137/139/141/143/145/147/149/151/153/155/157/159/161/163/165/167/169/171/173/175/177/179/181/183/185/187/189/191/193/195/197/199/201/203/205/207/209/211/213/215/217/219/221/223/225/227/229/231/233/235/237/239/241/243/245/247/249/251/253/255/257/259/261/263/265/267/269/271/273/275/277/279/281/283/285/287/289/291/293/295/297/299/301/303/305/307/309/311/313/315/317/319/321/323/325/327/329/331/333/335/337/339/341/343/345/347/349/351/353/355/357/359/361/363/365/367/369/371/373/375/377/379/381/383/385/387/389/391/393/395/397/399/401/403/405/407/409/411/413/415/417/419/421/423/425/427/429/431/433/435/437/439/441/443/445/447/449/451/453/455/457/459/461/463/465/467/469/471/473/475/477/479/481/483/485/487/489/491/493/495/497/499/501/503/505/507/509/511/513/515/517/519/521/523/525/527/529/531/533/535/537/539/541/543/545/547/549/551/553/555/557/559/561/563/565/567/569/571/573/575/577/579/581/583/585/587/589/591/593/595/597/599/601/603/605/607/609/611/613/615/617/619/621/623/625/627/629/631/633/635/637/639/641/643/645/647/649/651/653/655/657/659/661/663/665/667/669/671/673/675/677/679/681/683/685/687/689/691/693/695/697/699/701/703/705/707/709/711/713/715/717/719/721/723/725/727/729/731/733/735/737/739/741/743/745/747/749/751/753/755/757/759/761/763/765/767/769/771/773/775/777/779/781/783/785/787/789/791/793/795/797/799/801/803/805/807/809/811/813/815/817/819/821/823/825/827/829/831/833/835/837/839/841/843/845/847/849/851/853/855/857/859/861/863/865/867/869/871/873/875/877/879/881/883/885/887/889/891/893/895/897/899/901/903/905/907/909/911/913/915/917/919/921/923/925/927/929/931/933/935/937/939/941/943/945/947/949/951/953/955/957/959/961/963/965/967/969/971/973/975/977/979/981/983/985/987/989/991/993/995/997/999/1000	CONSULTANTS TAIT WASHINGTON 111/113-115/117/119/121/123/125/127/129/131/133/135/137/139/141/143/145/147/149/151/153/155/157/159/161/163/165/167/169/171/173/175/177/179/181/183/185/187/189/191/193/195/197/199/201/203/205/207/209/211/213/215/217/219/221/223/225/227/229/231/233/235/237/239/241/243/245/247/249/251/253/255/257/259/261/263/265/267/269/271/273/275/277/279/281/283/285/287/289/291/293/295/297/299/301/303/305/307/309/311/313/315/317/319/321/323/325/327/329/331/333/335/337/339/341/343/345/347/349/351/353/355/357/359/361/363/365/367/369/371/373/375/377/379/381/383/385/387/389/391/393/395/397/399/401/403/405/407/409/411/413/415/417/419/421/423/425/427/429/431/433/435/437/439/441/443/445/447/449/451/453/455/457/459/461/463/465/467/469/471/473/475/477/479/481/483/485/487/489/491/493/495/497/499/501/503/505/507/509/511/513/515/517/519/521/523/525/527/529/531/533/535/537/539/541/543/545/547/549/551/553/555/557/559/561/563/565/567/569/571/573/575/577/579/581/583/585/587/589/591/593/595/597/599/601/603/605/607/609/611/613/615/617/619/621/623/625/627/629/631/633/635/637/639/641/643/645/647/649/651/653/655/657/659/661/663/665/667/669/671/673/675/677/679/681/683/685/687/689/691/693/695/697/699/701/703/705/707/709/711/713/715/717/719/721/723/725/727/729/731/733/735/737/739/741/743/745/747/749/751/753/755/757/759/761/763/765/767/769/771/773/775/777/779/781/783/785/787/789/791/793/795/797/799/801/803/805/807/809/811/813/815/817/819/821/823/825/827/829/831/833/835/837/839/841/843/845/847/849/851/853/855/857/859/861/863/865/867/869/871/873/875/877/879/881/883/885/887/889/891/893/895/897/899/901/903/905/907/909/911/913/915/917/919/921/923/925/927/929/931/933/935/937/939/941/943/945/947/949/951/953/955/957/959/961/963/965/967/969/971/973/975/977/979/981/983/985/987/989/991/993/995/997/999/1000	PROJECT TITLE FILL ON BLOCKS SHEET 6 DRAWN BY J. COLE CHECKED BY J. COLE C:\3178-FD06	SHEET NO. 6 TOTAL SHEETS 6 DATE 17/01/2024
	THROSBY ESTATE STAGE 1	CALORE CONSULTANTS 111/113-115/117/119/121/123/125/127/129/131/133/135/137/139/141/143/145/147/149/151/153/155/157/159/161/163/165/167/169/171/173/175/177/179/181/183/185/187/189/191/193/195/197/199/201/203/205/207/209/211/213/215/217/219/221/223/225/227/229/231/233/235/237/239/241/243/245/247/249/251/253/255/257/259/261/263/265/267/269/271/273/275/277/279/281/283/285/287/289/291/293/295/297/299/301/303/305/307/309/311/313/315/317/319/321/323/325/327/329/331/333/335/337/339/341/343/345/347/349/351/353/355/357/359/361/363/365/367/369/371/373/375/377/379/381/383/385/387/389/391/393/395/397/399/401/403/405/407/409/411/413/415/417/419/421/423/425/427/429/431/433/435/437/439/441/443/445/447/449/451/453/455/457/459/461/463/465/467/469/471/473/475/477/479/481/483/485/487/489/491/493/495/497/499/501/503/505/507/509/511/513/515/517/519/521/523/525/527/529/531/533/535/537/539/541/543/545/547/549/551/553/555/557/559/561/563/565/567/569/571/573/575/577/579/581/583/585/587/589/591/593/595/597/599/601/603/605/607/609/611/613/615/617/619/621/623/625/627/629/631/633/635/637/639/641/643/645/647/649/651/653/655/657/659/661/663/665/667/669/671/673/675/677/679/681/683/685/687/689/691/693/695/697/699/701/703/705/707/709/711/713/715/717/719/721/723/725/727/729/731/733/735/737/739/741/743/745/747/749/751/753/755/757/759/761/763/765/767/769/771/773/775/777/779/781/783/785/787/789/791/793/795/797/799/801/803/805/807/809/811/813/815/817/819/821/823/825/827/829/831/833/835/837/839/841/843/845/847/849/851/853/855/857/859/861/863/865/867/869/871/873/875/877/879/881/883/885/887/889/891/893/895/897/899/901/903/905/907/909/911/913/915/917/919/921/923/925/927/929/931/933/935/937/939/941/943/945/947/949/951/953/955/957/959/961/963/965/967/969/971/973/975/977/979/981/983/985/987/989/991/993/995/997/999/1000	PROJECT NO. 170 DATE 17/01/2024 DRAWN BY J. COLE CHECKED BY J. COLE		

