

GROUND LEVEL LANDSCAPE PLAN

LEGEND

Hardscape

- Existing paving to be retained
- Road
- P1a - Proposed granite unit paving
- P1b - Proposed concrete unit paving
- P1c - Proposed cobble threshold sets
- Awning Over

Urban Elements

- Circular seat
- Seating with back rest
- Motorbike parking
- Fixed seating elements

Softscape

- Indicative trees
- Planting in deep soil
- Raised planters

NOTE:

Refer to page L-DA-28 for Plant Schedule

AMENDMENTS SCHEDULE

- A1** - Substation has been shifted to Antill St
- A2** - The footpath on Antill Street has been shifted from along the verge.
- A3** - Addition of an outdoor plaza with fixed bespoke seating
- A4** - Existing Loading zone locations have been retained
- A5** - Addition of trees, planting, motorcycle & bike parking along Road A. Trees to be crown lifted so as not to obstruct views to heritage library
- A6** - Raised planters with trees & planting over basement added
- A7** - Street furniture added to Badham Street
- A8** - Screening climber planting along Antill Street facade
- A9** - Inclusion of bollards to prevent illegal parking in verge

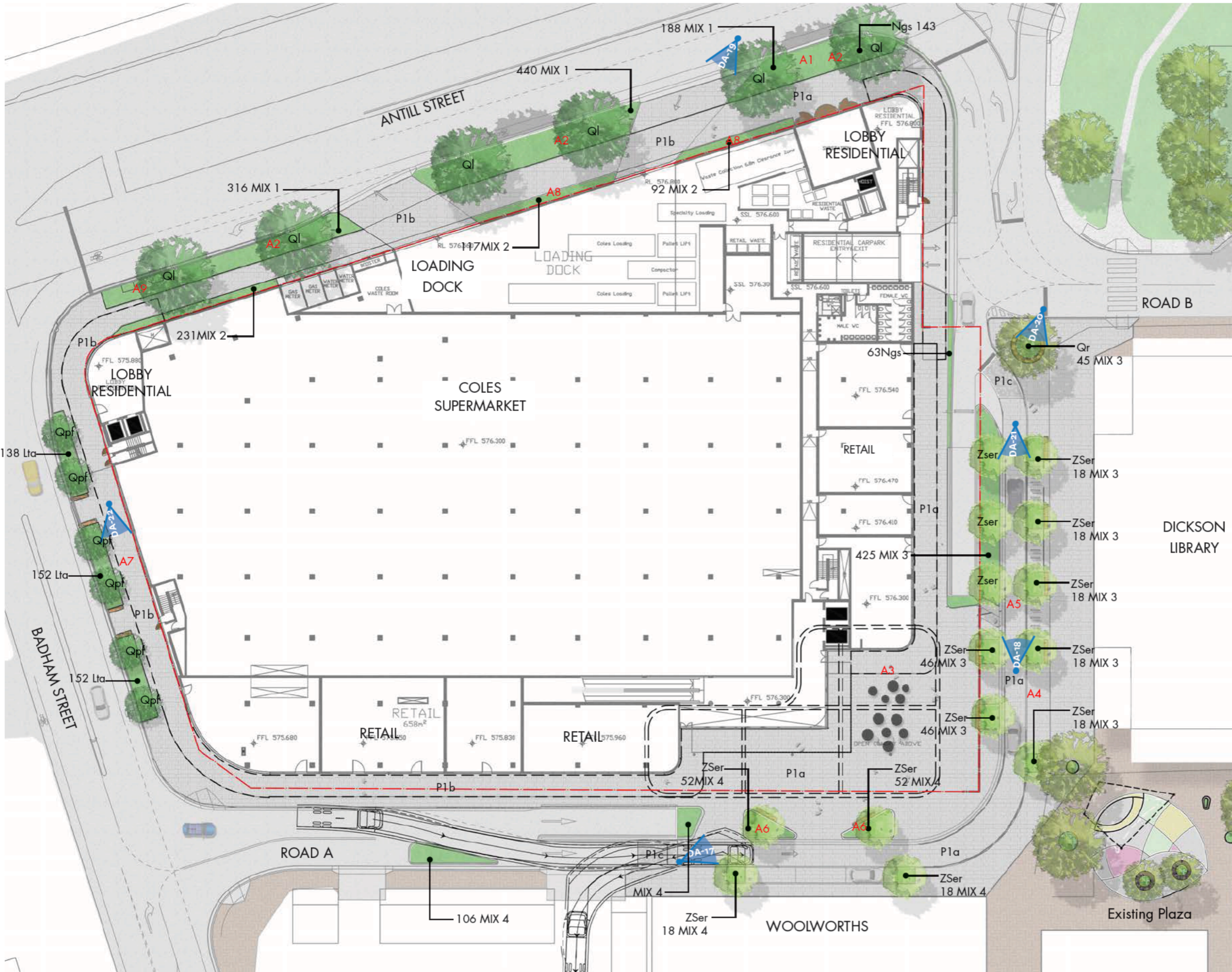

PROJECT, ADDRESS		LANDSCAPE DA REPORT	
Iss.	Amendment	Date	Checked
A	CITY RENEWAL AUTHORITY - CIRCULATION ISSUE	Oct/2018	SI
B	LANDSCAPE REPORT	14/11/18	SJ
C	LANDSCAPE REPORT	14/12/18	SJ
D	LANDSCAPE REPORT	20/12/18	SJ



DESIGN RESPONSE

GROUND LEVEL PAVING PLAN

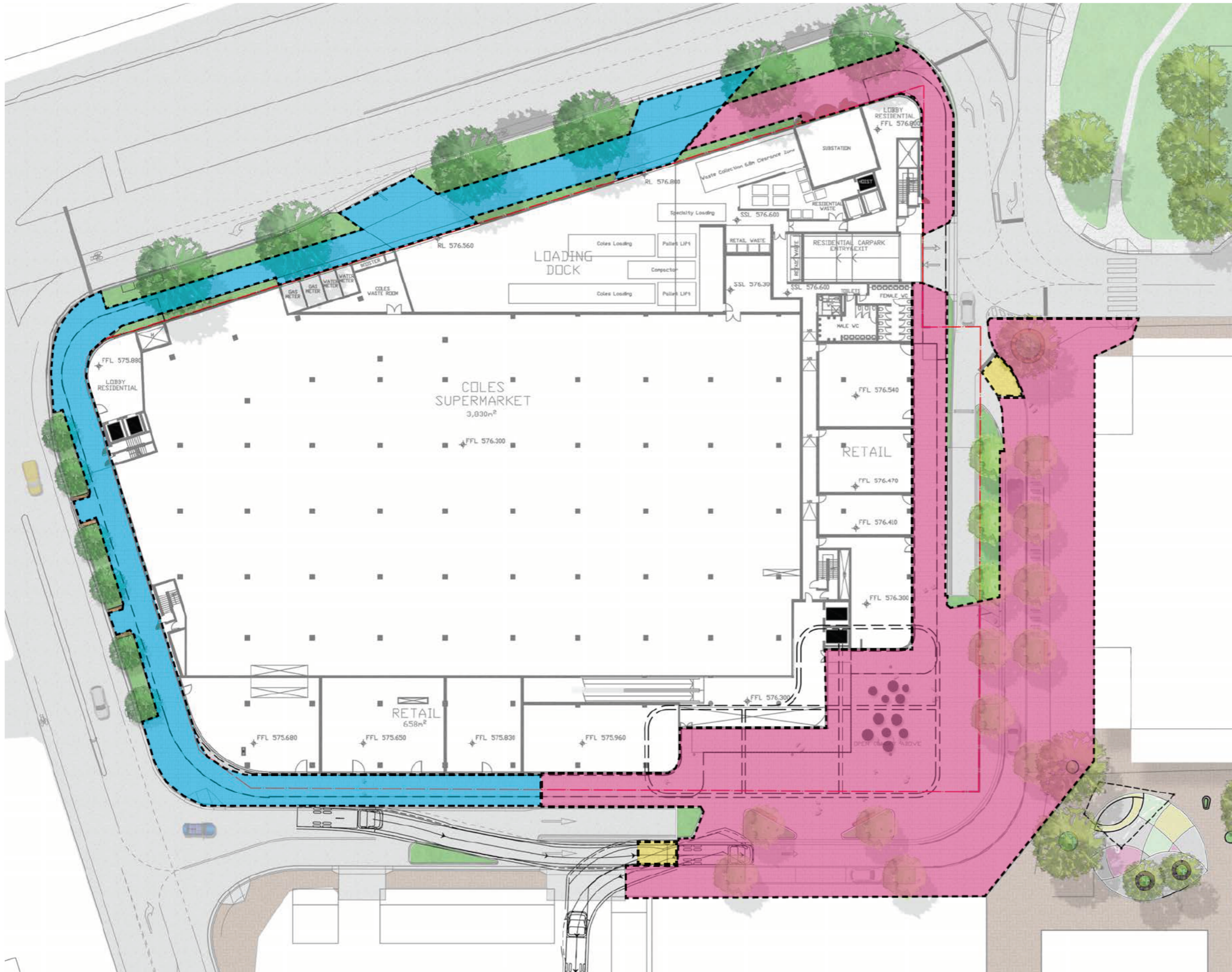

Paving Type 1:
Austral Black granite pavers
Exfoliated finish



Paving Type 2:
Charcoal coloured concrete
In situ broomed finish



Paving Type 3:
Cobble thresholds sets
Granite

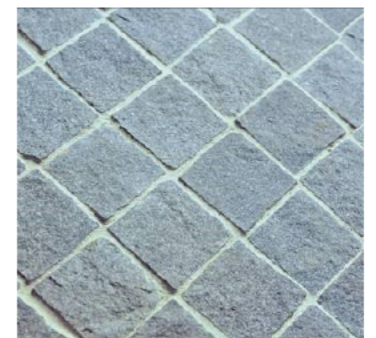

PROJECT, ADDRESS		LANDSCAPE DA REPORT	
Iss.	Amendment	Date	Checked
A			S
B	LANDSCAPE REPORT	14/11/18	SJ
C	LANDSCAPE REPORT	14/12/18	SJ
D	LANDSCAPE REPORT	20/12/18	SJ

SOFTSCAPE - GROUND FLOOR PALETTE

PROPOSED TREE PALETTE

TREES						
Code	Botanical Name	Common Name	Mature Height (m)	Mature Spread (m)	Pot Size (Ltr)	Quantity
Ql	Quercus lusitanica	Portugese Oak	20	10	200LTR	6
Qr	Quercus ilex	Holly Oak	20	10	400LTR	1
Qpf	Quercus palustris fastigiata	Pin Oak	15	8	200LTR	6
Zser	Zelkova serrata	Japanese zelkova	14	10	200LTR	13

Zelkova serrata: To be crown lifted to 3.5m in front of the Dickson Library



Quercus lusitanica



Quercus ilex



Quercus palustris fastigiata



Zelkova serrata

INDICATIVE UNDERSTOREY PALETTE

PUBLIC DOMAIN MIX 1							
Code	Botanical Name	Common Name	Mature Height (m)	Mature Spread (m)	Spacing (mm)	Pot Size (mm)	Quantity
Agd	Abelia x grandiflora 'Dwarf'	Golden Abelia	1	1	500	200	315
Bvn	Baeckea virgata 'Nana'	Miniature Baeckea	.5	.5	500	200	315
Lta	Lomandra 'Tanika'	Tanika	0.5	0.5	500	150	315
PUBLIC DOMAIN MIX 2							
Leg	Liriope 'Evergreen Giant'	Turf Lily	0.4	0.5	400	200	220
Ptr	Parthenocissus tricuspidata	Boston Ivy	10	10	400	200	220
PUBLIC DOMAIN MIX 3							
Bmi	Buxus microphylla	Dwarf Box	.5	.5	500	200	131
Cdb	Correa 'Dusky Bells'	Native Fuchsia	1	2	500	200	131
Cht	Choisya ternata	Mexican Orange	2	2	500	200	131
Leg	Liriope 'Evergreen Giant'	Turf Lily	0.4	0.5	500	200	131
Tas	Trachelospermum asiaticum	Star Jasmine	10	8	500	150	131
PUBLIC DOMAIN MIX 4							
Att	Agave attenuata	Foxtail agave	1.5	1	500	200	49
Cki	Coprosma x kirkii	Mirror Bush	0.75	2	500	150	49
Maq	Mahonia aquifolium	Oregon Grape	1.5	1	500	200	49
Mpa	Myoporum parvifolium	Creeping boobialla	0.2	1.5	500	150	49
Tja	Trachelospermum jasminoides	Star Jasmine	10	8	500	150	49
MASS PLANTING							
Lta	Lomandra 'Tanika'	Tanika	0.5	0.5	500	200	442
Ngs	Nandina 'Gulf Stream'	Gulf Stream Nandina	0.7	0.7	500	200	206

MIX 1



Abelia x grandiflora 'Dwarf'



Baeckea virgata 'Nana'



Lomandra 'Tanika'



Liriope 'Evergreen Giant'



Parthenocissus tricuspidata

MIX 2

MIX 3



Buxus microphylla



Choisya ternata



Liriope 'Evergreen Giant'



Trachelospermum asiaticum

MIX 4



Agave attenuata



Coprosma x kirkii



Mahonia aquifolium



Myoporum parvifolium



Trachelospermum jasminoides

MASS PLANTING



Lomandra 'Tanika'

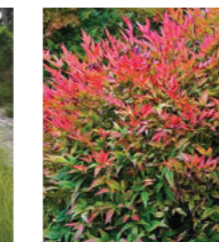

Nandina 'Gulf Stream'

PROJECT, ADDRESS		LANDSCAPE DA REPORT	
Iss.	Amendment	Date	Checked
A	CITY RENEWAL AUTHORITY - CIRCULATION ISSUE	Oct/2018	SI
B	LANDSCAPE REPORT	14/11/18	SJ
C	LANDSCAPE REPORT	14/12/18	SJ
D	LANDSCAPE REPORT	20/12/18	SJ