

**From:** [REDACTED]  
**To:** [EPSDFOI](#)  
**Cc:** [REDACTED]  
**Subject:** Re: Freedom of Information - Missing documents - FOI 23/004893 - action required please - ACTMapi  
**Date:** Thursday, 22 June 2023 11:55:13 AM  
**Attachments:** [REDACTED]

---

**Caution:** This email originated from outside of the ACT Government. Do not click links or open attachments unless you recognise the sender and know the content is safe. [Learn why this is important](#)

Hi Raffaele,

Would I please be able to lodge the request as an official FOI.

I've attached the request from January.

In summary,

What documents, correspondence, or minutes does EPSDD hold in regards to the request, action, approval and processing of custodianship change and split of the block, so that the section of the block that a car park is built on is managed by TCCS Roads ACT as opposed to Sports and Recreation, as per management plan.

The full details are included in the attached FOI request.

Thank you so much for your help with this,

[REDACTED]

On Thu, 1 June 2023, 2:13 pm EPSDFOI, <[EPSDFOI@act.gov.au](mailto:EPSDFOI@act.gov.au)> wrote:

**OFFICIAL**

Good Afternoon [REDACTED]

Apologies for the delay in responding to your email from the 20<sup>th</sup> of May. Our intention was to respond to your questions directly at the same time when the decision and documents for FOI 23/004893 were sent out to you, however the EPSDD officer who is most knowledgeable in the custodian maps that we had forwarded your questions to has been on leave for some time and only recently returned. We will endeavour to provide an answer to your questions as soon as possible. Thank you for your patience as we work through your questions.

Kind regards,



---

## Extension request - FOI 22/135476 - Block 23 Section 41 Lyneham

---

13 January 2023 at 17:29

To: EPSDFOI <EPSDFOI@act.gov.au>

Hi Ruth and EPSDD FOI team,

### FOI request.

Thank you again for the incredible effort that you have put into collecting documents regarding block 23, section 41 Lyneham.

I would like to follow up on the response provided for our FOI into the subdivision of block 23, appearing in the ACTmapi custodian map.

The area that the Lyneham Community are concerned about is at the northern boundary of block 23 (aka block 27), which the Brindabella Community College use as a car park.

The information provided by EPSDFOI on Friday the 6th of January regarding AP7083 and AP7412 is in reference to the minor boundary alignment at the opposite corner of block 23, at the boundary of block 18.

- **AP7083** created blocks 27 and 28 (as part of DA-201426093). It was a very tiny change, a minor boundary alignment at the corner of block 18 and block 23.
- **AP7412** reinstated blocks 18 and 23, after DA-201426093 was withdrawn.

This FOI request is concerned with the boundary at the northern end of block 23, as pictured below.

Neither AP7083 nor AP712 provide information about why block 23 (aka 27) was split into two along the boundary of the car park. This boundary change is more aligned with the direct sale attempt of Brindabella Christian College in 2016.

On the ACTmapi Land Custodian map, it states that the part of block 23 (represented as block 27) is managed by TCCS Roads ACT on the custodian map. This is the site of a car park development that the Lynegam community is seeking information about.

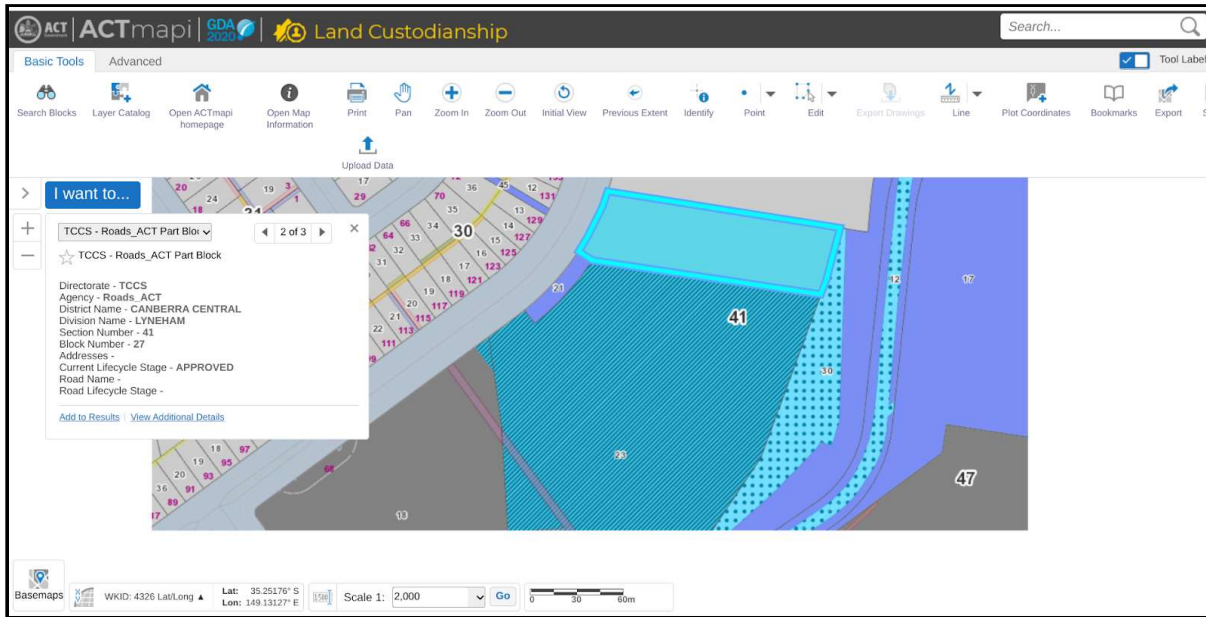

The remainder of block 23 (aka block 27) is managed by TCCS Sport and Recreation Facilities on the custodian map.

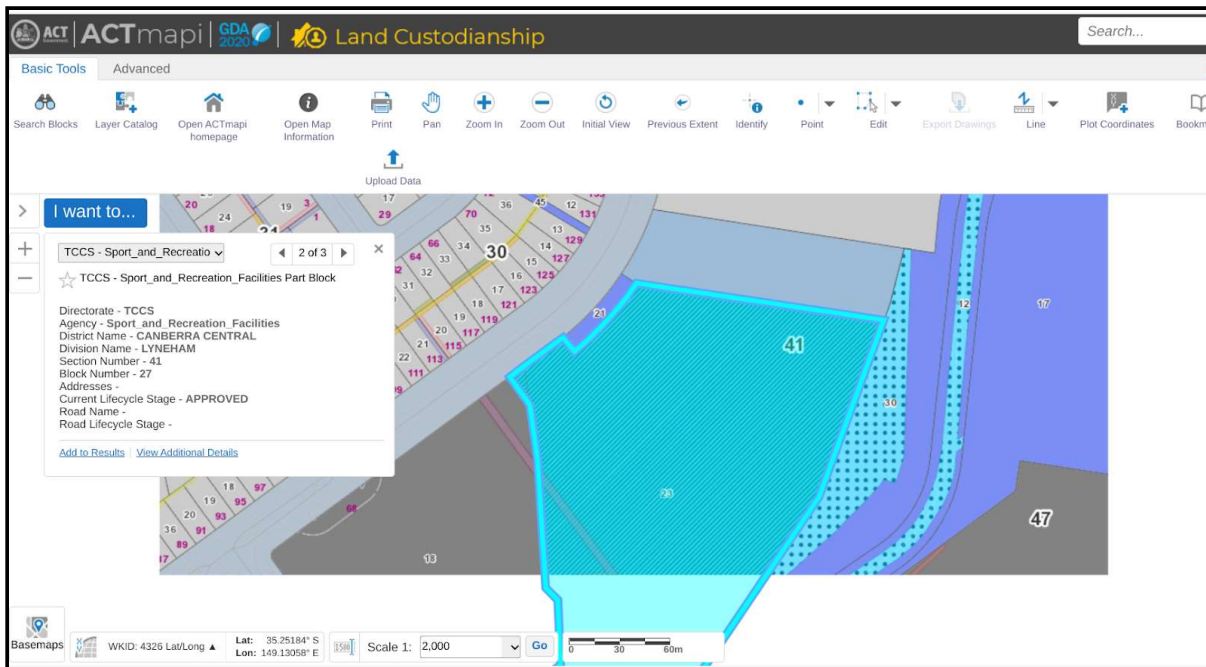

I would please like to re-submit a refined and more specific FOI request:

- Why is block 23 (aka block 27) split into two blocks on the custodian map? As pictured above, more specifically, why is the northern section of block 23 (aka 27), the car park, managed by TCCS ACT Roads, and the remainder of the block is managed by TCCS Sport and Recreation Facilities.
- Why do the Custodian map and the Territory Plan map differ? (why is there a boundary change, sectioning off the car park at the northern end of block 23 (aka 27) in the custodian map, and not the Territory Map).
- What documents or correspondence does EPSDD hold in regards to the request, action and approval for the modification of the land custodian map, to action this split on the public ACTMapi land custodian map?

Thank you so much for your help getting to the bottom of what's going on at this site. I really hope this information can provide valuable insights into when, why and how the car park was developed on this public land site.

Thank you,

