

MOLONGLO / COOMBS & WRIGHT TREE ASSESSMENT

Tree N°: 1517



Regulated Tree:	N
Classification of Tree Quality:	
• Arboricultural Assessment	P
• Contribution to Urban Amenity	P
Recommendation:	Remove
Location	

Survey Details:

Organisation:	dsb Landscape Architects	Grid Co-ordinates:	E 202468.5	N 599750.0
Date of Survey:	4 th November 2009	Assessor ID:	JL & ST	

Tree Details:

Species:	Eucalyptus viminalis			Common Name:	Ribbon gum		
Height:	5	Canopy spread:	3	Trunk Circum:	1000	N° of Trunks	5
Health/Condition:	Relative density of foliage						M
	Amount of dead wood in canopy						H
	Prevalence of insect attack or disease						M
	Prevalence of epicormic growth						M
	Prevalence of mistletoe						H
Overall health/condition of the tree						P	
Age:	A	Age/Health/Condition:	A/P	Form:	U	Hazard Potential:	M
Habitat Value:	N			Tolerance to Disturbance:	M		

Contribution to Future Urban Amenity:

Scenic:	L	Rareness or Commonness:	M	Habitat quality:	M	Cultural, Social, Scientific:	L
Contribution to Immediate Landscaping:		L	Comment: Coppice growth.				
Economic justification for retention or removal:							
Ameliorative work to reduce Risk:			N	Is work cost effective?:			
Landscape Groups:		Comment:					

Tree Protection and Management:

Tree Protection Zone & Conditions:	M	b, c & d always apply
Arboricultural Notes:		

MOLONGLO / COOMBS & WRIGHT TREE ASSESSMENT

Tree N°: 1518



Regulated Tree:	N
Classification of Tree Quality:	
• Arboricultural Assessment	P
• Contribution to Urban Amenity	P
Recommendation:	Remove
Location	

Survey Details:

Organisation:	dsb Landscape Architects	Grid Co-ordinates:	E 202474.8	N 599772.1
Date of Survey:	4 th November 2009	Assessor ID:	JL & ST	

Tree Details:

Species:	Eucalyptus viminalis			Common Name:	Ribbon gum		
Height:	5	Canopy spread:	4	Trunk Circum:	1000	N° of Trunks	4
Health/Condition:	Relative density of foliage						M
	Amount of dead wood in canopy						H
	Prevalence of insect attack or disease						H
	Prevalence of epicormic growth						M
	Prevalence of mistletoe						H
Overall health/condition of the tree						P	
Age:	A	Age/Health/Condition:	A/P	Form:	U	Hazard Potential:	M
Habitat Value:	N			Tolerance to Disturbance:	M		

Contribution to Future Urban Amenity:

Scenic:	L	Rareness or Commonness:	M	Habitat quality:	M	Cultural, Social, Scientific:	L
Contribution to Immediate Landscaping:		L	Comment: Coppice growth.				
Economic justification for retention or removal:							
Ameliorative work to reduce Risk:			N	Is work cost effective?:			
Landscape Groups:		Comment:					

Tree Protection and Management:

Tree Protection Zone & Conditions:	M	b, c & d always apply					
Arboricultural Notes:							

MOLONGLO / COOMBS & WRIGHT TREE ASSESSMENT

Tree N^o: 1536

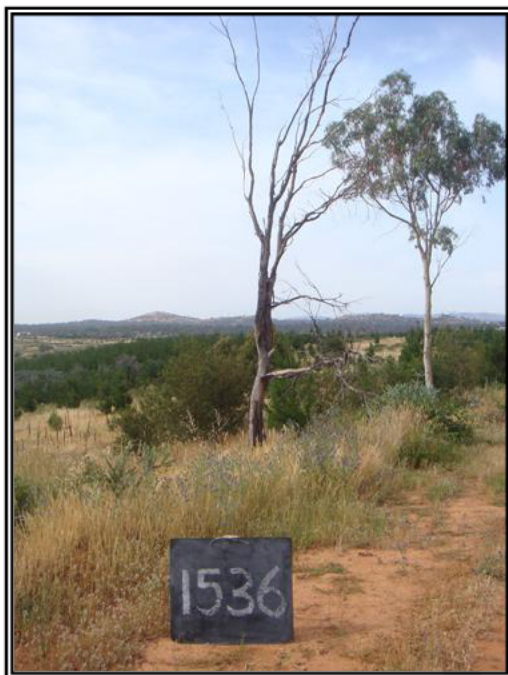

Regulated Tree:	
Classification of Tree Quality:	
<ul style="list-style-type: none"> Arboricultural Assessment 	
<ul style="list-style-type: none"> Contribution to Urban Amenity 	
Recommendation:	Remove
Location	

Survey Details:

Organisation:	dsb Landscape Architects	Grid Co-ordinates:	E 203102.539	N 600529.203
Date of Survey:	4 th November 2009	Assessor ID:	JL & ST	

Tree Details:

Species:		Common Name:	
Height:		Canopy spread:	
		Trunk Circum:	
		N ^o of Trunks	
Health/Condition:	Relative density of foliage		
	Amount of dead wood in canopy		
	Prevalence of insect attack or disease		
	Prevalence of epicormic growth		
	Prevalence of mistletoe		
	Overall health/condition of the tree		
Age:		Age/Health/Condition:	
		Form:	
		Hazard Potential:	
Habitat Value:		Tolerance to Disturbance:	

Contribution to Future Urban Amenity:

Scenic:		Rareness or Commonness:		Habitat quality:		Cultural, Social, Scientific:	
Contribution to Immediate Landscaping:		Comment:	Dead.				
Economic justification for retention or removal:							
Ameliorative work to reduce Risk:		Is work cost effective?:					
Landscape Groups:		Comment:					

Tree Protection and Management:

Tree Protection Zone & Conditions:		b, c & d always apply
Arboricultural Notes:		

MOLONGLO / COOMBS & WRIGHT TREE ASSESSMENT

Tree N^o: 1537

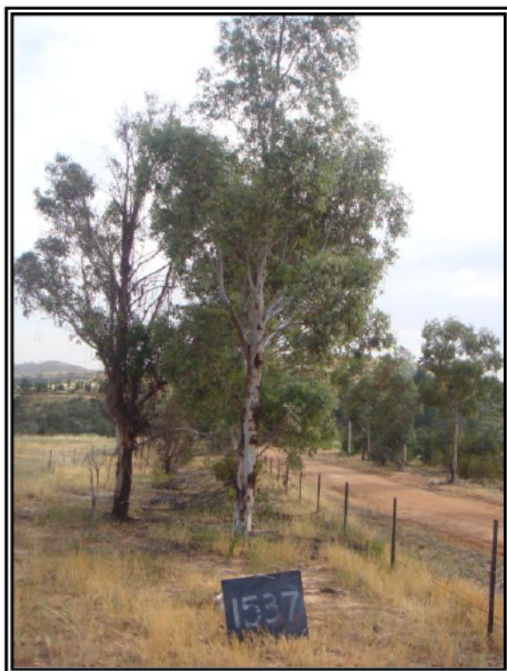

Regulated Tree:	N
Classification of Tree Quality:	
• Arboricultural Assessment	M
• Contribution to Urban Amenity	M
Recommendation:	Retain
Location	

Survey Details:

Organisation:	dsb Landscape Architects	Grid Co-ordinates:	E 203128.319	N 600594.473
Date of Survey:	19 TH November 2009	Assessor ID:	JL & ST	

Tree Details:

Species:	Eucalyptus rubida		Common Name:	Candle bark			
Height:		Canopy spread:	Trunk Circum:	900	N ^o of Trunks	1	
Health/Condition:	Relative density of foliage					M	
	Amount of dead wood in canopy					H	
	Prevalence of insect attack or disease					H	
	Prevalence of epicormic growth					H	
	Prevalence of mistletoe					H	
	Overall health/condition of the tree					G	
Age:	A	Age/Health/Condition:	A/G	Form:	T	Hazard Potential:	L
Habitat Value:	N		Tolerance to Disturbance:			M	

Contribution to Future Urban Amenity:

Scenic:	H	Rareness or Commonness:	M	Habitat quality:	M	Cultural, Social, Scientific:	L
Contribution to Immediate Landscaping:		M	Comment:		Good form.		
Economic justification for retention or removal:							
Ameliorative work to reduce Risk:			N	Is work cost effective?:			
Landscape Groups:		Comment:					

Tree Protection and Management:

Tree Protection Zone & Conditions:	M	b, c & d always apply					
Arboricultural Notes:	Remove small low branches.						

MOLONGLO / COOMBS & WRIGHT TREE ASSESSMENT

Tree N°: 1538

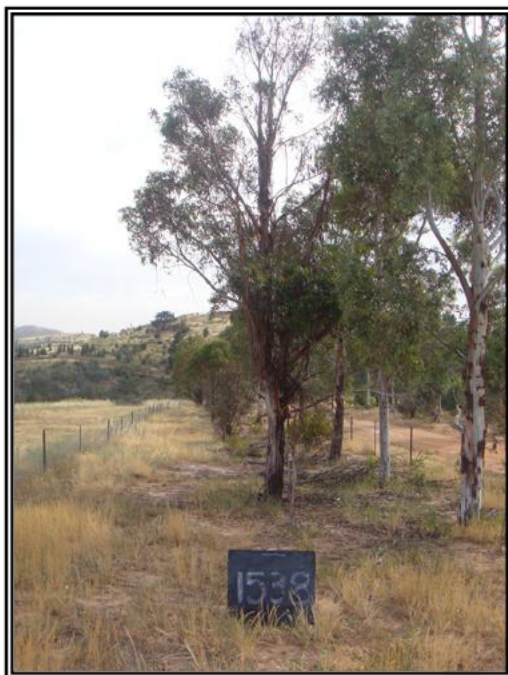

Regulated Tree:	N
Classification of Tree Quality:	
• Arboricultural Assessment	P
• Contribution to Urban Amenity	P
Recommendation:	Remove
Location	

Survey Details:

Organisation:	dsb Landscape Architects	Grid Co-ordinates:	E 203127.737	N 600599.179
Date of Survey:	19 TH November 2009	Assessor ID:	JL & ST	

Tree Details:

Species:	Eucalyptus bicostata		Common Name:	Blue gum	
Height:		Canopy spread:		Trunk Circum:	
					N° of Trunks
Health/Condition:	Relative density of foliage				L
	Amount of dead wood in canopy				L
	Prevalence of insect attack or disease				M
	Prevalence of epicormic growth				M
	Prevalence of mistletoe				H
	Overall health/condition of the tree				P
Age:	A	Age/Health/Condition:	A/P	Form:	S
				Hazard Potential:	M
Habitat Value:	N		Tolerance to Disturbance:		M

Contribution to Future Urban Amenity:

Scenic:	L	Rareness or Commonness:	M	Habitat quality:	M	Cultural, Social, Scientific:	L
Contribution to Immediate Landscaping:		L	Comment:		Unsuitable species.		
Economic justification for retention or removal:							
Ameliorative work to reduce Risk:			N	Is work cost effective?:			
Landscape Groups:		Comment:					

Tree Protection and Management:

Tree Protection Zone & Conditions:	M	b, c & d always apply					
Arboricultural Notes:	Dying.						

MOLONGLO / COOMBS & WRIGHT TREE ASSESSMENT

Tree N°: 1539



Regulated Tree:	
Classification of Tree Quality:	
• Arboricultural Assessment	M
• Contribution to Urban Amenity	M
Recommendation:	Retain
Location	

Survey Details:

Organisation:	dsb Landscape Architects	Grid Co-ordinates:	E 203131.906	N 600599.843
Date of Survey:	19 TH November 2009	Assessor ID:	JL & ST	

Tree Details:

Species:	Eucalyptus mannifera		Common Name:	White brittle gum			
Height:		Canopy spread:		Trunk Circum:	600	N° of Trunks	1
Health/Condition:	Relative density of foliage					M	
	Amount of dead wood in canopy					H	
	Prevalence of insect attack or disease					H	
	Prevalence of epicormic growth					H	
	Prevalence of mistletoe					H	
	Overall health/condition of the tree					G	
Age:	A	Age/Health/Condition:	A/G	Form:	T	Hazard Potential:	L
Habitat Value:	N		Tolerance to Disturbance:			M	

Contribution to Future Urban Amenity:

Scenic:	H	Rareness or Commonness:	M	Habitat quality:	M	Cultural, Social, Scientific:	L
Contribution to Immediate Landscaping:		M	Comment: Well-formed young tree.				
Economic justification for retention or removal:							
Ameliorative work to reduce Risk:			N	Is work cost effective?:			
Landscape Groups:		Comment:					

Tree Protection and Management:

Tree Protection Zone & Conditions:	M	b, c & d always apply					
Arboricultural Notes:							

MOLONGLO / COOMBS & WRIGHT TREE ASSESSMENT

Tree N°: 1540



Regulated Tree:	
Classification of Tree Quality:	
• Arboricultural Assessment	P
• Contribution to Urban Amenity	P
Recommendation:	Remove
Location	

Survey Details:

Organisation:	dsb Landscape Architects	Grid Co-ordinates:	E 202848.171	N 599643.196
Date of Survey:	19 TH November 2009	Assessor ID:	JL & ST	

Tree Details:

Species:	Eucalyptus viminalis		Common Name:	Ribbon gum			
Height:		Canopy spread:		Trunk Circum:	1000	N° of Trunks	3
Health/Condition:	Relative density of foliage					M	
	Amount of dead wood in canopy					L	
	Prevalence of insect attack or disease					M	
	Prevalence of epicormic growth					M	
	Prevalence of mistletoe					H	
Overall health/condition of the tree					P		
Age:	A	Age/Health/Condition:	A/P	Form:	S	Hazard Potential:	M
Habitat Value:	N		Tolerance to Disturbance:			M	

Contribution to Future Urban Amenity:

Scenic:	L	Rareness or Commonness:	M	Habitat quality:	M	Cultural, Social, Scientific:	L
Contribution to Immediate Landscaping:		L	Comment: Very poor form.				
Economic justification for retention or removal:							
Ameliorative work to reduce Risk:			N	Is work cost effective?:			
Landscape Groups:		Comment:					

Tree Protection and Management:

Tree Protection Zone & Conditions:	M	b, c & d always apply					
Arboricultural Notes:	Dead main leader.						

Appendix E-3

dsb Tree Removal Study

MOLONGLO COOMBS AND WRIGHT





TREE RETENTION PLAN

CODE SPECIES

- Ebi Eucalyptus bicostata
- Eel Eucalyptus elata
- Emf Eucalyptus mannifera
- Eru Eucalyptus rubida
- Evi Eucalyptus viminalis

LEGEND

 SURVEYED TREE

TREE RETENTION SCHEDULE	NO. OF TREES	PERCENTAGE
 EXISTING TREES TO BE REMOVED NOW	33	12%
 EXISTING TREES TO BE RETAINED FOR 5 YEARS	71	25.5%
 EXISTING TREES TO BE RETAINED FOR 10 YEARS	88	31.5%
 EXISTING TREES TO BE RETAINED FOR 20 YEARS PLUS	87	31%
TOTAL	279	100%

TREE CLASSIFICATION CODE

Y/N REGULATED TREE YES / NO

REM/RET REMOVE / RETAIN

(TREE NUMBER) (TREE SPECIES) (REGULATED Y/N) (REM- REMOVE)
(RET- RETAIN)
(5- RETAIN 5 YEARS)
(10- RETAIN 10 YEARS)
(20- RETAIN 20 YEARS)

EXAMPLE: 1281 Evi N RET 10

DRAFT FOR APPROVAL

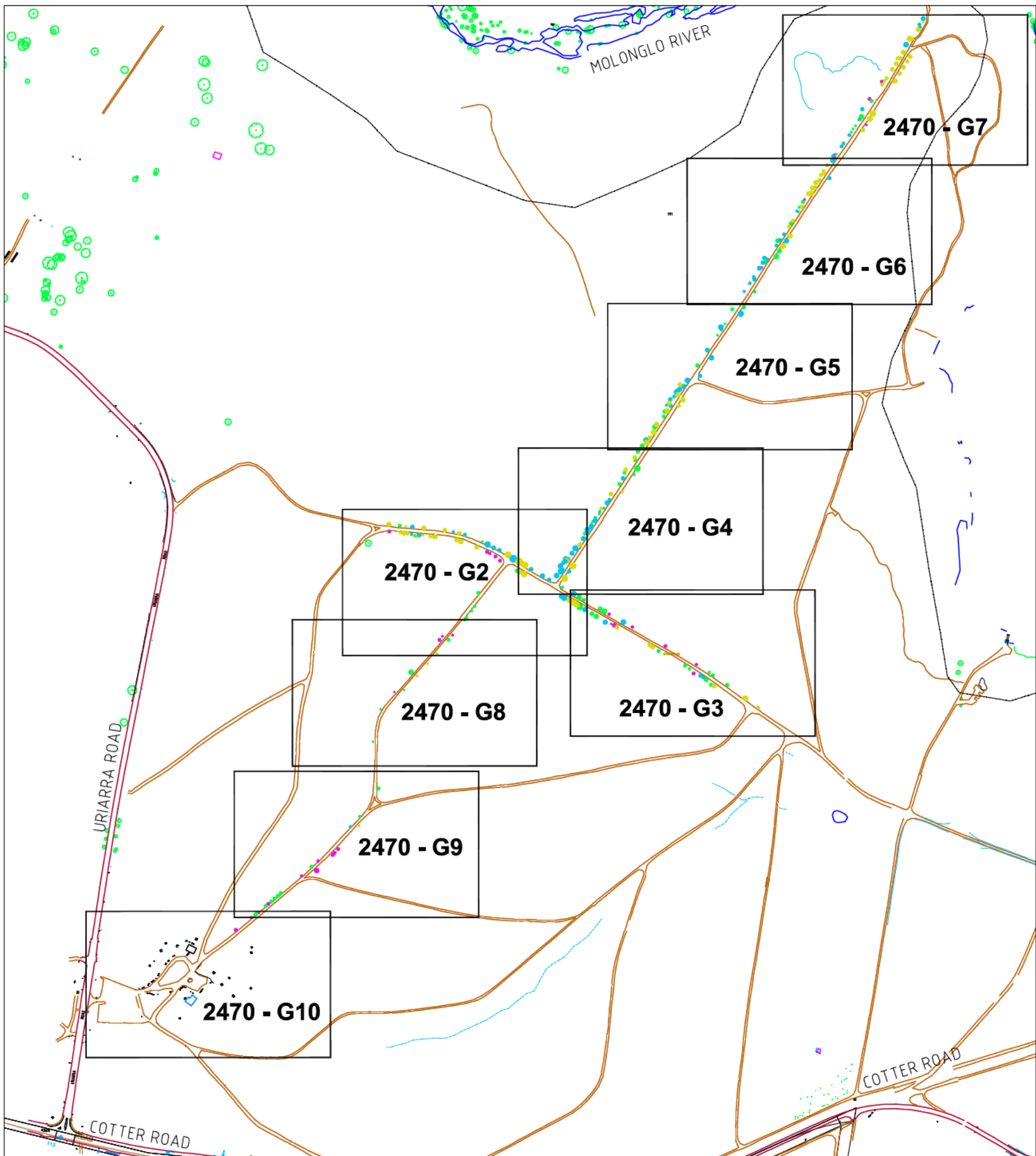

NO.	DESIGN	DRAWN	CHECKED	VER'D	DATE	AMENDMENT / ISSUE
A	-	AM	PB	6	04/02/10	TREE RETENTION/REMOVAL STRATEGY FOR APPROVAL

NOTES
DRAWINGS TO BE READ IN CONJUNCTION WITH THE INFORMATION CONTAINED IN THE ACCOMPANYING VEGETATION ASSESSMENT REPORT.
TREE LOCATIONS BASED ON SURVEY SUPPLIED BY THE CLIENT.
DO NOT SCALE FROM DRAWINGS.

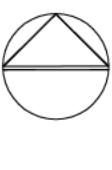

Project
MOLONGLO
COOMBS & WRIGHT
TREE RETENTION PLAN
Client
LAND DEVELOPMENT AGENCY

Drawing Title TREE RETENTION PLAN		
Scale 1:500 @ A1	Plot Date	Sheet No.
Drg. No. 2470B - G1 A		1

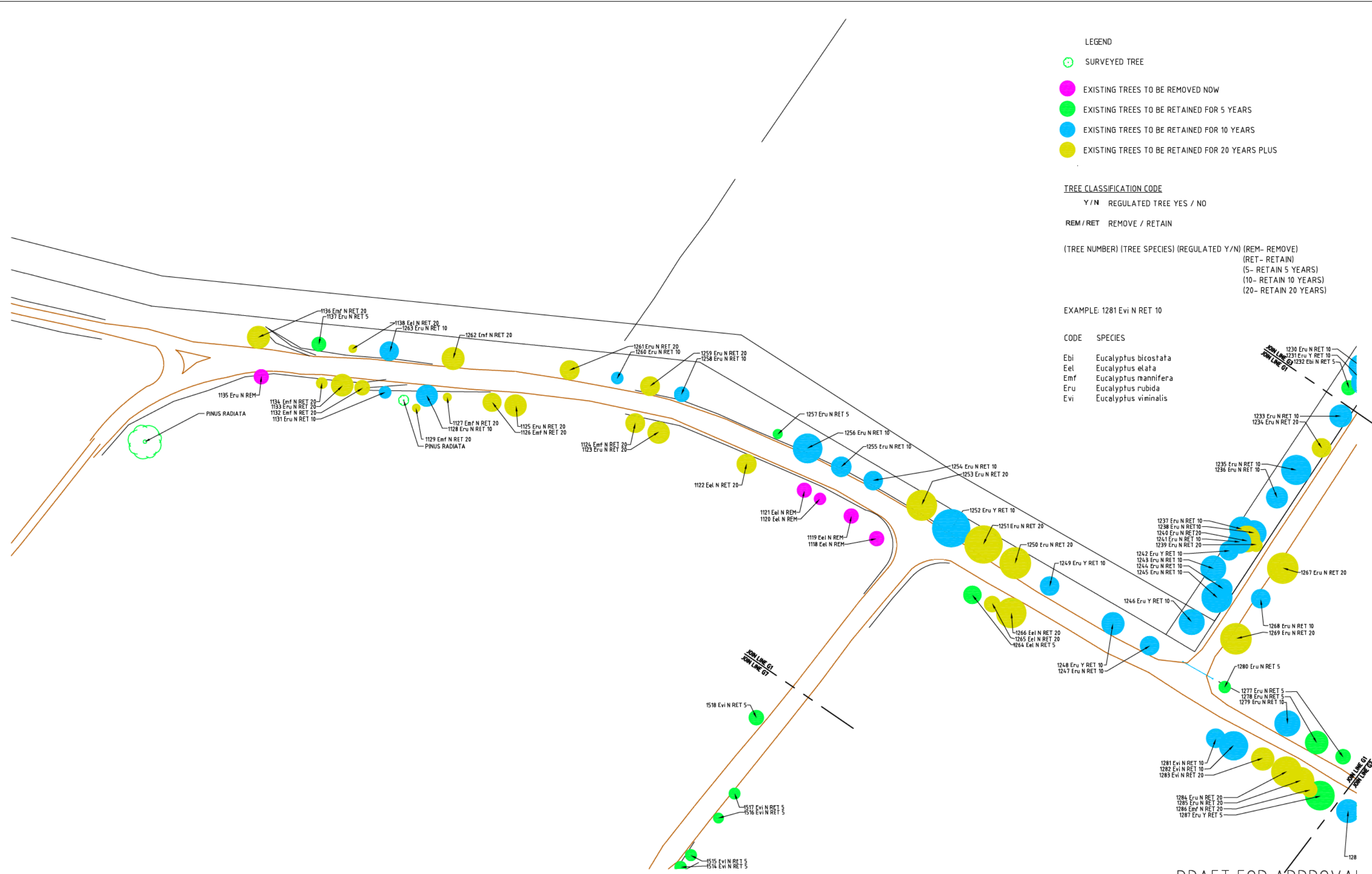

LEGEND

- SURVEYED TREE
- EXISTING TREES TO BE REMOVED NOW
- EXISTING TREES TO BE RETAINED FOR 5 YEARS
- EXISTING TREES TO BE RETAINED FOR 10 YEARS
- EXISTING TREES TO BE RETAINED FOR 20 YEARS PLUS

TREE CLASSIFICATION CODE

Y/N REGULATED TREE YES / NO

REM/RET REMOVE / RETAIN

(TREE NUMBER) (TREE SPECIES) (REGULATED Y/N) (REM- REMOVE)
 (RET- RETAIN)
 (5- RETAIN 5 YEARS)
 (10- RETAIN 10 YEARS)
 (20- RETAIN 20 YEARS)

EXAMPLE: 1281 Evi N RET 10

CODE SPECIES

Ebi Eucalyptus bicostata
 Eel Eucalyptus elata
 Emf Eucalyptus mannifera
 Eru Eucalyptus rubida
 Evi Eucalyptus viminalis

DRAFT FOR APPROVAL

A	-	AM	PB	6	04/02/10	TREE RETENTION/REMOVAL STRATEGY FOR APPROVAL
NO.	DESIGN	DRAWN	CHECKED	VER'D	DATE	AMENDMENT / ISSUE

NOTES

DRAWINGS TO BE READ IN CONJUNCTION WITH THE INFORMATION CONTAINED IN THE ACCOMPANYING VEGETATION ASSESSMENT REPORT.

TREE LOCATIONS BASED ON SURVEY SUPPLIED BY THE CLIENT.

DO NOT SCALE FROM DRAWING.

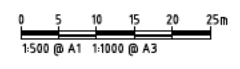

Project
MOLONGLO
COOMBS & WRIGHT
TREE RETENTION PLAN

Client
LAND DEVELOPMENT AGENCY

Drawing Title TREE RETENTION PLAN		
Scale 1:500 @ A1	Plot Date	Sheet No.
Drg. No. 2470B- G2 A		2

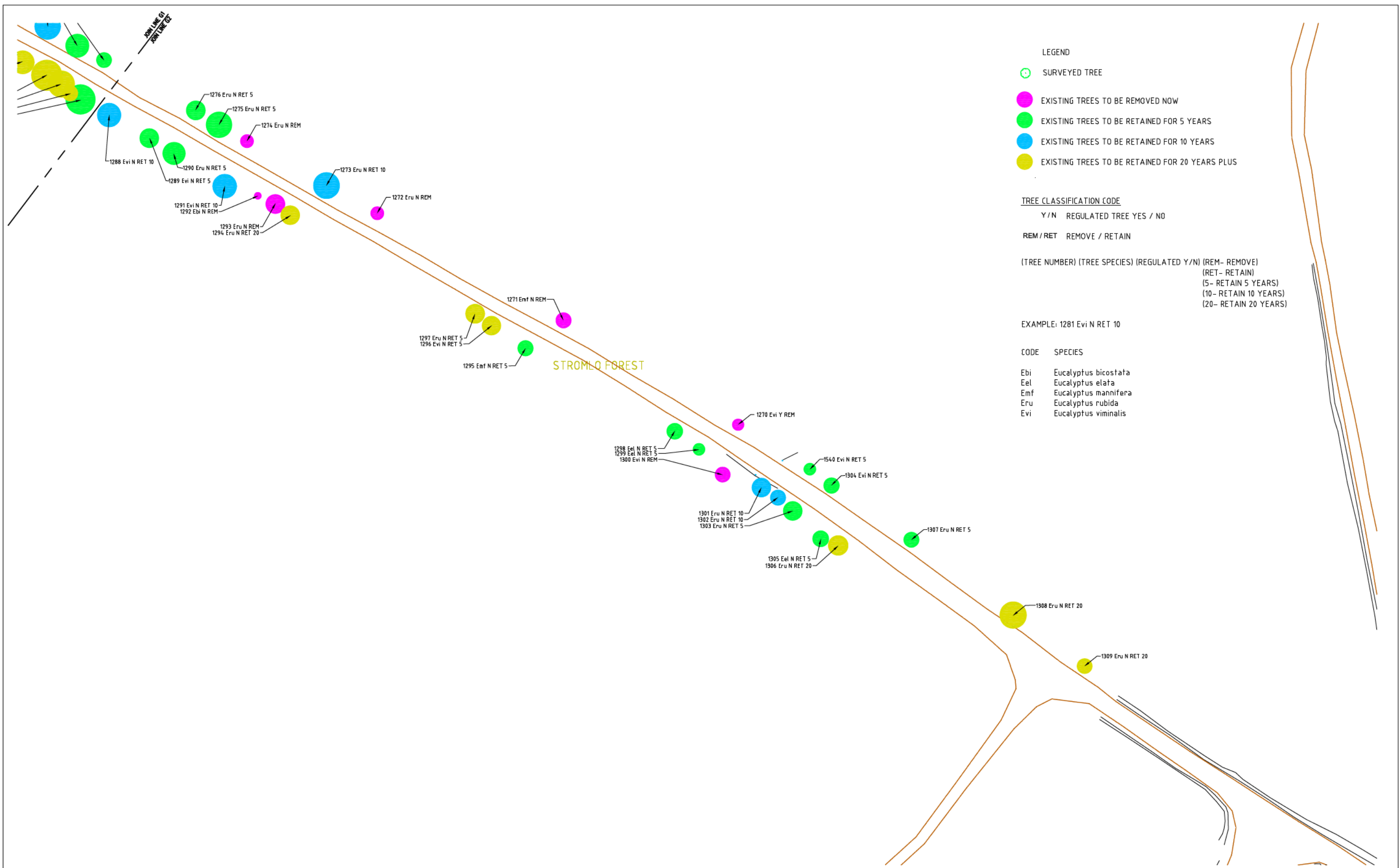

LEGEND

- SURVEYED TREE
- EXISTING TREES TO BE REMOVED NOW
- EXISTING TREES TO BE RETAINED FOR 5 YEARS
- EXISTING TREES TO BE RETAINED FOR 10 YEARS
- EXISTING TREES TO BE RETAINED FOR 20 YEARS PLUS

TREE CLASSIFICATION CODE

Y/N REGULATED TREE YES / NO

REM / RET REMOVE / RETAIN

(TREE NUMBER) (TREE SPECIES) (REGULATED Y/N) (REM- REMOVE)
 (RET- RETAIN)
 (5- RETAIN 5 YEARS)
 (10- RETAIN 10 YEARS)
 (20- RETAIN 20 YEARS)

EXAMPLE: 1281 Evi N RET 10

CODE SPECIES

Ebi Eucalyptus bicostata
 Eel Eucalyptus elata
 Emf Eucalyptus mannifera
 Eru Eucalyptus rubida
 Evi Eucalyptus viminalis

DRAFT FOR APPROVAL

A	-	AM	PB	04/02/10	TREE RETENTION/REMOVAL STRATEGY FOR APPROVAL	
NO.	DESIGN	DRAWN	CHECKED	VER'D	DATE	AMENDMENT / ISSUE

NOTES

DRAWINGS TO BE READ IN CONJUNCTION WITH THE INFORMATION CONTAINED IN THE ACCOMPANYING VEGETATION ASSESSMENT REPORT.

TREE LOCATIONS BASED ON SURVEY SUPPLIED BY THE CLIENT.

DO NOT SCALE FROM DRAWING.

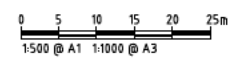

Project
 MOLONGLO
 COOMBS & WRIGHT
 TREE RETENTION PLAN
 Client
 LAND DEVELOPMENT AGENCY

Drawing Title TREE RETENTION PLAN		
Scale 1:500 @ A1	Plot Date	Sheet No.
Drg. No. 2470B-G3 A		3

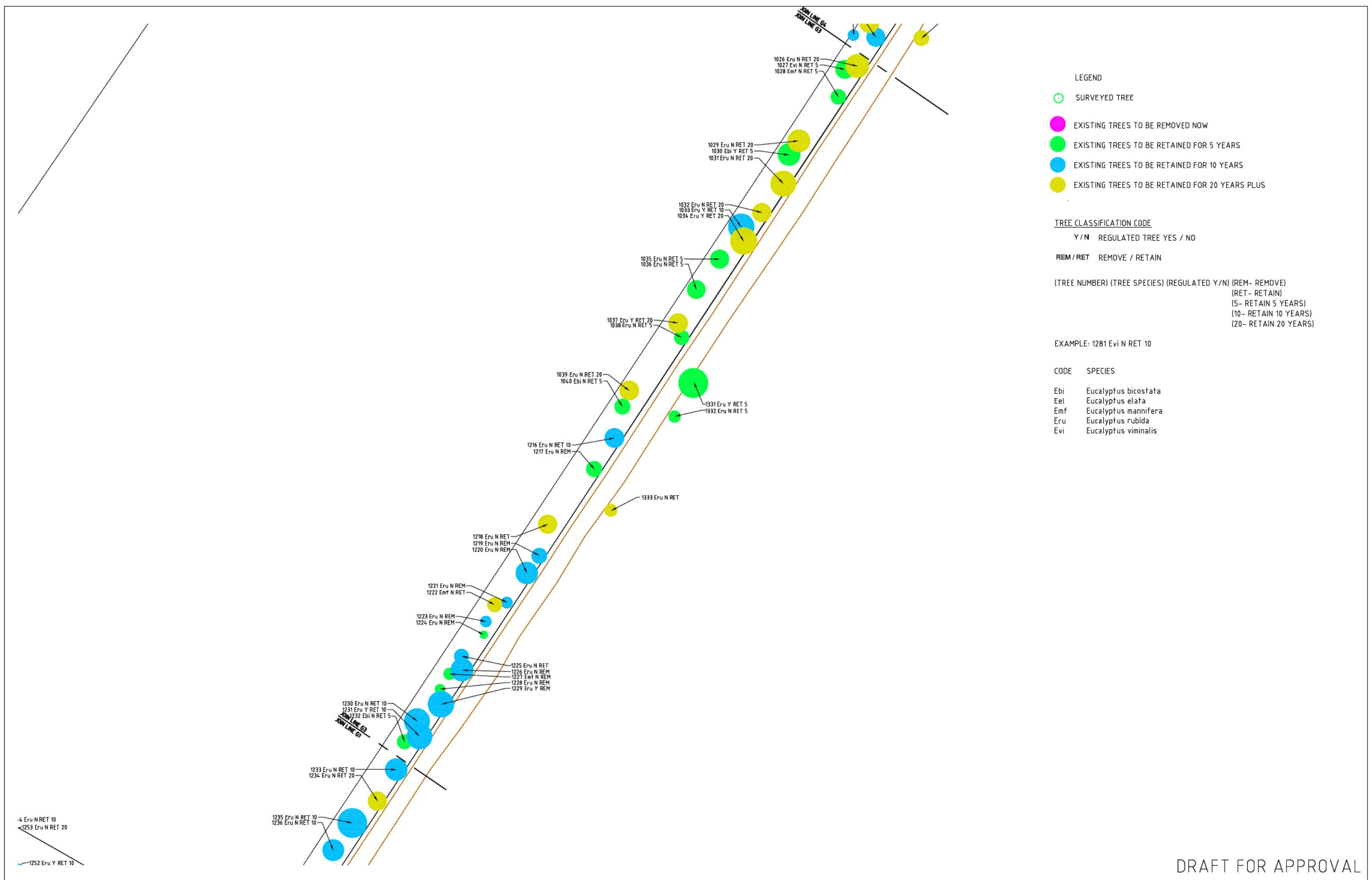

LEGEND

- SURVEYED TREE
- EXISTING TREES TO BE REMOVED NOW
- EXISTING TREES TO BE RETAINED FOR 5 YEARS
- EXISTING TREES TO BE RETAINED FOR 10 YEARS
- EXISTING TREES TO BE RETAINED FOR 20 YEARS PLUS

TREE CLASSIFICATION CODE

Y/N REGULATED TREE YES / NO

REM/RET REMOVE / RETAIN

(TREE NUMBER) (TREE SPECIES) (REGULATED Y/N) (REM- REMOVE)
 (RET- RETAIN)
 (5- RETAIN 5 YEARS)
 (10- RETAIN 10 YEARS)
 (20- RETAIN 20 YEARS)

EXAMPLE: 1281 Evi N RET 10

CODE SPECIES

Ebi Eucalyptus bicostata
 Eel Eucalyptus elata
 Emf Eucalyptus mannifera
 Eru Eucalyptus rubida
 Evi Eucalyptus viminalis

DRAFT FOR APPROVAL

A		AM		PB		04/02/10		TREE RETENTION/REMOVAL STRATEGY FOR APPROVAL	
NO. DESIGN		DRAWN		CHECKED		VER'D		DATE	
AMENDMENT / ISSUE									

<p>NOTES</p> <p>DRAWINGS TO BE READ IN CONJUNCTION WITH THE INFORMATION CONTAINED IN THE ACCOMPANYING VEGETATION ASSESSMENT REPORT.</p> <p>TREE LOCATIONS BASED ON SURVEY SUPPLIED BY THE CLIENT.</p> <p>DO NOT SCALE FROM DRAWINGS.</p>		<p>0 5 10 15 20 25m</p> <p>1:500 @ A1 1:1000 @ A3</p>				<p>Deakin Chambers 14 Hannah Place Deakin ACT 2600</p> <p>Tel. 02 62851955 Fax 02 62816668 dsb@dsbla.com.au</p>		<p>Project MOLONGLO COOMBS & WRIGHT TREE RETENTION PLAN</p> <p>Client LAND DEVELOPMENT AGENCY</p>		<p>Drawing Title TREE RETENTION PLAN</p> <table border="1"> <tr> <td>Scale 1:500 @ A1</td> <td>Plot Date</td> <td>Sheet No.</td> </tr> <tr> <td>Drg. No. 2470-G4 A</td> <td></td> <td>4</td> </tr> </table>		Scale 1:500 @ A1	Plot Date	Sheet No.	Drg. No. 2470-G4 A		4
Scale 1:500 @ A1	Plot Date	Sheet No.															
Drg. No. 2470-G4 A		4															

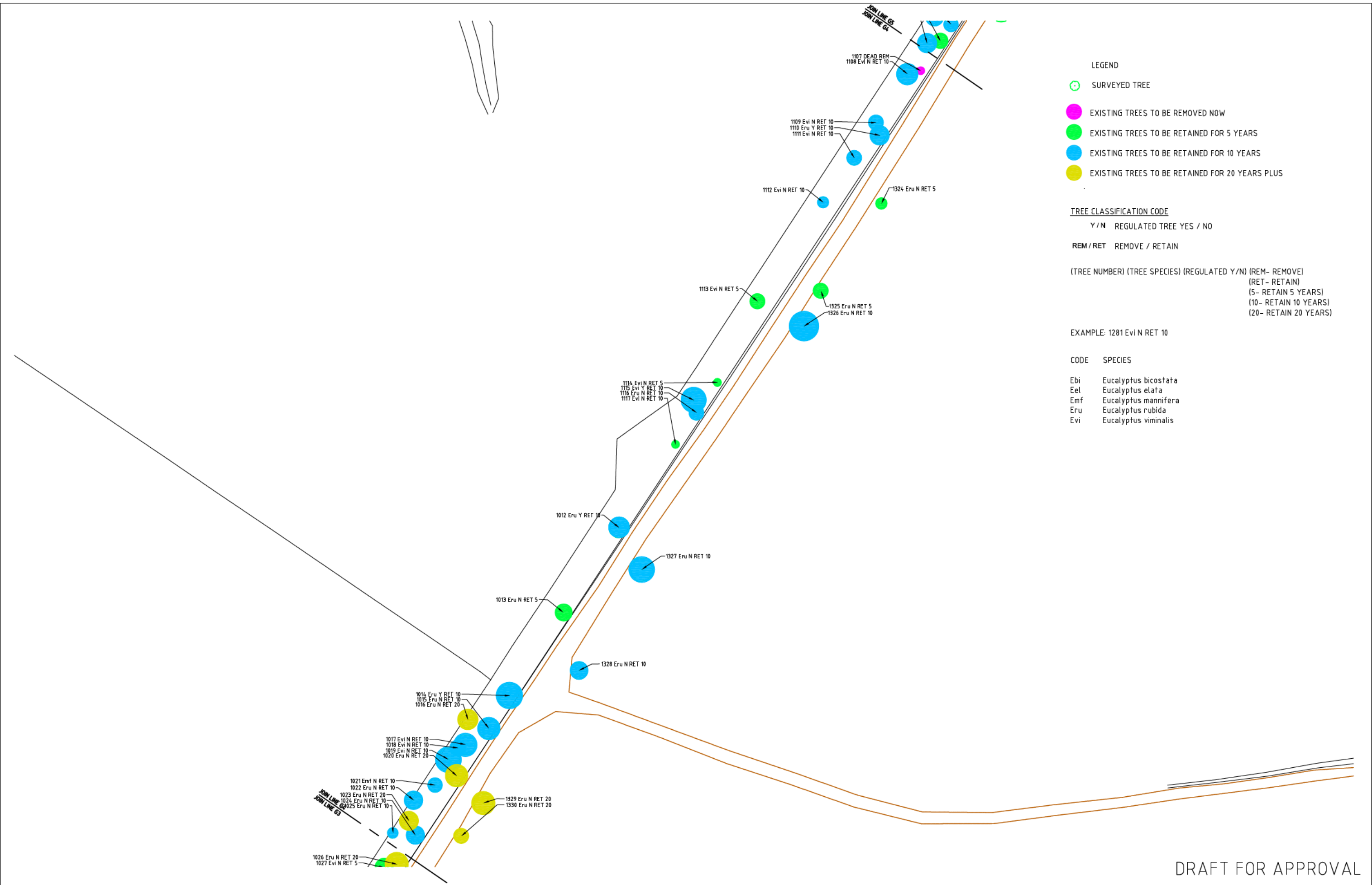

LEGEND

- SURVEYED TREE
- EXISTING TREES TO BE REMOVED NOW
- EXISTING TREES TO BE RETAINED FOR 5 YEARS
- EXISTING TREES TO BE RETAINED FOR 10 YEARS
- EXISTING TREES TO BE RETAINED FOR 20 YEARS PLUS

TREE CLASSIFICATION CODE

Y/N REGULATED TREE YES / NO

REM / RET REMOVE / RETAIN

(TREE NUMBER) (TREE SPECIES) (REGULATED Y/N) (REM- REMOVE)
 (RET- RETAIN)
 (5- RETAIN 5 YEARS)
 (10- RETAIN 10 YEARS)
 (20- RETAIN 20 YEARS)

EXAMPLE: 1281 Evi N RET 10

CODE SPECIES

Ebi Eucalyptus bicostata
 Eel Eucalyptus elata
 Emf Eucalyptus mannifera
 Eru Eucalyptus rubida
 Evi Eucalyptus viminalis

DRAFT FOR APPROVAL

A	-	AM	PB	6	04/02/10	TREE RETENTION/REMOVAL STRATEGY FOR APPROVAL
NO.	DESIGN	DRAWN	CHECKED	VER'D	DATE	AMENDMENT / ISSUE

NOTES

DRAWINGS TO BE READ IN CONJUNCTION WITH THE INFORMATION CONTAINED IN THE ACCOMPANYING VEGETATION ASSESSMENT REPORT.

TREE LOCATIONS BASED ON SURVEY SUPPLIED BY THE CLIENT.

DO NOT SCALE FROM DRAWINGS.

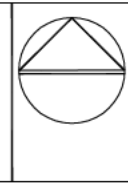
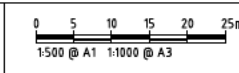

Project
 MOLONGLO
 COOMBS & WRIGHT
 TREE RETENTION PLAN
 Client
 LAND DEVELOPMENT AGENCY

Drawing Title TREE RETENTION PLAN		
Scale 1:500 @ A1	Plot Date	Sheet No.
Drg. No. 2470B-G5 A		5



LEGEND

- SURVEYED TREE
- EXISTING TREES TO BE REMOVED NOW
- EXISTING TREES TO BE RETAINED FOR 5 YEARS
- EXISTING TREES TO BE RETAINED FOR 10 YEARS
- EXISTING TREES TO BE RETAINED FOR 20 YEARS PLUS

TREE CLASSIFICATION CODE

Y/N REGULATED TREE YES / NO

REM/RET REMOVE / RETAIN

(TREE NUMBER) (TREE SPECIES) (REGULATED Y/N) (REM- REMOVE)
 (RET- RETAIN)
 (5- RETAIN 5 YEARS)
 (10- RETAIN 10 YEARS)
 (20- RETAIN 20 YEARS)

EXAMPLE: 1281 Evi N RET 10

CODE SPECIES

Ebi Eucalyptus bicostata
 Eel Eucalyptus elata
 Emf Eucalyptus mannifera
 Eru Eucalyptus rubida
 Evi Eucalyptus viminalis

DRAFT FOR APPROVAL

NO.	DESIGN	DRAWN	CHECKED	VER'D	DATE	AMENDMENT / ISSUE
A	-	AM	PB	6	04/02/10	TREE RETENTION/REMOVAL STRATEGY FOR APPROVAL

NOTES

DRAWINGS TO BE READ IN CONJUNCTION WITH THE INFORMATION CONTAINED IN THE ACCOMPANYING VEGETATION ASSESSMENT REPORT.

TREE LOCATIONS BASED ON SURVEY SUPPLIED BY THE CLIENT.

DO NOT SCALE FROM DRAWINGS.

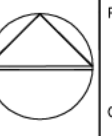
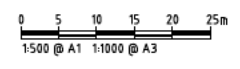

Project
 MOLONGLO
 COOMBS & WRIGHT
 TREE RETENTION PLAN

Client
 LAND DEVELOPMENT AGENCY

Drawing Title TREE RETENTION PLAN		
Scale 1:500 @ A1	Plot Date	Sheet No.
Drg. No. 2470B-G6 A		6

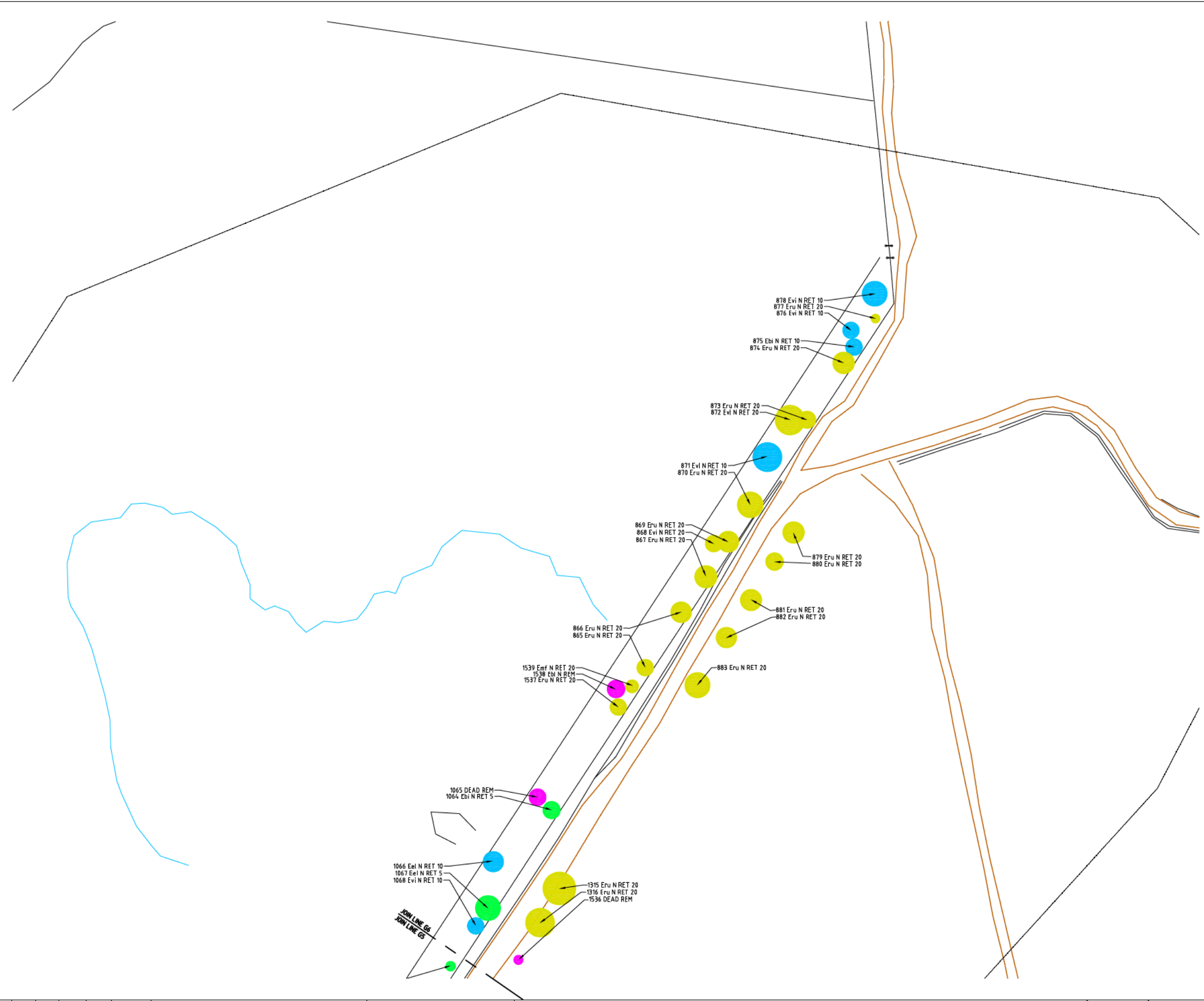

LEGEND

- SURVEYED TREE
- EXISTING TREES TO BE REMOVED NOW
- EXISTING TREES TO BE RETAINED FOR 5 YEARS
- EXISTING TREES TO BE RETAINED FOR 10 YEARS
- EXISTING TREES TO BE RETAINED FOR 20 YEARS PLUS

TREE CLASSIFICATION CODE

Y/N REGULATED TREE YES / NO

REM / RET REMOVE / RETAIN

(TREE NUMBER) (TREE SPECIES) (REGULATED Y/N) (REM- REMOVE) (RET- RETAIN)

(5- RETAIN 5 YEARS)
(10- RETAIN 10 YEARS)
(20- RETAIN 20 YEARS)

EXAMPLE: 1281 Evi N RET 10

CODE SPECIES

Ebi Eucalyptus bicostata
Eel Eucalyptus elata
Emf Eucalyptus mannifera
Eru Eucalyptus rubida
Evi Eucalyptus viminalis

DRAFT FOR APPROVAL

NO.	DESIGN	DRAWN	CHECKED	VER'D	DATE	AMENDMENT / ISSUE
A	-	AM	PB	6	04/02/10	TREE RETENTION/REMOVAL STRATEGY FOR APPROVAL

NOTES

DRAWINGS TO BE READ IN CONJUNCTION WITH THE INFORMATION CONTAINED IN THE ACCOMPANYING VEGETATION ASSESSMENT REPORT.

TREE LOCATIONS BASED ON SURVEY SUPPLIED BY THE CLIENT.

DO NOT SCALE FROM DRAWINGS.

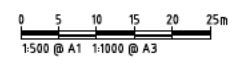

Project
MOLONGLO
COOMBS & WRIGHT
TREE RETENTION PLAN
Client
LAND DEVELOPMENT AGENCY

Drawing Title TREE RETENTION PLAN		
Scale 1:500 @ A1	Plot Date	Sheet No.
Drg. No. 2470B-G7 A		7

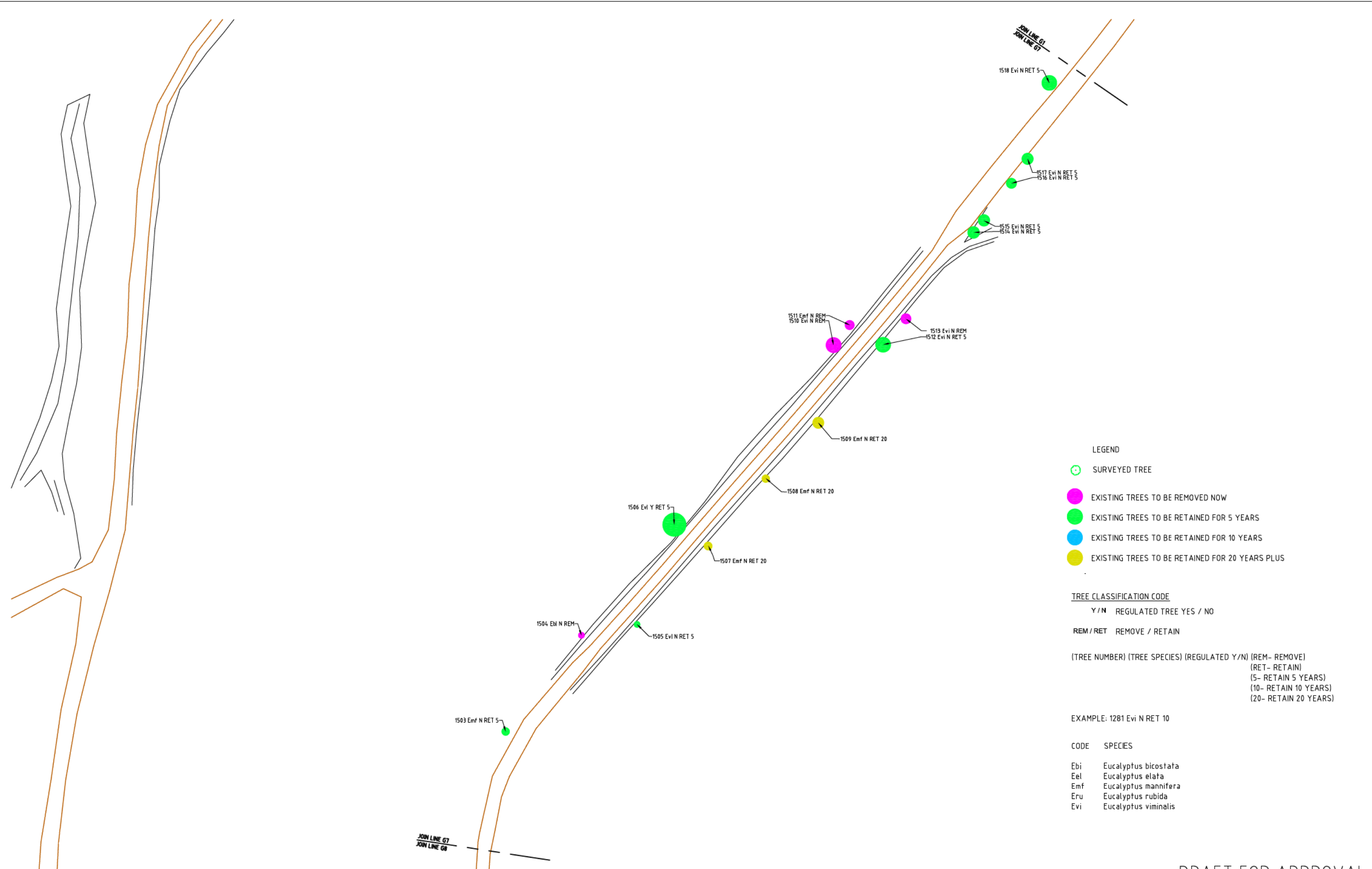

LEGEND

- SURVEYED TREE
- EXISTING TREES TO BE REMOVED NOW
- EXISTING TREES TO BE RETAINED FOR 5 YEARS
- EXISTING TREES TO BE RETAINED FOR 10 YEARS
- EXISTING TREES TO BE RETAINED FOR 20 YEARS PLUS

TREE CLASSIFICATION CODE

Y / N REGULATED TREE YES / NO

REM / RET REMOVE / RETAIN

(TREE NUMBER) (TREE SPECIES) (REGULATED Y/N) (REM- REMOVE)
 (RET- RETAIN)
 (5- RETAIN 5 YEARS)
 (10- RETAIN 10 YEARS)
 (20- RETAIN 20 YEARS)

EXAMPLE: 1281 Evi N RET 10

CODE SPECIES

Ebi Eucalyptus bicostata
 Eel Eucalyptus elata
 Emf Eucalyptus mannifera
 Eru Eucalyptus rubida
 Evi Eucalyptus viminalis

DRAFT FOR APPROVAL

A	-	AM	PB	6	04/02/10	TREE RETENTION/REMOVAL STRATEGY FOR APPROVAL
NO.	DESIGN	DRAWN	CHECKED	VER'D	DATE	AMENDMENT / ISSUE

NOTES

DRAWINGS TO BE READ IN CONJUNCTION WITH THE INFORMATION CONTAINED IN THE ACCOMPANYING VEGETATION ASSESSMENT REPORT.

TREE LOCATIONS BASED ON SURVEY SUPPLIED BY THE CLIENT.

DO NOT SCALE FROM DRAWINGS.

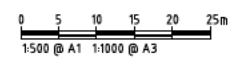

Project
 MOLONGLO
 COOMBS & WRIGHT
 TREE RETENTION PLAN

Client
 LAND DEVELOPMENT AGENCY

Drawing Title TREE REMOVAL PLAN		
Scale 1:500 @ A1	Plot Date	Sheet No.
Drg. No. 2470B-G8 A		8

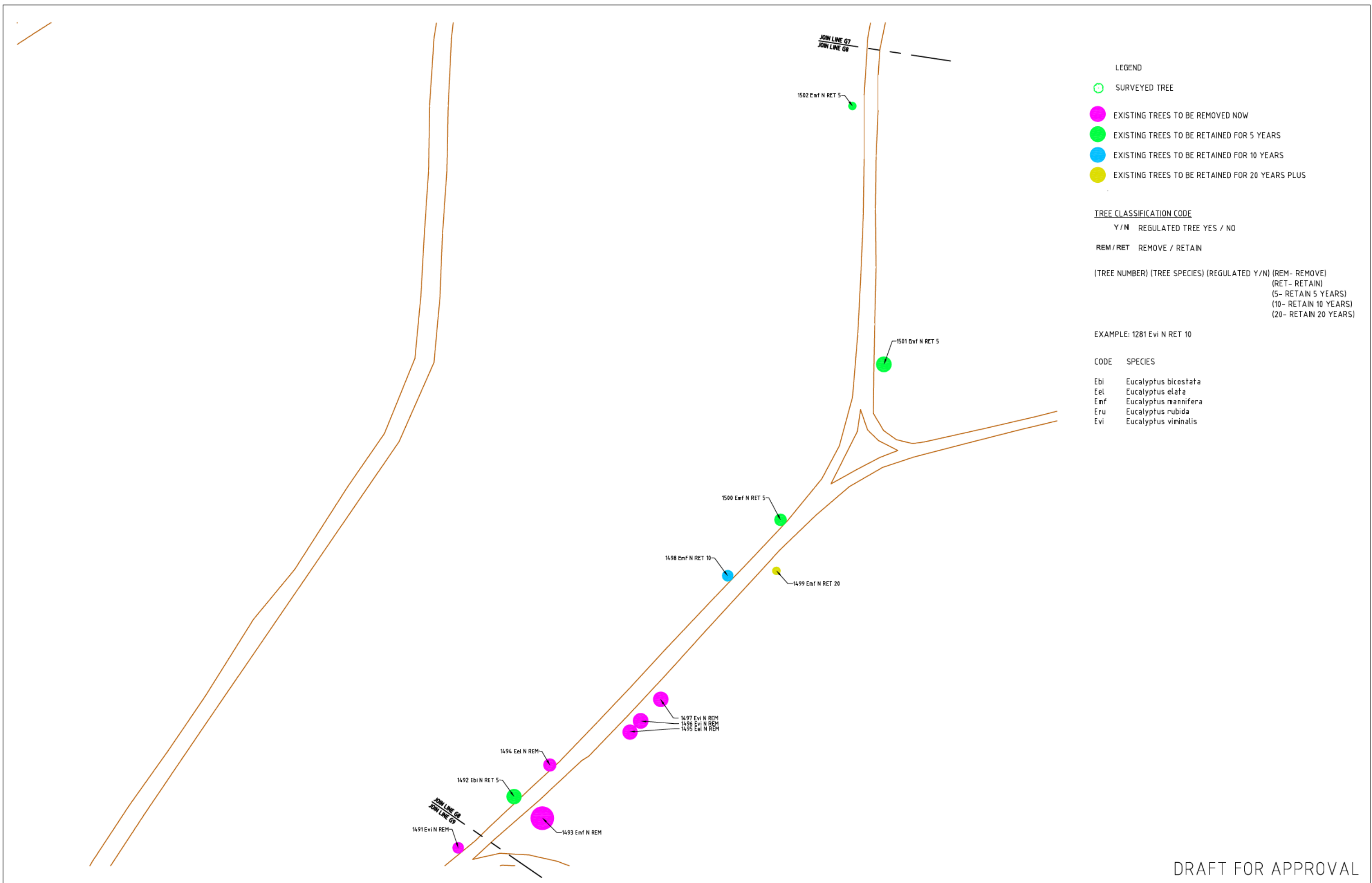

DRAFT FOR APPROVAL

NO.	DESIGN	DRAWN	CHECKED	VER'D	DATE	AMENDMENT / ISSUE
A	-	AM	PB	6	04/02/10	TREE RETENTION/REMOVAL STRATEGY FOR APPROVAL

NOTES

DRAWINGS TO BE READ IN CONJUNCTION WITH THE INFORMATION CONTAINED IN THE ACCOMPANYING VEGETATION ASSESSMENT REPORT.

TREE LOCATIONS BASED ON SURVEY SUPPLIED BY THE CLIENT.

DO NOT SCALE FROM DRAWINGS.

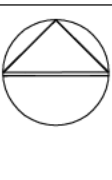
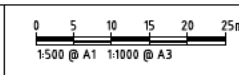

Project
 MOLONGLO
 COOMBS & WRIGHT
 TREE RETENTION PLAN
 Client
 LAND DEVELOPMENT AGENCY

Drawing Title TREE RETENTION PLAN		
Scale 1:500 @ A1	Plot Date	Sheet No.
Drg. No. 2470B-G9 A		9

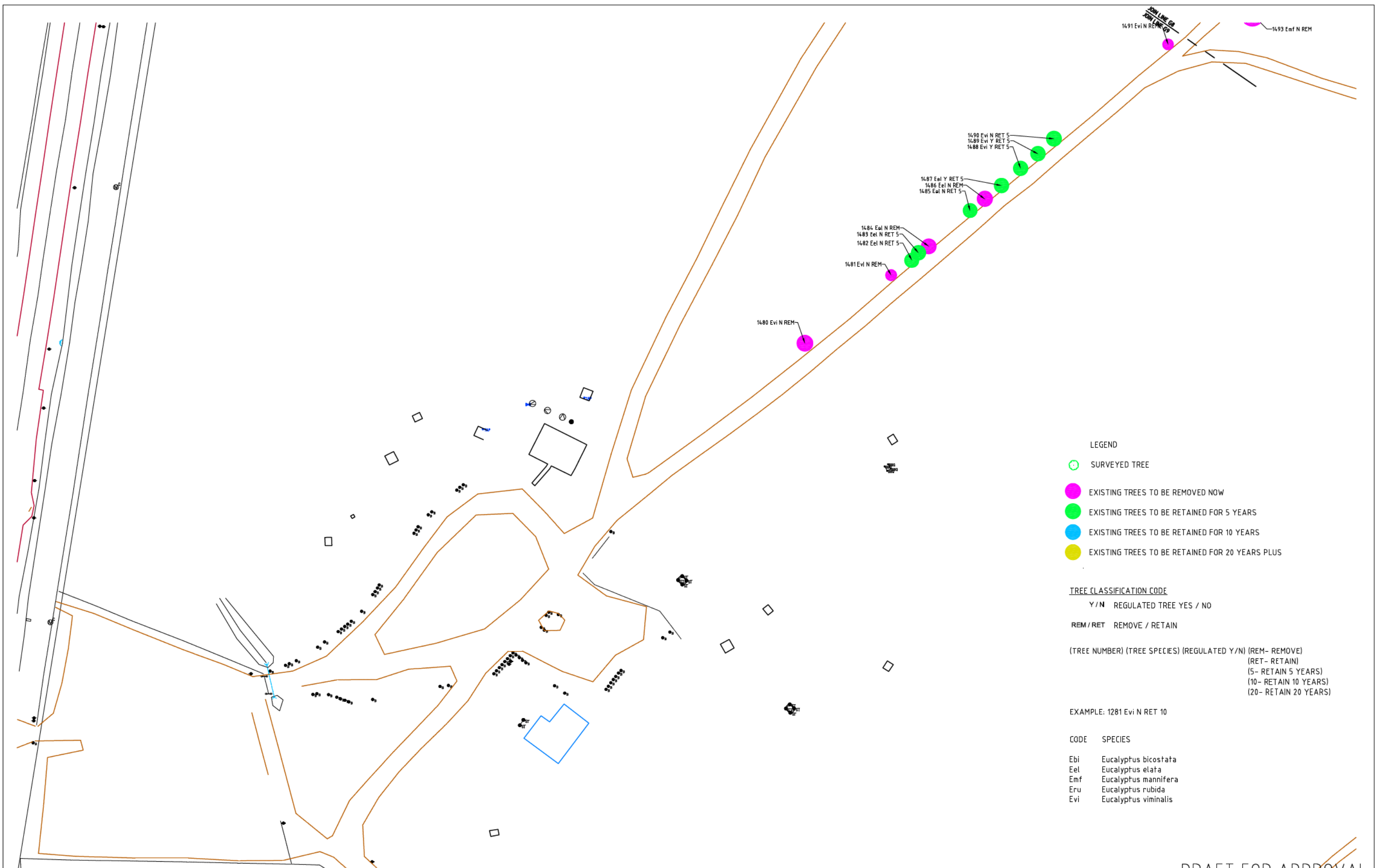

DRAFT FOR APPROVAL

NO.	DESIGN	DRAWN	CHECKED	VER'D	DATE	AMENDMENT / ISSUE
A	-	AM	PB	6	04/02/10	TREE RETENTION/REMOVAL STRATEGY FOR APPROVAL

NOTES

DRAWINGS TO BE READ IN CONJUNCTION WITH THE INFORMATION CONTAINED IN THE ACCOMPANYING VEGETATION ASSESSMENT REPORT.

TREE LOCATIONS BASED ON SURVEY SUPPLIED BY THE CLIENT.

DO NOT SCALE FROM DRAWING.

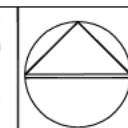
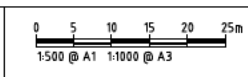

Project
 MOLONGLO
 COOMBS & WRIGHT
 TREE RETENTION PLAN

Client
 LAND DEVELOPMENT AGENCY

Drawing Title		
TREE RETENTION PLAN		
Scale 1:500 @ A1	Plot Date	Sheet No.
Drg. No. 2470B-G10 A		10

Appendix F
Consultation Material