

MONCRIEFF EAST ESTATE

FOR CONSTRUCTION
COMMUNITY TITLE BLOCKS



NOTES

- ALL WORK MUST BE CARRIED OUT IN CONFORMITY WITH THE BUILDING CODE OF AUSTRALIA, WATER AND SEWERAGE ACT 2000 AND THE WATER AND SEWERAGE REGULATIONS 2001. THE PLUMBING NOTES 1 THROUGH TO 24 AND AS 3500, THE ARCHITECTURAL PLANS AND SPECIFICATIONS. POSITION OF BRANCH MUST BE LOCATED BEFORE ANY WORK IS COMMENCED.
- PIPE WORK TO BE LAID IN ACCORDANCE WITH AS 1254-2010, 1260-2009, 1432-2004, 1477-2006, 1646-2000, 2032-2006, 2033-1980, 2053-2001, 2129-2000, 2280-2004, 2566-1998 AS CURRENT.
- ALL WORKS HEREIN SHALL BE DONE IN ACCORDANCE WITH THE PLANS AND SPECIFICATIONS.
- ALL INSTALLATION THEREIN SHALL BE DONE TO THE BEST PRACTICE OF THE PROFESSION.
- COORDINATE THE DRAWING WITH OTHER RELATED DRAWINGS AND SPECIFICATIONS. THE OWNER'S AUTHORIZED REPRESENTATIVE SHALL BE NOTIFIED IMMEDIATELY OF ANY DISCREPANCY FOUND THEREIN.
- IT IS NOT INTENDED THAT THE DRAWINGS SHALL SHOW EVERY PIPE, FITTINGS, VALVE AND APPLIANCE. ALL SUCH ITEMS WHETHER SPECIFICALLY MENTIONED OR NOT, OR INDICATED ON THE DRAWINGS SHALL BE FURNISHED AND INSTALLED. IF NECESSARY, TO COMPLETE THE SYSTEM IN ACCORDANCE WITH THE BEST PRACTICE OF THE PLUMBING TRADE AND TO THE SATISFACTION OF THE OWNER'S AUTHORIZED REPRESENTATIVE.
- PROPOSED SANITARY UTILITIES SHALL CONFORM TO THE ACTUAL LOCATION, DEPTH AND INVERT LEVEL OF ALL EXISTING PIPES AND STRUCTURES SHALL BE VERIFIED BY THE CONTRACTOR AT JOB SITE.
- THE DRAWINGS AND SPECIFICATIONS ARE COMPLEMENTARY SUCH THAT WHAT IS NOTED IN ONE, ALTHOUGH NOT INDICATED OR MENTIONED IN THE OTHER SHALL BE CONSIDERED CONTAINED IN ALL.
- HOSE COCK PROVIDED AT GARBAGE ENCLOSURE. HOSE COCK TO BE PROVIDED TO FRONT AND REAR OF TOWNHOUSES AND GROUND FLOOR POINTS.
- PLUMBER TO CHECK DESIGN DURING PRICING AND NOTIFY ANY CONCERN.
- INSPECTION SHAFT AT PROPERTY LINE IS TO BE RAISED TO GROUND LEVEL IN ACCORDANCE WITH PLUMBING NOTE 3.
- DRAINS TO BE REMOVED SHOWN CROSSED IN RED AND ARE TO BE SEALED AT ALL ENDS AND JUNCTION.
- OVERFLOW RELIEF GULLY (ORG): TOP TO BE MINIMUM 150mm BELOW LOWEST FITTING WITH A FURTHER 75mm FROM TOP TO UNPAVED GROUND SURFACE OR WHERE IN A PAVED SURFACE AT A LEVEL SO AS TO PREVENT PONDING AND INGRESS OF WATER.
- SEWER VENT PIPES TO BE LOCATED IN WALL CAVITY, OR DUCTS WHERE AVAILABLE. ALL PIPES PENETRATING THRU WALLS, CEILING, FLOORS SHALL BE ACOUSTICALLY SEALED WITH STC FIRE RATED MATERIALS.
- THE LOCATION OF ALL FIXTURES ARE TO BE CHECKED WITH THE BUILDER/SITE MANAGER PRIOR TO PIPES OR DRAINS BEING INSTALLED.
- PIPES FOR FIXTURE CONNECTIONS TO BE FINISHED 100mm ABOVE FLOOR SLAB LEVEL PRIOR TO POURING OF SLAB AND ADJUSTED TO SUIT FIXTURE CONNECTION AFTER SLAB CURED.
- DEPTHS AND LOCATIONS OF CONNECTION POINTS ARE TO BE CHECKED PRIOR TO WORK COMMENCING.
- ANY EXISTING UTILITIES EQUIPMENT, PIPING OR PAVED AREAS AFFECTED DURING CONSTRUCTION SHALL BE RESTORED TO ORIGINAL CONDITION AND BE PROPERLY SCHEDULED PRIOR TO ACTUAL WORK AND WITH THE APPROVAL OF THE OWNER'S AUTHORIZED REPRESENTATIVE.
- A PRESSURE REDUCTION OR LIMITING VALVE WILL BE REQUIRED TO BE FITTED ON THE WATER SERVICE LINE FEEDING WATER OUTLET SO THE WATER PRESSURE DOES NOT EXCEED 500kPa AT THE TAP OUTLET.
- PROVIDE THERMOSTATIC MIXING VALVE IN STEEL BOX. LOCATION TO BE COORDINATED WITH THE ARCHITECT.
- ALL PIPE SIZES ARE IN MILLI-METRES AND ALL DIMENSIONS ARE IN METERS UNLESS OTHERWISE SPECIFIED.
- ALL HOT & COLD WATER SUPPLY PIPES TO BE LAID AT CEILING OR WALLS UNLESS SPECIFIED.

MATERIAL SPECIFICATIONS

- SANITARY DRAINAGE & VENT PIPES:**
- SHALL BE UN-PLASTICISED POLYVINYL CHLORIDE (uPVC) IN DWV QUALITY IN ACCORDANCE WITH AS1260.
 - FITTINGS SHALL BE SOLVENT CEMENT JOINTS OF APPROVED EQUAL.
 - CAST-IN BEAM PIPE SHALL BE HIGH DENSITY POLYETHYLENE (HDPE) IN ACCORDANCE WITH AS4401.
 - FITTINGS SHALL BE ELECTRO-FUSION WELD CONNECTION.
- STORMWATER PIPES:**
- SHALL BE UN-PLASTICISED POLYVINYL CHLORIDE (uPVC) IN DWV QUALITY IN ACCORDANCE WITH AS1260.
 - FITTINGS SHALL BE SOLVENT CEMENT JOINTS.
 - CAST-IN BEAM PIPE SHALL BE HIGH DENSITY POLYETHYLENE (HDPE) IN ACCORDANCE WITH AS4401.
 - FITTINGS SHALL BE ELECTRO-FUSION WELD CONNECTION.
- WATER AND GAS SUPPLY PIPES:**
- SHALL BE COPPER TUBE AND FITTINGS IN ACCORDANCE WITH AS1432-2004 TABLE 2 TYPE TUBES THROUGHOUT THE BUILDING.
 - FITTINGS SHALL BE SILVER SOLDER CONNECTION.
- FIRE (HYDRANT & HOSE REEL) PROTECTION PIPES:**
- SHALL BE MEDIUM GRADE GALVANISED STEEL PIPE WITH GROOVED CONNECTION FOR ABOVE GROUND PIPE WORK.
 - SHALL BE POLYETHYLENE PIPE WITH ELECTRO-FUSION WELD CONNECTION FOR BELOW GROUND PIPE WORK.

REFERENCE

AG LINE	AGRICULTURAL DRAIN	GA	GREASE ARRESTOR	SPD	STONEWARE PIPE DRAIN
BT	BUCKET TRAP	GT	GULLY TRAP	SST	SOIL STACK
CIP	CAST IRON PIPE	HC	HOSE COCK	ST	SILT TRAP
CO	CLEAN OUT	HDPE	HIGH DENSITY POLYETHYLENE	SV	SOLENOID VALVE
Cu	COPPER	HWS	HOT WATER SYSTEM	SVP	SOIL VENT PIPE
CW	COLD WATER SERVICE	IG	INSPECTION GRATE	SWMH	STORMWATER MANHOLE
CWR	COLD WATER RISER	IL	INVERT LEVEL	TD	TUNDISH
DICL	DUCTILE IRON CEMENT LINED DOWNPIPE	IO	INSPECTION OPENING	TWP	TRADE WASTE PIPE
DP	DOWNPIPE	IS	INSPECTION SHAFT	TWS	TRADE WASTE STACK
DT	DISCONNECTOR TRAP	OCGD	OPEN CHANNEL GRATED DRAIN	TWV	TRADE WASTE VENT
EC	END CAP	ORG	OVERFLOW RELIEF GULLY	U/B	UNDER BENCH
EJ	EXPANSION JOINT	*ORG	OVERFLOW RELIEF GULLY WITH TAP OVER	UPVC	UNPLASTICISED POLYVINYL CHLORIDE
ET	EDUCT TRAP	POT	PETROL & OIL TRAP	VCP	VITRIFIED CLAY PIPE
FEL	FINISHED FLOOR LEVEL	PP	PROVISIONAL POINT	VJU	VERTICAL JUMP UP
FH	FIRE HYDRANT	PRV	PRESSURE RELIEF VALVE	VP	VENT PIPE
FHR	FIRE HOSE REEL	RV	RELIEF VENT	WM	WATER METER
FS	FIRE SERVICE	SC	STOP COCK	MM	MASTER WATER METER
FW	FLOOR WASTE	SMH	SEWER MANHOLE	FP	FLASH POINT

LEGEND

EXISTING SERVICES	PROPOSED SERVICES
— CW — DOMESTIC WATER (COLD)	— CW — DOMESTIC WATER (COLD)
— HW — DOMESTIC WATER (HOT)	— HW — DOMESTIC WATER (HOT)
— ESL — ELECTRICITY STREET LIGHTING OVERHEAD	— HWR — HOT WATER RETURN
— ESL — ELECTRICITY STREET LIGHTING UNDERGROUND	— FH — FIRE HYDRANT
— E — ELECTRICITY UNDERGROUND	— FHR — FIRE HOSE REEL
— e — ELECTRICITY OVERHEAD	— FS — FIRE SPRINKLER
— T — TELSTRA	— G — GAS
— OPT — OPTUS	— SD — SANITARY DRAINAGE
— TR — TRANSACT	— NP — NON-POTABLE WATER
— AAPT — AAPT	— S — SEWER MAIN
— FH — FIRE HYDRANT	— RM — SEWER RISING MAIN
— FS — FIRE SPRINKLER	— SW — STORMWATER
— G — GAS	— TW — SANITARY (TRADE WASTE)
— SD — SANITARY DRAINAGE/PLUMBING	— VP — SANITARY VENT
— S — SEWER MAIN	— W — WATER MAIN
— SW — STORMWATER	— TeW — TEPID WATER
— W — WATER	— TMV — THERMOSTATIC MIXING VALVE
— VP — SANITARY VENT	x x x x x SERVICE TO BE REMOVED/ABANDONED
— SS — SUB SOIL DRAINAGE	



LOCALITY PLAN
NTS

DRAINAGE PLAN NO. _____

OWNER: LDA
 BLOCK: _____ SECTION: _____
 SUBURB: MONCRIEFF
 ADDRESS: _____

||| SITE

APPROVED BY: _____

No.	AMENDMENT	APPROVED	DATE	DESIGNED BY	DEVELOPMENT TEAM
0	FOR CONSTRUCTION	AN	28.05.15	JP	



APPROVED	JR	DATE	18.03.15
DESIGNED	AN	DATE	18.03.15
DRAWN BY	JP		
CHECKED BY	JP		
DATE FILED	18/03/15 Moncrieff East Estate Building Approval - Community Title Blocks Acad Current Drainage Notes.dwg		
SCALE	AS SHOWN	DRAWN No.	

MONCRIEFF EAST ESTATE BUILDING APPROVAL

DRAWING TITLE		
HYDRAULIC NOTES, LEGEND, ABBREVIATIONS AND LOCALITY PLAN		
PROJECT No.	DRAWING No.	ASBY
4900-BA	001	A

MONCRIEFF EAST ESTATE

FOR CONSTRUCTION
SECTION 43
BLOCKS 1-36

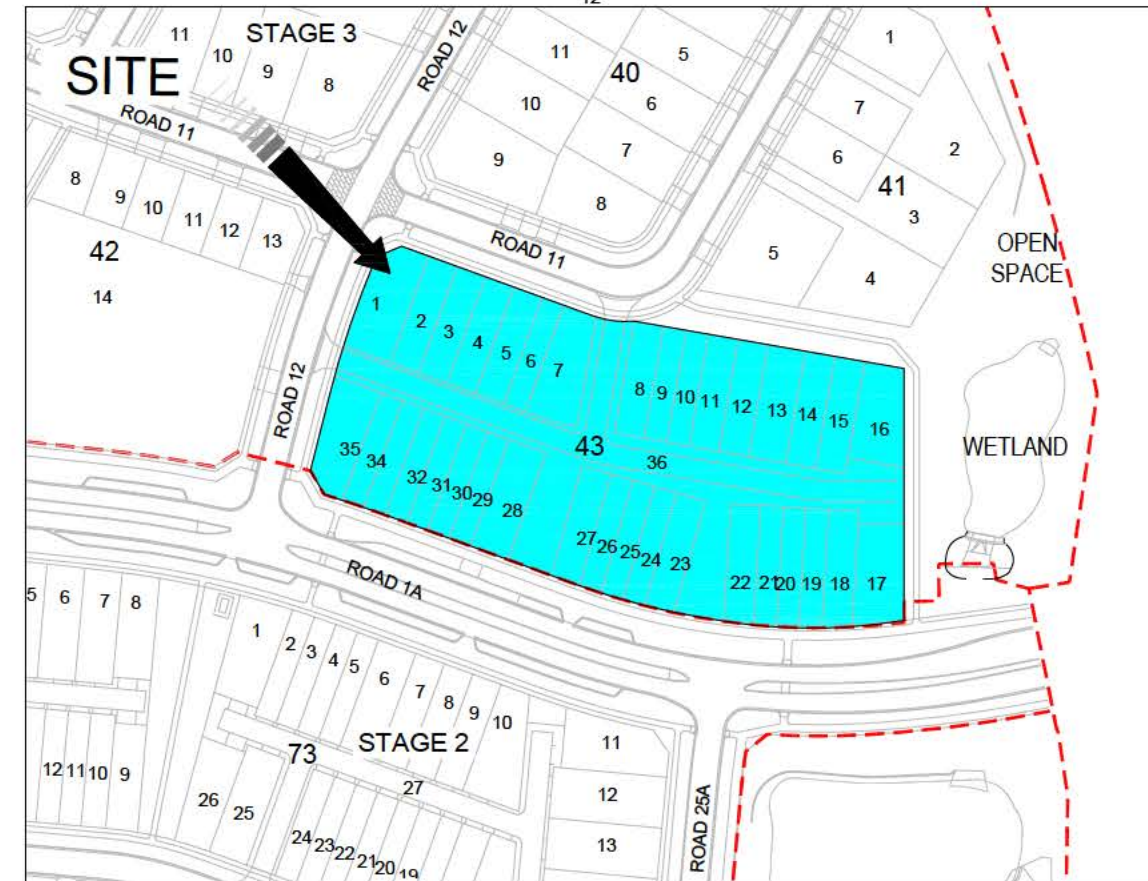

LOCALITY PLAN 



DRAINAGE PLAN NO. _____

OWNER: LDA
 BLOCK: 1-7 SECTION: 43
 SUBURB: MONCRIEFF
 ADDRESS: _____

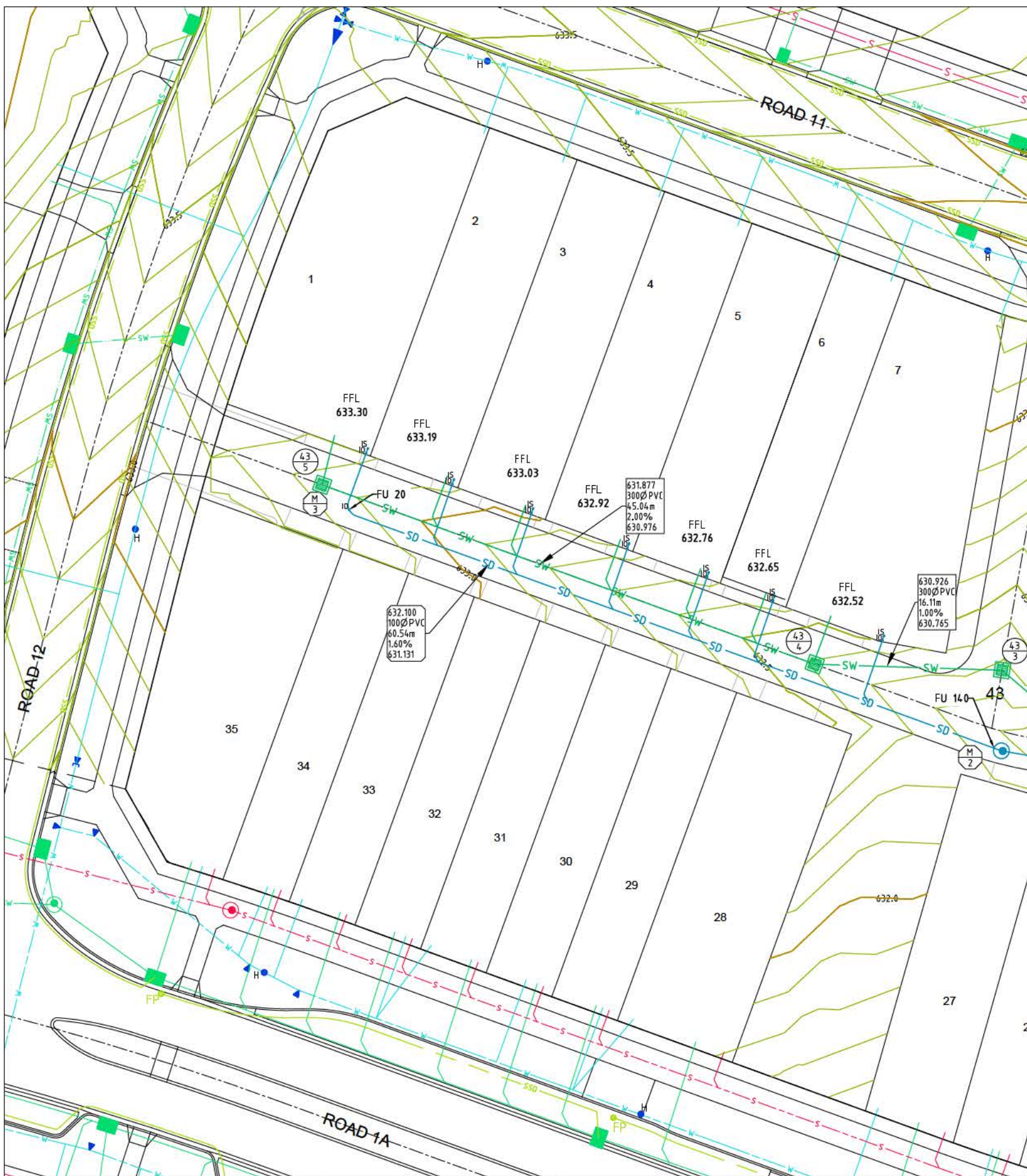

STORMWATER STRUCTURE TABLE

PIT NO	DESCRIPTION	EASTING	NORTHING	COVER RL	REMARKS
43/1	GRATED SUMP-TYPE 1	210350.409	617577.086	631.565	1600X1130
43/2	GRATED SUMP-TYPE 1	210324.605	617581.478	631.961	1600X1130
43/3	GRATED SUMP-TYPE 1	210316.743	617588.228	632.270	1600X1130
43/4	GRATED SUMP-TYPE 1	210300.643	617588.740	632.388	1600X1130
43/5	GRATED SUMP-TYPE 1	210258.316	617604.148	633.154	1300X1130

SEWER STRUCTURE TABLE

PIT NO	DESCRIPTION	EASTING	NORTHING	COVER RL	REMARKS
M/0	MANHOLE GATIC	210396.405	617571.023	632.094	
M/1	MANHOLE GATIC	210376.592	617571.107	631.880	
M/2	MANHOLE GATIC	210316.685	617581.305	632.140	
M/3		210259.792	617602.014	633.163	90° BEND

NOTES:

1. STORMWATER TIE AT GARAGE TO BE A MINIMUM OF 1000mm BELOW FFL.
2. SEWER TIE AT GARAGE TO BE A MINIMUM OF 1100mm BELOW FFL.
3. WHERE TIE IS GREATER THAN 1600mm BELOW FFL PROVIDE JUMP-UP, REFER TO DETAIL.

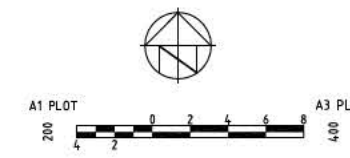

APPROVED BY: _____

No.	AMENDMENT	APPROVED	DATE	DESIGNED BY	DEVELOPMENT TEAM



APPROVED	DATE
JR	18.03.15
DESIGNED BY	DATE
AN	18.03.15
DRAWN BY	JP
CHECKED BY	JP
SCALE	AS SHOWN

PROJECT
**MONCRIEFF EAST
 ESTATE SECTION 43
 BUILDING APPROVAL**

DRAWING TITLE
**HYDRAULIC SERVICES
 GROUND FLOOR PLAN
 SHEET 1 OF 2**

PROJECT No. **4900-80** DRAWING No. **101**

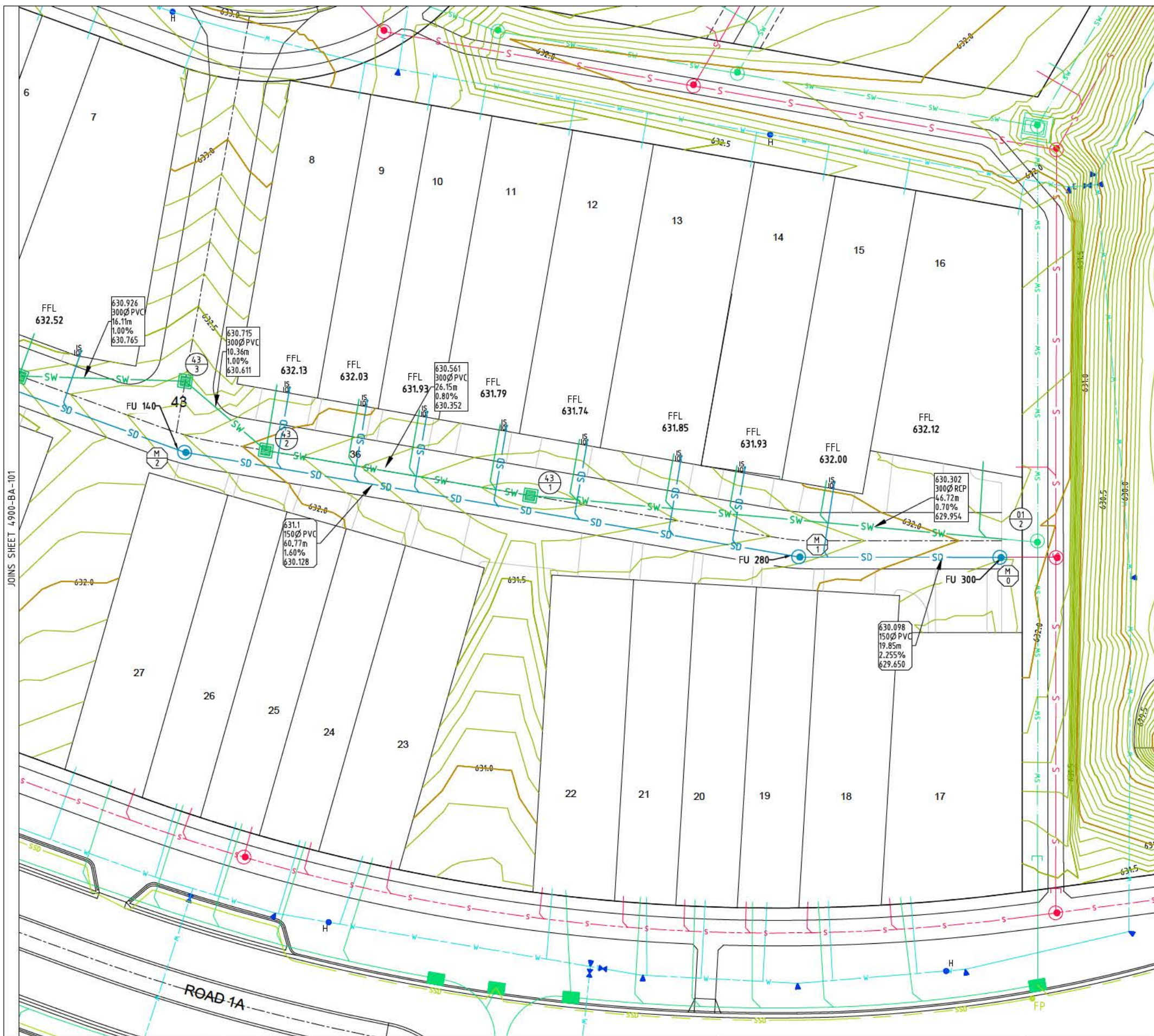

DRAINAGE PLAN NO. _____

OWNER: LDA

BLOCK: 8-16 SECTION: 43

SUBURB: MONCRIEFF

ADDRESS: _____

STORMWATER STRUCTURE TABLE

PIT NO	DESCRIPTION	EASTING	NORTHING	COVER RL	REMARKS
43/1	GRATED SUMP-TYPE 1	210350.409	617577.086	631.565	1600X1130
43/2	GRATED SUMP-TYPE 1	210324.605	617581.478	631.961	1600X1130
43/3	GRATED SUMP-TYPE 1	210316.743	617588.228	632.270	1600X1130
43/4	GRATED SUMP-TYPE 1	210300.643	617588.740	632.388	1600X1130
43/5	GRATED SUMP-TYPE 1	210258.316	617604.148	633.154	1600X1130

SEWER STRUCTURE TABLE

PIT NO	DESCRIPTION	EASTING	NORTHING	COVER RL	REMARKS
M/0	MANHOLE GATIC	210396.405	617571.023	632.094	
M/1	MANHOLE GATIC	210376.592	617571.107	631.880	
M/2	MANHOLE GATIC	210316.685	617581.305	632.140	
M/3		210259.792	617602.014	633.163	90° BEND

NOTES:

1. STORMWATER TIE AT GARAGE TO BE A MINIMUM OF 1000mm BELOW FFL.
2. SEWER TIE AT GARAGE TO BE A MINIMUM OF 1100mm BELOW FFL.
3. WHERE TIE IS GREATER THAN 1600mm BELOW FFL PROVIDE JUMP-UP, REFER TO DETAIL.

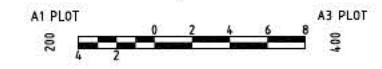

APPROVED BY: _____

No.	AMENDMENT	APPROVED	DATE	REVISION	DEVELOPMENT TEAM



APPROVED	JR	DATE	18.03.15
DESIGNED	AN	DATE	18.03.15
DRAWN BY	JP		
CHECKED BY	JP		
DATE FILE	18/03/15		
FILE NAME	181815-101		
SCALE	AS SHOWN		

PROJECT

MONCRIEFF EAST ESTATE SECTION 43 BUILDING APPROVAL

DRAWING TITLE

HYDRAULIC SERVICES GROUND FLOOR PLAN SHEET 2 OF 2

PROJECT No.	4900-80	DRAWING No.	102	ASMT
-------------	---------	-------------	-----	------

MONCRIEFF EAST ESTATE

FOR CONSTRUCTION
SECTION 66
BLOCKS 1-31

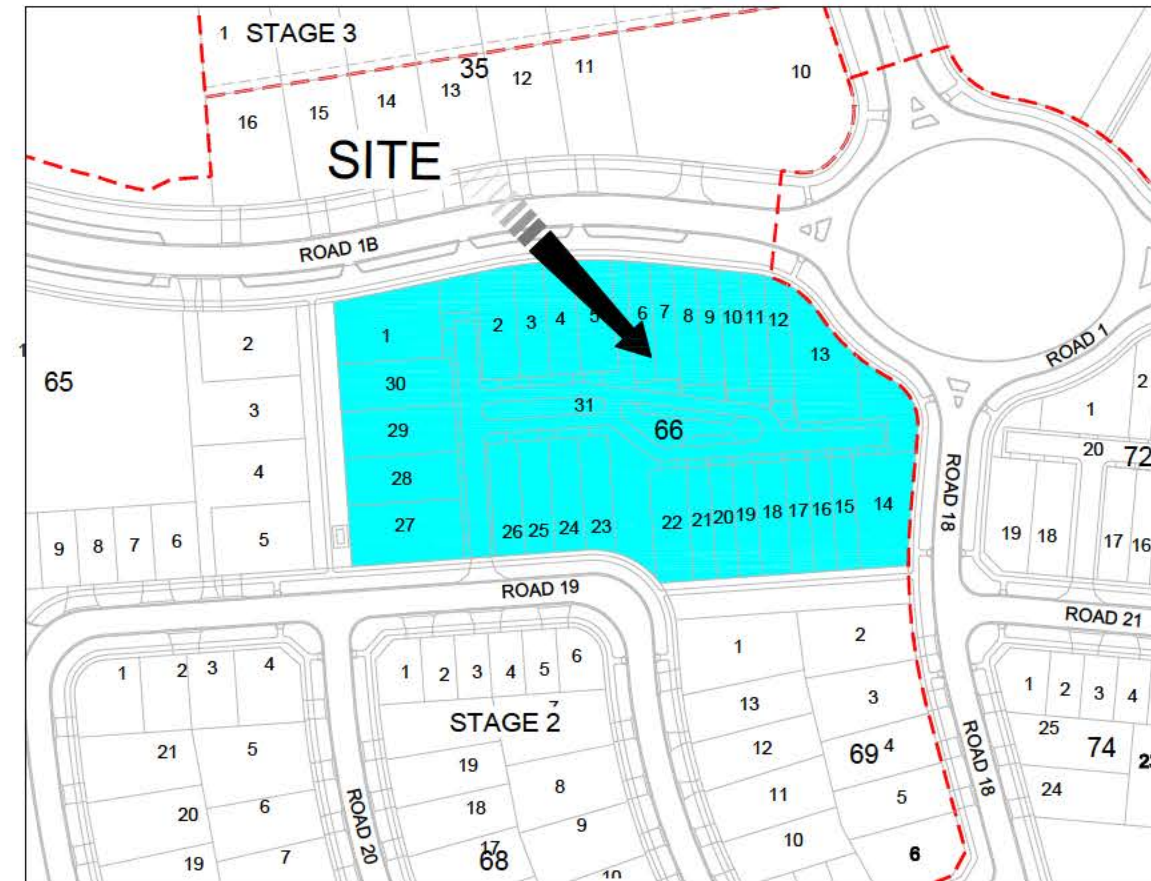

LOCALITY PLAN 



DRAINAGE PLAN NO. _____

OWNER: LDA
 BLOCK: 23-30 SECTION: 66
 SUBURB: MONCRIEFF
 ADDRESS: _____

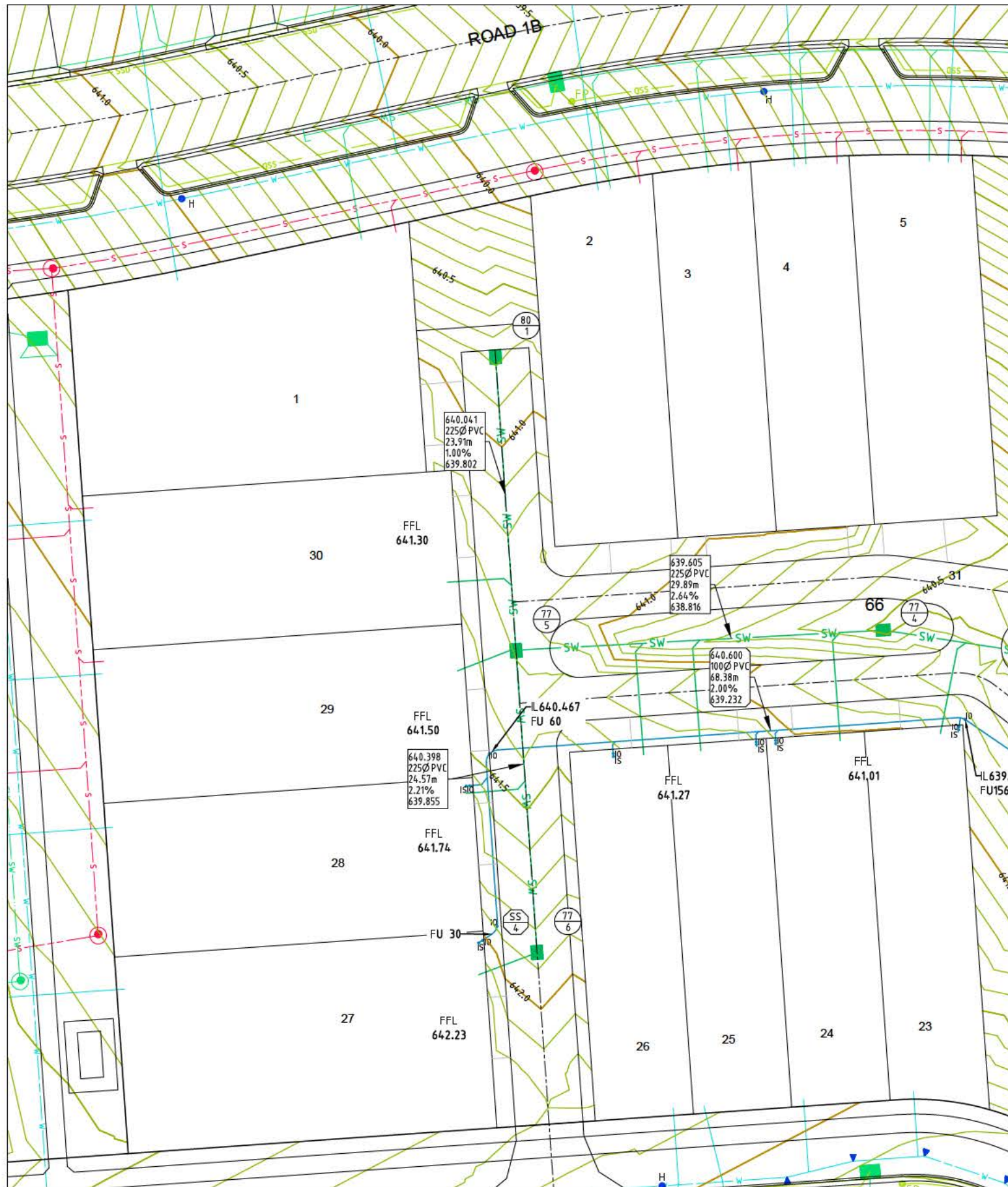

JOINS SHEET 4900-BA-102

SEWER STRUCTURE TABLE

PIT NO	DESCRIPTION	EASTING	NORTHING	COVER RL	REMARKS
SS/1	MANHOLE	210091.041	617523.080	635.608	
SS/2	END CAP/MANHOLE	210085.062	617522.676	637.500	
SS/3	MANHOLE	210020.818	617518.183	640.342	H.D COVER
SS/4		209969.720	617509.459	641.876	90° BEND

STORMWATER STRUCTURE TABLE

PIT NO	DESCRIPTION	EASTING	NORTHING	COVER RL	REMARKS
77/1	GRATED SUMP-TYPE 1	210079.451	617525.857	637.527	1600X1130
77/2	GRATED SUMP-TYPE 1	210058.453	617524.389	638.516	1600X1130
77/3	GRATED SUMP-TYPE 1	210042.687	617527.340	638.950	1600X1130
77/4	GRATED SUMP-TYPE 1	210001.243	617533.761	640.477	1600X1130
77/5	GRATED SUMP-TYPE 1	209971.394	617532.137	641.292	1600X1130
77/6	GRATED SUMP-TYPE 1	209973.108	617507.628	641.857	1600X1130
80/1	GRATED SUMP-TYPE 1	209969.726	617555.988	640.775	1600X1130

NOTES:

1. STORMWATER TIE AT GARAGE TO BE A MINIMUM OF 1000mm BELOW FFL.
2. SEWER TIE AT GARAGE TO BE A MINIMUM OF 1100mm BELOW FFL.
3. WHERE TIE IS GREATER THAN 1600mm BELOW FFL PROVIDE JUMP-UP, REFER TO DETAIL.



APPROVED BY: _____

No.	AMENDMENT	APPROVED	DATE	DESIGNED BY	DEVELOPMENT TEAM



APPROVED	JR	DATE	18.03.15
DESIGNED BY	AN	DATE	18.03.15
DRAWN BY	JP		
CHECKED BY	JP		
DATE FILE	18/03/2015		
SCALE	AS SHOWN		

PROJECT
**MONCRIEFF EAST
 ESTATE SECTION 66
 BUILDING APPROVAL**

DRAWING TITLE
**HYDRAULIC SERVICES
 GROUND FLOOR PLAN
 SHEET 1 OF 2**

PROJECT No.	4900-81	DRAWING No.	101	ASBY
-------------	---------	-------------	-----	------

MONCRIEFF EAST ESTATE

FOR CONSTRUCTION
SECTION 72
BLOCKS 1-20

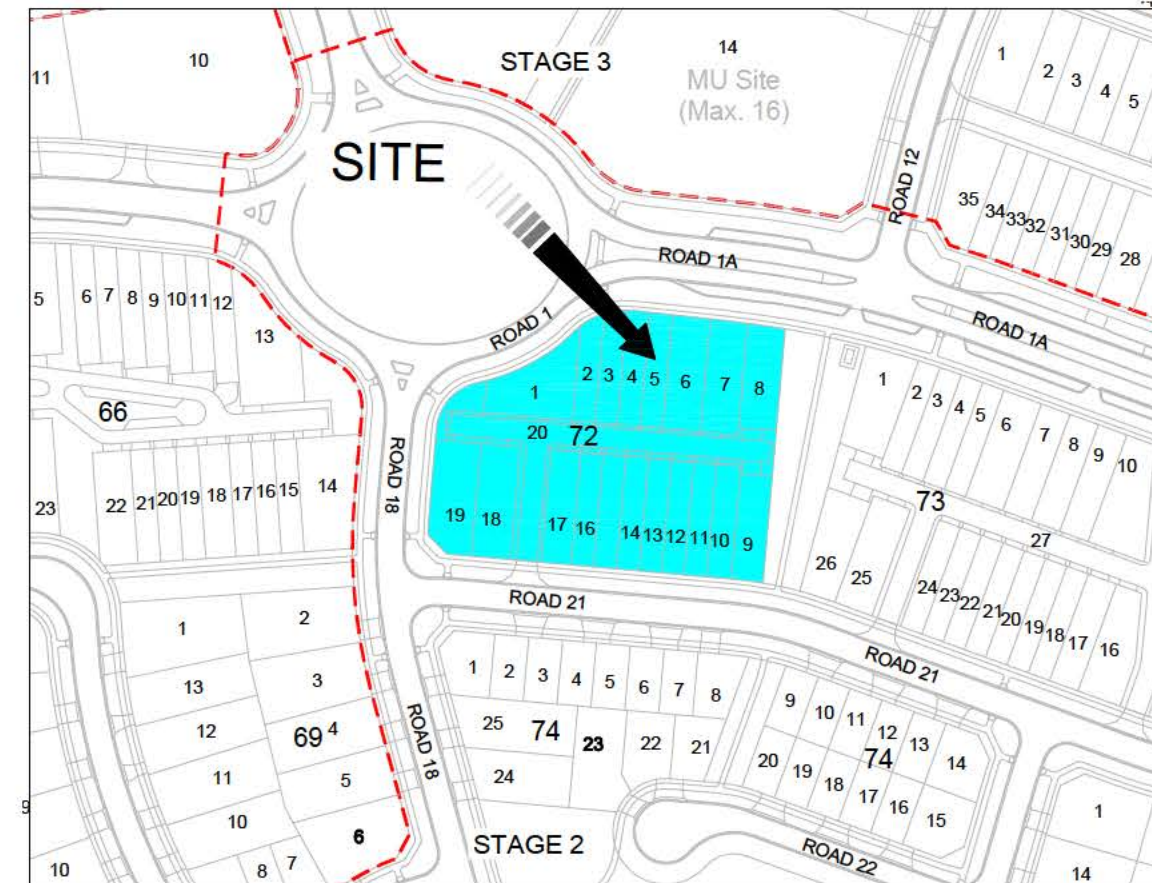

LOCALITY PLAN 



DRAINAGE PLAN NO. _____

OWNER: LDA
 BLOCK: 1-19 SECTION: 72
 SUBURB: MONCRIEFF
 ADDRESS: _____



STORMWATER STRUCTURE TABLE

PIT NO	DESCRIPTION	EASTING	NORTHING	COVER RL	REMARKS
74/1	MANHOLE	210202.391	617547.423	633.434	
74/2	MANHOLE GATIC	210199.995	617518.070	633.639	
74/3	'R' SUMP	210198.347	617516.896	633.648	1600X1130
74/4	GRADED SUMP-TYPE 1	210165.994	617519.713	633.977	900X1130
74/5	GRADED SUMP-TYPE 1	210139.847	617522.000	634.249	900X1130
74/6	GRADED SUMP-TYPE 1	210120.176	617523.721	635.028	900X1130
79/1	GRADED SUMP-TYPE 1	210135.627	617516.096	634.404	900X1130

NOTES:

1. STORMWATER TIE AT GARAGE TO BE A MINIMUM OF 1000mm BELOW FFL.
2. WHERE TIE IS GREATER THAN 1600mm BELOW FFL PROVIDE JUMP-UP, REFER TO DETAIL.

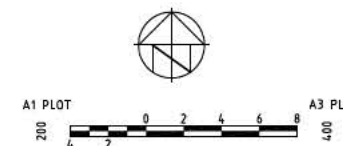

APPROVED BY: _____

No.	AMENDMENT	APPROVED	DATE	REVISION

ARCHITECTS
RING & ASSOCIATES
 ARCHITECTS INTERIOR DESIGN

CLIENT

ACT
 Land Development Agency
 CANBERRA TERRITORY

INDESCO

CONSULT AUSTRALIA
 Business Engineering Design

AS/NZS ISO 9001
 Certified
 Davis Langdon Certification Services

APPROVED	JR	DATE	18.03.15
DESIGNED	AN	DATE	18.03.15
DRAWN BY	JP		
CHECKED BY	JP		
FILE NAME	H:\A988 Moncrieff East Estate\Building Approval - Community Title Blocks\Aspd\Current Drawings\Section 72\72-101-15.dwg		
SCALE	AS SHOWN	DRAWN No.	

PROJECT

**MONCRIEFF EAST
 ESTATE SECTION 72
 BUILDING APPROVAL**

DRAWING TITLE

**HYDRAULIC SERVICES
 GROUND FLOOR PLAN
 SHEET 1 OF 1**

PROJECT No. **4900-82**

DRAWING No. **101**

AMBY

MONCRIEFF EAST ESTATE

FOR CONSTRUCTION
SECTION 73
BLOCKS 1-27

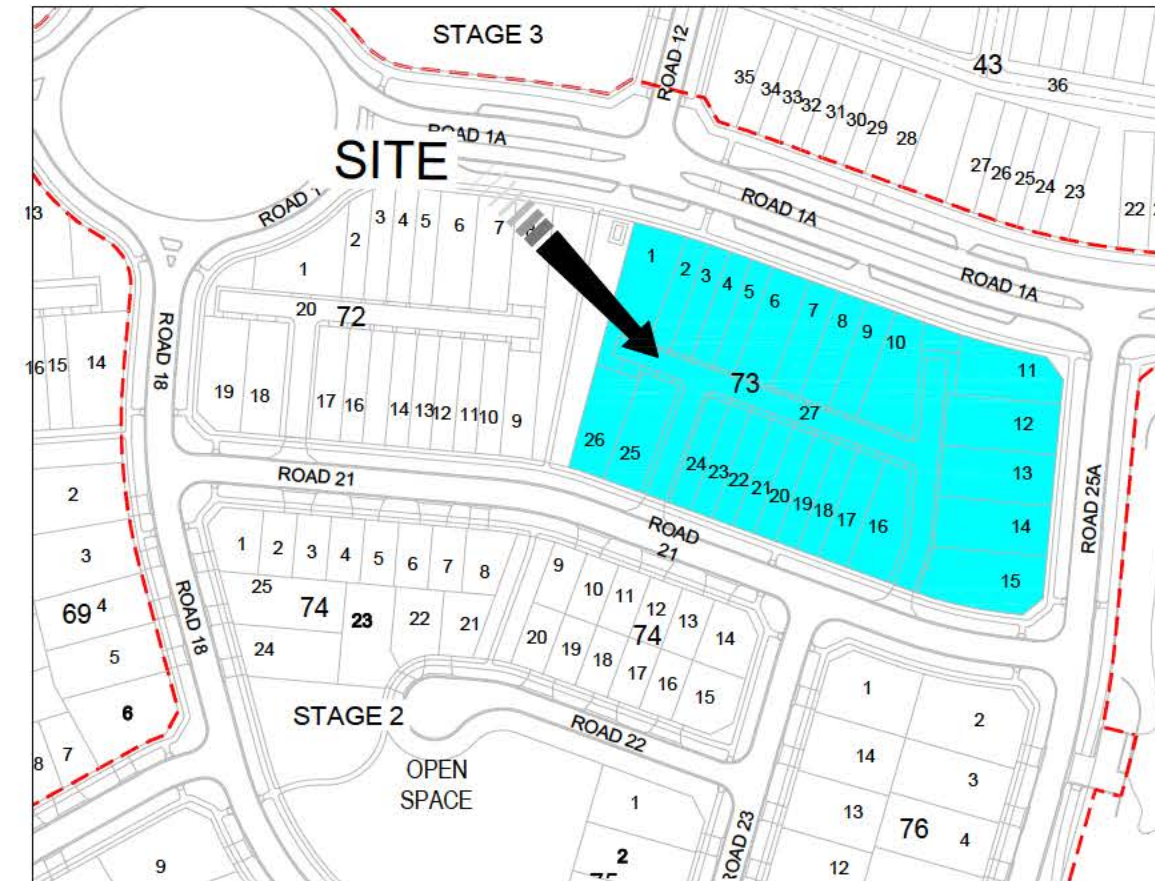

LOCALITY PLAN 



DRAINAGE PLAN NO. _____

OWNER: LDA
 BLOCK: 16-26 SECTION: 73
 SUBURB: MONCRIEFF
 ADDRESS: _____

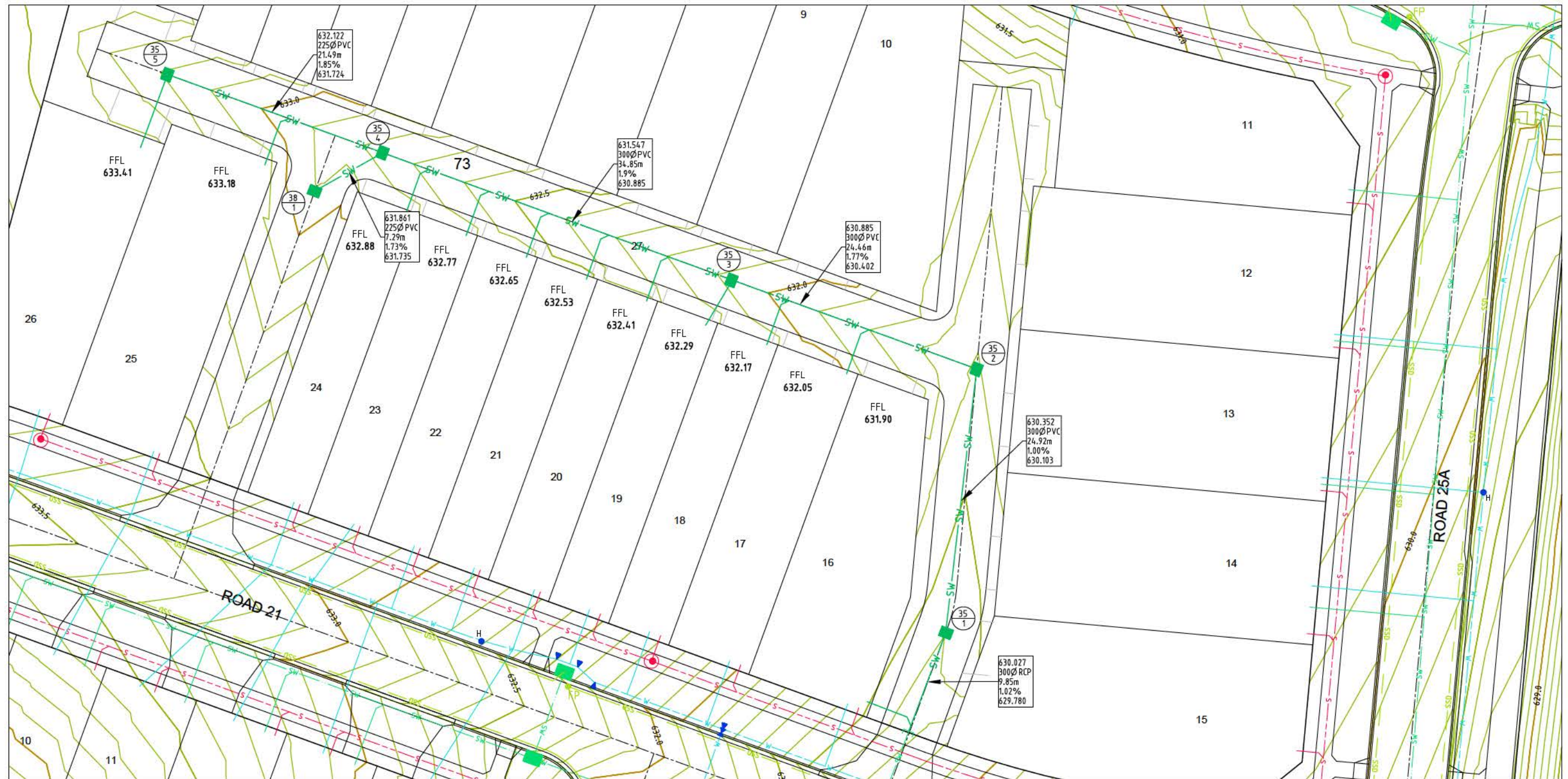

NOTES:

1. STORMWATER TIE AT GARAGE TO BE A MINIMUM OF 1000mm BELOW FFL.
2. WHERE TIE IS GREATER THAN 1600mm BELOW THE FFL PROVIDE JUMP-UP, REFER TO DETAIL.

STORMWATER STRUCTURE TABLE

PIT NO	DESCRIPTION	EASTING	NORTHING	COVER RL	REMARKS
35/1	GRATED SUMP-TYPE 1	210297.451	617457.766	631.402	1600X1130
35/2	GRATED SUMP-TYPE 1	210300.359	617482.514	631.589	1600X1130
35/3	GRATED SUMP-TYPE 1	210277.377	617490.879	632.072	1600X1130
35/4	GRATED SUMP-TYPE 1	210244.640	617502.794	632.761	1600X1130
35/5	GRATED SUMP-TYPE 1	210224.426	617510.151	633.186	1600X1130
38/1	GRATED SUMP-TYPE 1	210238.285	617499.226	632.909	1600X1130

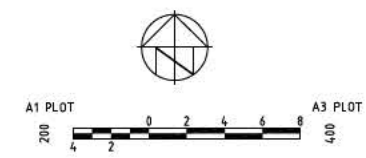

APPROVED BY: _____

No.	AMENDMENT	APPROVED	DATE	DESIGNED BY	DEVELOPMENT TEAM



APPROVED	JR	DATE	18.03.15
DESIGNED	AN	DATE	18.03.15
DRAWN BY	JP		
CHECKED BY	JP		
DATE FILE	18/03/15		
SCALE	AS SHOWN		

MONCRIEFF EAST ESTATE SECTION 73 BUILDING APPROVAL

HYDRAULIC SERVICES GROUND FLOOR PLAN SHEET 1 OF 1

PROJECT No. 4900-83 DRAWING No. 101

MONCRIEFF EAST ESTATE

BUILDING APPROVAL SECTION 43 BLOCKS 1-36

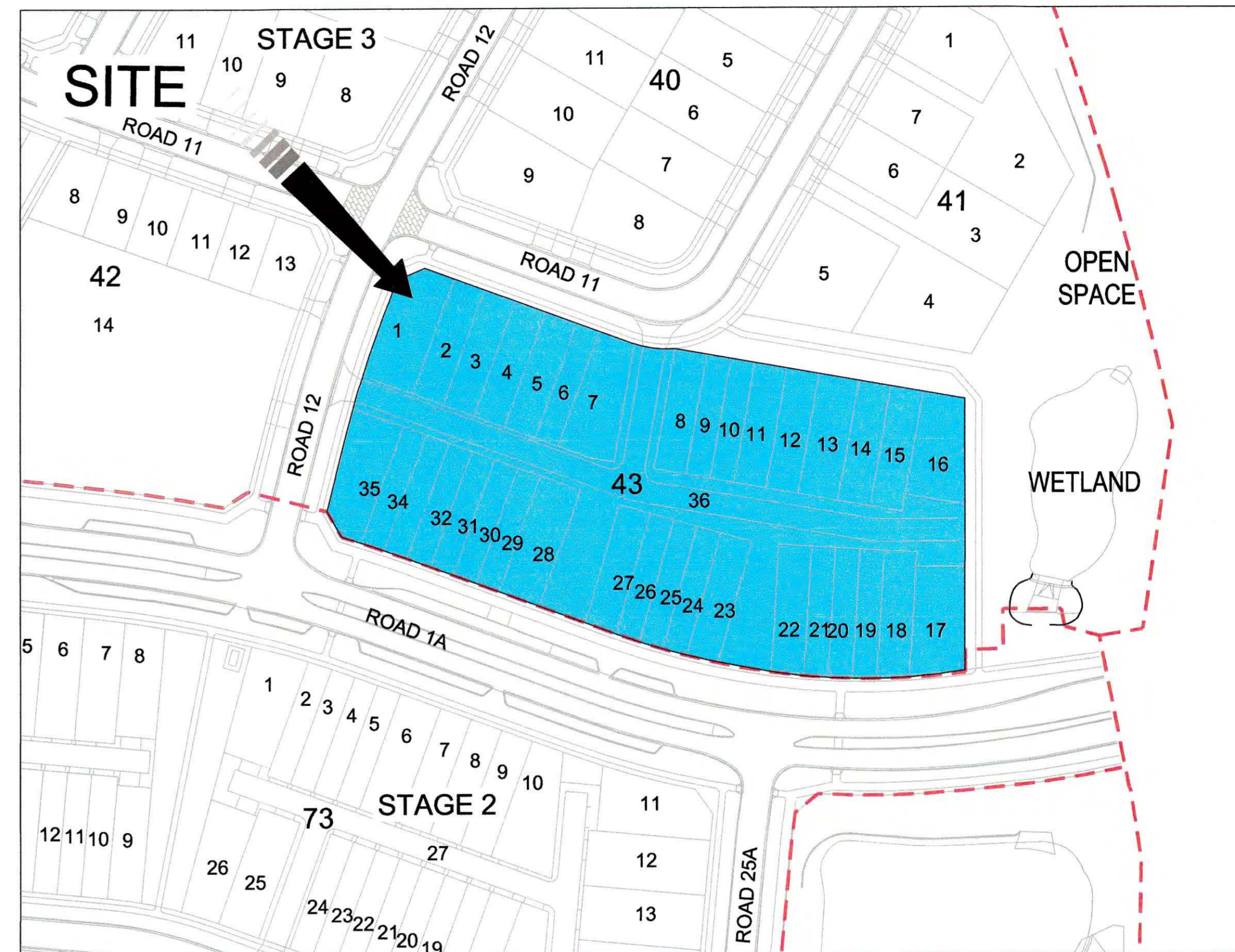

LOCALITY PLAN 



DRAINAGE PLAN NO. _____

OWNER: LDA
 BLOCK: 1-7 SECTION: 43
 SUBURB: MONCRIEFF
 ADDRESS: _____

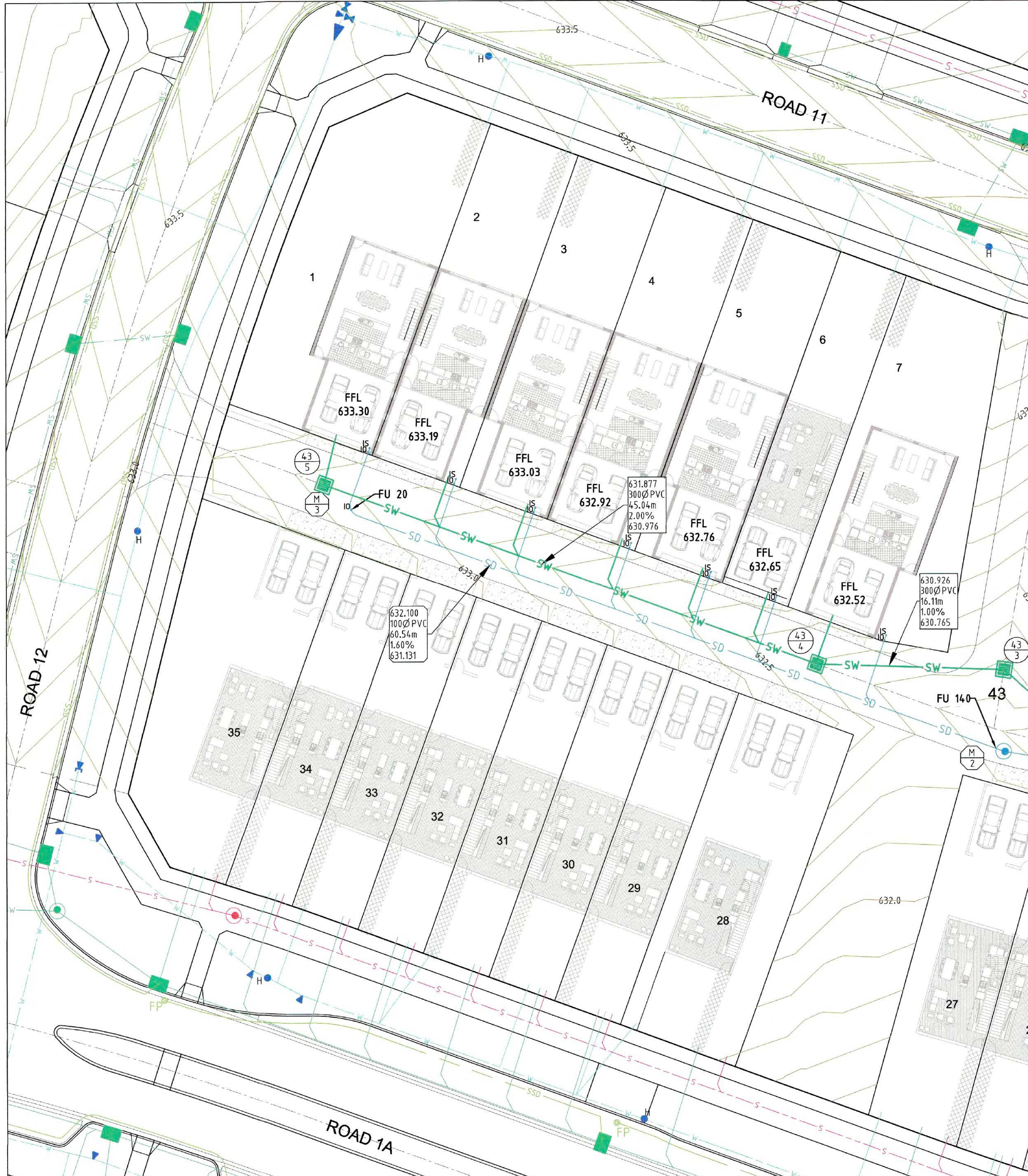

STORMWATER STRUCTURE TABLE

PIT NO	DESCRIPTION	EASTING	NORTHING	COVER RL	REMARKS
43/1	GRATED SUMP-TYPE 1	210350.409	617577.086	631.565	1600X1130
43/2	GRATED SUMP-TYPE 1	210324.605	617581.478	631.961	1600X1130
43/3	GRATED SUMP-TYPE 1	210316.743	617588.228	632.270	1600X1130
43/4	GRATED SUMP-TYPE 1	210300.643	617588.740	632.388	1600X1130
43/5	GRATED SUMP-TYPE 1	210258.316	617604.148	633.154	1300X1130

SEWER STRUCTURE TABLE

PIT NO	DESCRIPTION	EASTING	NORTHING	COVER RL	REMARKS
M/0	MANHOLE GATIC	210396.405	617571.023	632.094	
M/1	MANHOLE GATIC	210376.592	617571.107	631.880	
M/2	MANHOLE GATIC	210316.685	617581.305	632.140	
M/3		210259.792	617602.014	633.163	90° BEND

NOTES:

1. STORMWATER TIE AT GARAGE TO BE A MINIMUM OF 1000mm BELOW FFL.
2. SEWER TIE AT GARAGE TO BE A MINIMUM OF 1100mm BELOW FFL.
3. WHERE TIE IS GREATER THAN 1600mm BELOW FFL PROVIDE JUMP-UP, REFER TO DETAIL.

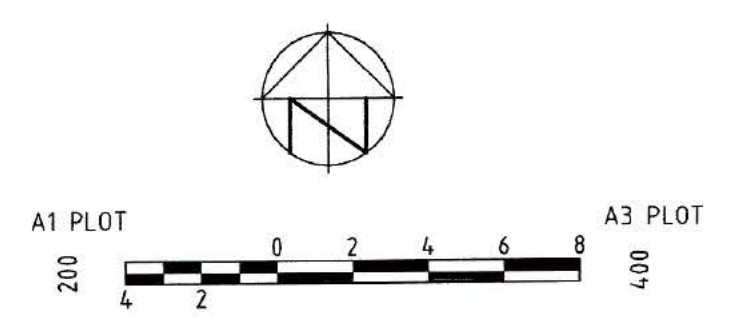

APPROVED BY: _____
 198814767 25-5-15

<table border="1"> <thead> <tr> <th>No.</th> <th>AMENDMENT</th> <th>APPROVED</th> <th>DATE</th> <th>DESIGNED BY</th> <th>DEVELOPMENT TEAM</th> </tr> </thead> <tbody> <tr> <td> </td> <td> </td> <td> </td> <td> </td> <td> </td> <td> </td> </tr> </tbody> </table>	No.	AMENDMENT	APPROVED	DATE	DESIGNED BY	DEVELOPMENT TEAM												APPROVED: JR DATE: 13.03.15 CHECKED: AN DATE: 13.03.15 DESIGNED BY: JP DRAWN BY: JP CAD FILE: H:\4908 Moncrieff East Estate\Building Approval - Community Title Blocks\Acad\Current Drawings\Section SCALE: AS SHOWN SHEET No.	PROJECT: MONCRIEFF EAST ESTATE SECTION 43 BUILDING APPROVAL DRAWING TITLE: HYDRAULIC SERVICES GROUND FLOOR PLAN SHEET 1 OF 2 PROJECT No. 4900-80 DRAWING No. 101 AMDT
	No.	AMENDMENT	APPROVED	DATE	DESIGNED BY	DEVELOPMENT TEAM													
FOR BUILDING APPROVAL	AN	13.03.15	JP																

MONCRIEFF EAST ESTATE

BUILDING APPROVAL SECTION 66 BLOCKS 1-31

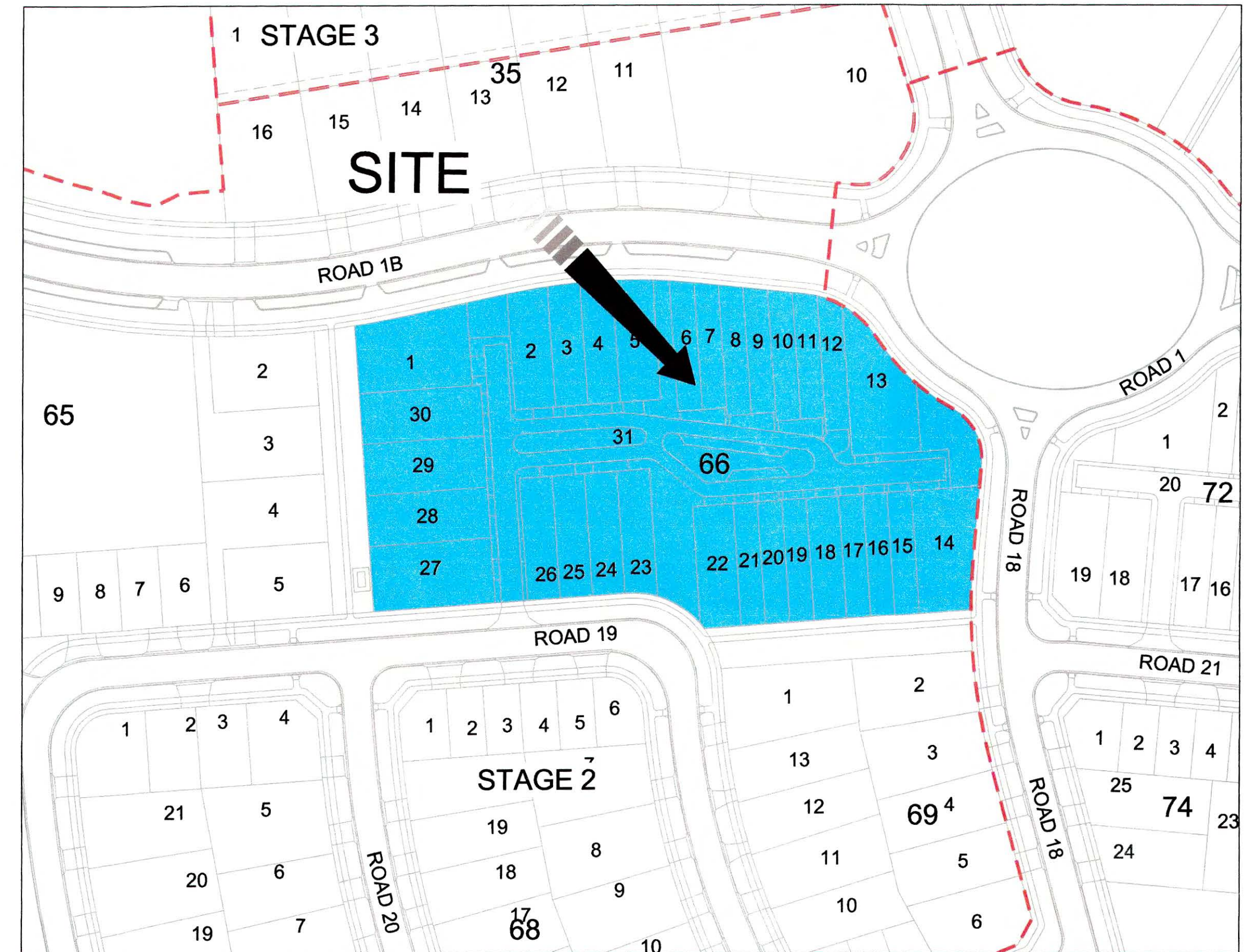

LOCALITY PLAN 



DRAINAGE PLAN NO. _____

OWNER: LDA
 BLOCK: 23-30 SECTION: 66
 SUBURB: MONCRIEFF
 ADDRESS: _____

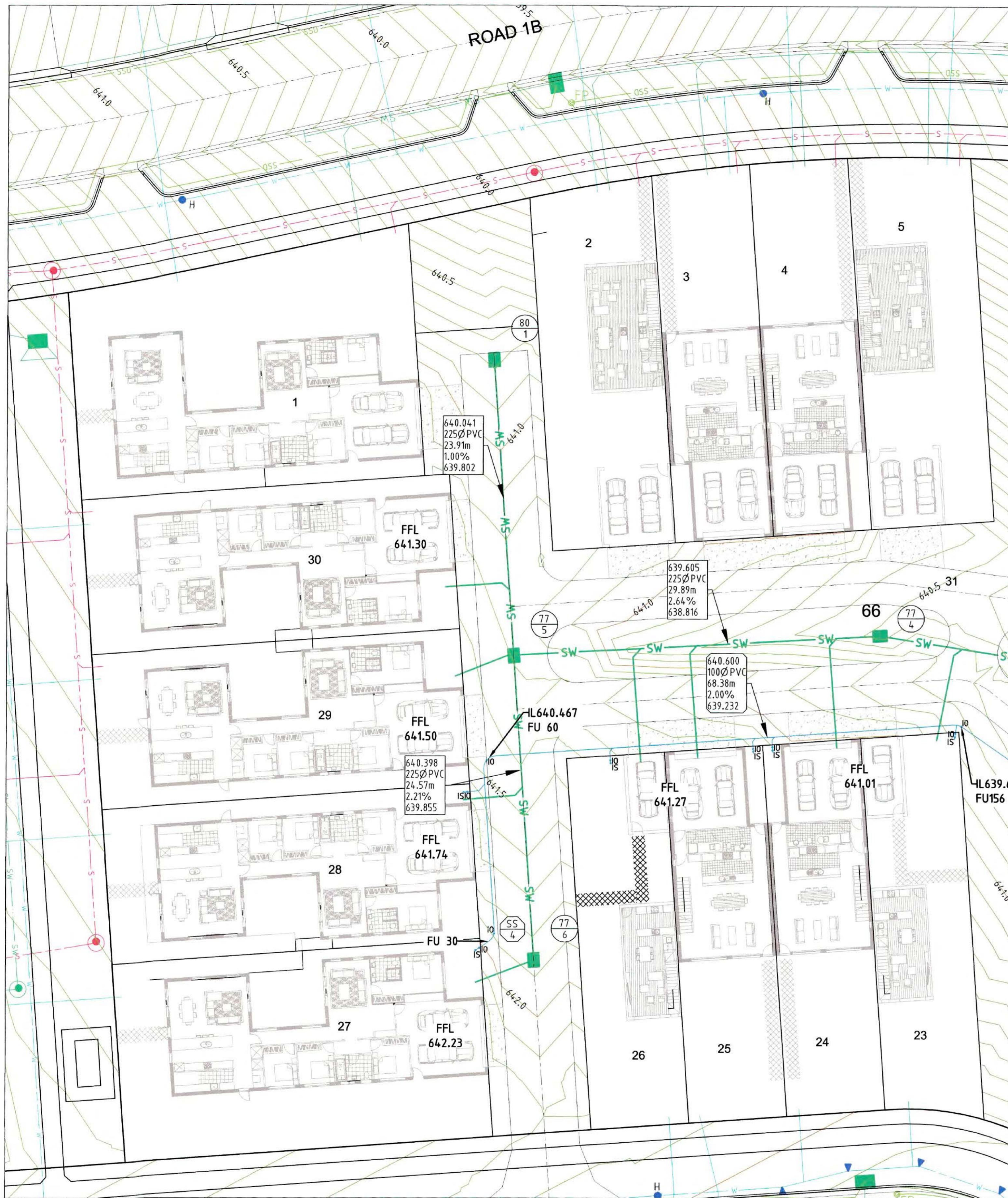

JOINS SHEET 4900-BA-102

SEWER STRUCTURE TABLE

PIT NO	DESCRIPTION	EASTING	NORTHING	COVER RL	REMARKS
SS/1	MANHOLE	210091.041	617523.080	635.608	
SS/2	END CAP/MANHOLE	210085.062	617522.676	637.500	
SS/3	MANHOLE	210020.818	617518.183	640.342	H.D COVER
SS/4		209969.720	617509.459	641.876	90° BEND

STORMWATER STRUCTURE TABLE

PIT NO	DESCRIPTION	EASTING	NORTHING	COVER RL	REMARKS
77/1	GRADED SUMP-TYPE 1	210079.451	617525.857	637.527	1600X1130
77/2	GRADED SUMP-TYPE 1	210058.453	617524.389	638.516	1600X1130
77/3	GRADED SUMP-TYPE 1	210042.687	617527.340	638.950	1600X1130
77/4	GRADED SUMP-TYPE 1	210001.243	617533.761	640.477	1600X1130
77/5	GRADED SUMP-TYPE 1	209971.394	617532.137	641.292	1600X1130
77/6	GRADED SUMP-TYPE 1	209973.108	617507.628	641.857	1600X1130
80/1	GRADED SUMP-TYPE 1	209969.726	617555.988	640.775	1600X1130

NOTES:

1. STORMWATER TIE AT GARAGE TO BE A MINIMUM OF 1000mm BELOW FFL.
2. SEWER TIE AT GARAGE TO BE A MINIMUM OF 1100mm BELOW FFL.
3. WHERE TIE IS GREATER THAN 1600mm BELOW FFL PROVIDE JUMP-UP, REFER TO DETAIL.



APPROVED BY:

1988/4767 11-4-15

No.	AMENDMENT	APPROVED	DATE	ISSUED BY	DEVELOPMENT TEAM
A	FOR BUILDING APPROVAL	AN	13.03.15	JP	



APPROVED	JR	DATE	13.03.15
CHECKED	AN	DATE	13.03.15
DESIGNED BY	JP		
DRAWN BY	JP		
CAD FILE	W:\4900 Moncrieff East Estate\Building Approval - Community Title Blocks\Acad\Current Drawings\Section 66\4900-BA-102.dwg		
SCALE	AS SHOWN	SHEET No.	

MONCRIEFF EAST ESTATE SECTION 66 BUILDING APPROVAL

DRAWING TITLE		
HYDRAULIC SERVICES GROUND FLOOR PLAN SHEET 1 OF 2		
PROJECT No.	DRAWING No.	AMDT
4900-81	101	

DRAINAGE PLAN NO. _____

OWNER: LDA

BLOCK: 18-22 SECTION: 66

SUBURB: MONCRIEFF

ADDRESS: _____

JOINS SHEET 4900-BA-101

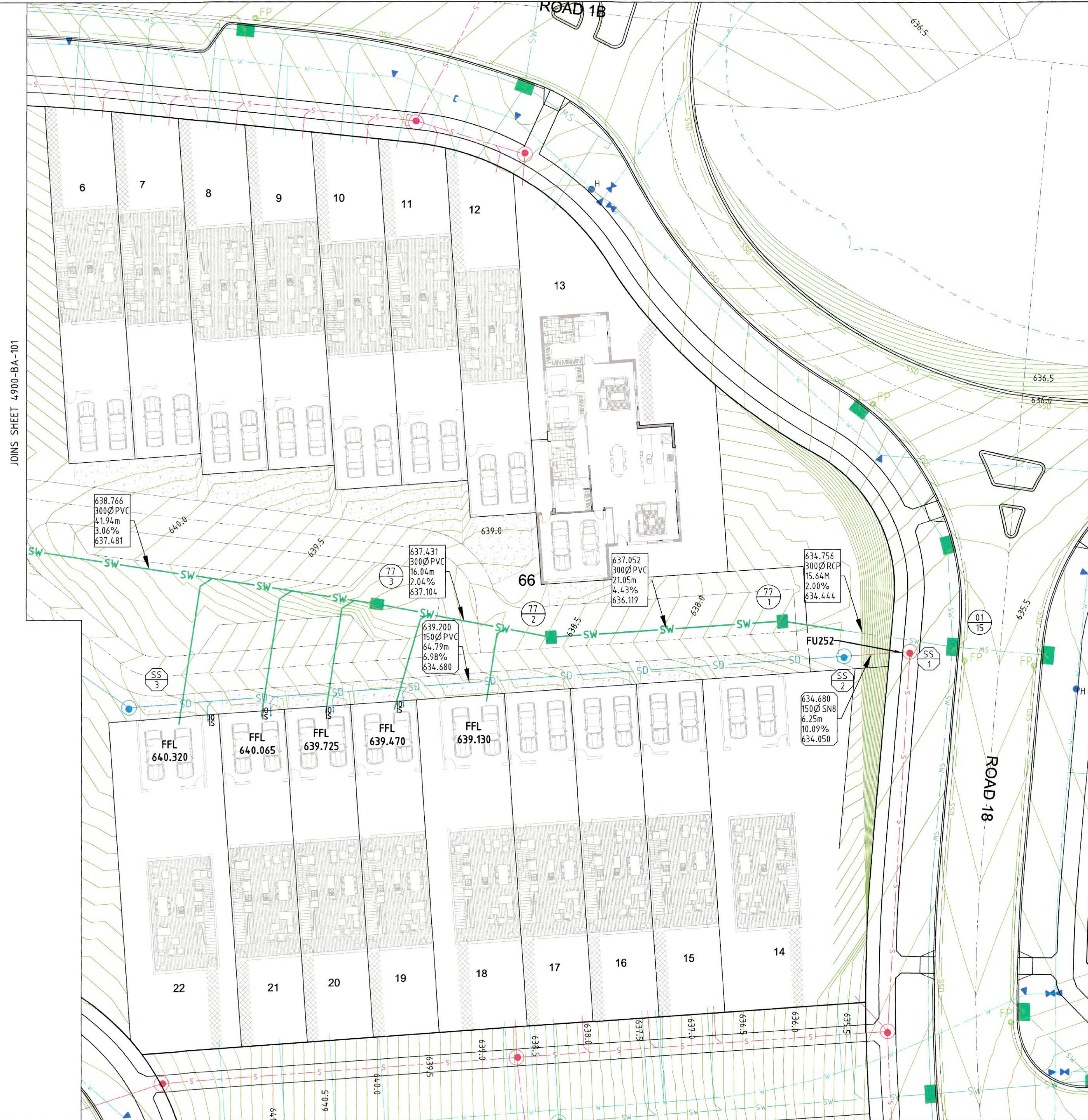

SEWER STRUCTURE TABLE

PIT NO	DESCRIPTION	EASTING	NORTHING	COVER RL	REMARKS
SS/1	MANHOLE	210091.041	617523.080	635.608	
SS/2	END CAP/MANHOLE	210085.062	617522.676	637.500	
SS/3	MANHOLE	210020.818	617518.183	640.342	H.D COVER
SS/4		209969.720	617509.459	641.876	90° BEND

STORMWATER STRUCTURE TABLE

PIT NO	DESCRIPTION	EASTING	NORTHING	COVER RL	REMARKS
77/1	GRATED SUMP-TYPE 1	210079.451	617525.857	637.527	1600X1130
77/2	GRATED SUMP-TYPE 1	210058.453	617524.389	638.516	1600X1130
77/3	GRATED SUMP-TYPE 1	210042.687	617527.340	638.950	1600X1130
77/4	GRATED SUMP-TYPE 1	210001.243	617533.761	640.477	1600X1130
77/5	GRATED SUMP-TYPE 1	209971.394	617532.137	641.292	1600X1130
77/6	GRATED SUMP-TYPE 1	209973.108	617507.628	641.857	1600X1130
80/1	GRATED SUMP-TYPE 1	209969.726	617555.988	640.775	1600X1130

NOTES:

1. STORMWATER TIE AT GARAGE TO BE A MINIMUM OF 1000mm BELOW FFL.
2. SEWER TIE AT GARAGE TO BE A MINIMUM OF 1100mm BELOW FFL.
3. WHERE TIE IS GREATER THAN 1600mm BELOW FFL PROVIDE JUMP-UP, REFER TO DETAIL.

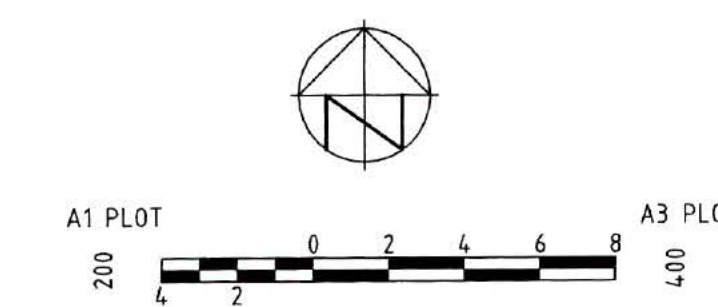

APPROVED BY: _____
190814767 11-4-15

No. AMENDMENT APPROVED DATE AMDBY DEVELOPMENT TEAM _____ _____ _____ _____ _____ _____ A FOR BUILDING APPROVAL AN 13.03.15 JP	 ARCHITECTS RING & ASSOCIATES ARCHITECTS INTERIOR DESIGN	 ACT ACT Economic Development Land Development Agency LAND DEVELOPMENT AGENCY	 INDESCO CONSULT AUSTRALIA Business Engineering Design ANZS ISO 9001 Certified Davis Langdon Certification Services	APPROVED JR DATE 13.03.15 CHECKED AN DATE 13.03.15 DESIGNED BY JP DRAWN BY JP	PROJECT MONCRIEFF EAST ESTATE SECTION 66 BUILDING APPROVAL	DRAWING TITLE HYDRAULIC SERVICES GROUND FLOOR PLAN SHEET 2 OF 2
				CAD FILE H:\4900 Moncrieff East Estate\Building Approval - Community Title Blocks\Acad\Current Drawings\Section 66\4900-BA-101.dwg SCALE AS SHOWN SHEET No.	PROJECT No. 4900-81	DRAWING No. 102