



ACT Heritage Council

## Entry to the ACT Heritage Register

*Heritage Act 2004*

### **20054. Tennent Homestead**

Block 1 (part)

**District of TENNENT**

This document has been prepared by the ACT Heritage Council.

This entry which was previously part of the old heritage places or the old heritage objects registers (as defined in the *Heritage Act 2004*), as the case may be, is taken to be registered under the *Heritage Act 2004*.

Conservation Requirements (including Specific Requirements), as defined under the *Heritage Act 2004*, that are contained within this document are taken to be Heritage Guidelines applying to this place or object, as the case may be.

Information restricted under *the old heritage places register or old heritage objects register* is restricted under the *Heritage Act 2004*.

**Contact:** ACT Heritage Council c/o Secretary PO Box 144  
**Enquiries:** phone 02 6207 2164 fax 02 6207 5715

Lynham ACT 2602  
e-mail [heritage@act.gov.au](mailto:heritage@act.gov.au)



ACT Government



environment ACT

Helpline: 02 6207 9777  
Website : [www.cmd.act.gov.au](http://www.cmd.act.gov.au)  
E-mail: [EnvironmentACT@act.gov.au](mailto:EnvironmentACT@act.gov.au)

## 54. Tennent Homestead, Namadgi National Park [V117]<sup>1</sup>

### Location

District of Tennent, Block 1 (part) as identified in Figure 54 and indicated on the Territory Plan Map by the Heritage Places Register Overlay H54.

### Features Intrinsic To The Heritage Significance Of The Place

The place comprises:

- a) the Homestead Group;
- b) the Woolshed Group and steel sheep dip;
- c) several Kurrajongs (*Brachychiton populneus*); and
- d) the cultural landscape, including cleared paddocks, tracks and fences, as shown in Figure 54a.

### Statement Of Significance

Tennent Homestead is significant as evidence of a marginal pastoral property that has been adapted over almost a century of use by different owners. The complex is associated with several major historical influences on land use in what is now the ACT, including the process of selection and acquisition of land by the Commonwealth for National Capital purposes.

It provides a valuable teaching and educational resource to demonstrate the ability of marginal pastoralists to adapt to their environmental surroundings as well as demonstrating the effect of this settlement on that environment through the resulting cultural landscape.

### Specific Requirements

In accordance with s.54(1) of the *Land (Planning and Environment) Act 1991*, the following requirements are identified as essential to the conservation of the heritage significance of this place. These requirements reflect the conservation policy for the place:

The place will be appropriately maintained and documented as a ruin.

It should also be noted that the place is included in Public Land and subject to a Plan of Management.

- i) **Building including alterations and additions**
  - a) The built elements of the place shall be maintained and appropriately conserved so far as is reasonably possible within available resources, recognising that natural processes of weathering and decay are at work and gradual deterioration is expected.
- ii) **Landscape**
  - a) The cultural landscape elements of the place shall be maintained and appropriately conserved so far as is reasonably possible within available resources, recognising that natural processes are at work and gradual change is expected.
  - b) The Kurrajongs (*Brachychiton populneus*), are to be conserved and appropriately maintained.

---

<sup>1</sup> [V117: Added to Heritage Places Register Numbers 53 to 59 15/09/1999 (Variation Number 117)]

**Figure 54: Tennent Homestead: Location**

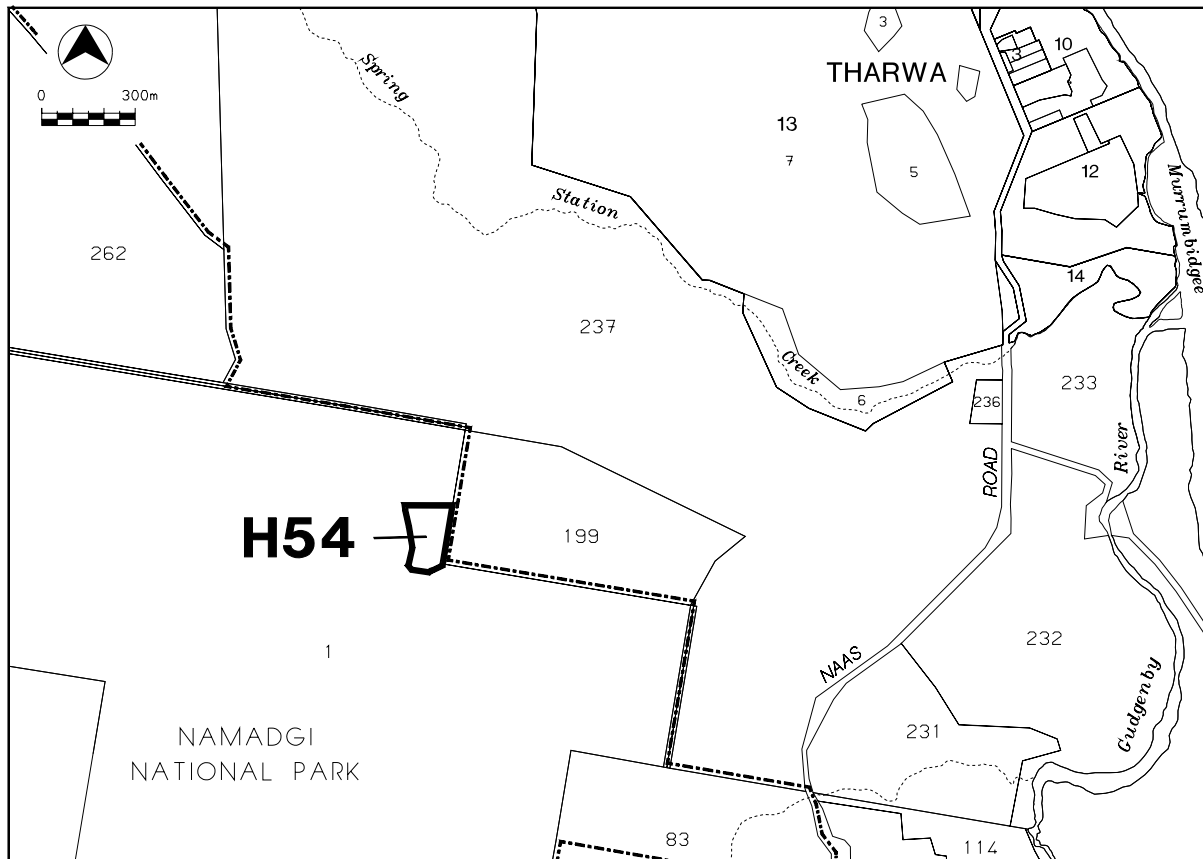

**Figure 54a: Tennent Homestead: Significant Features**

